

\$PENTBL\$

\$PLTDV\$

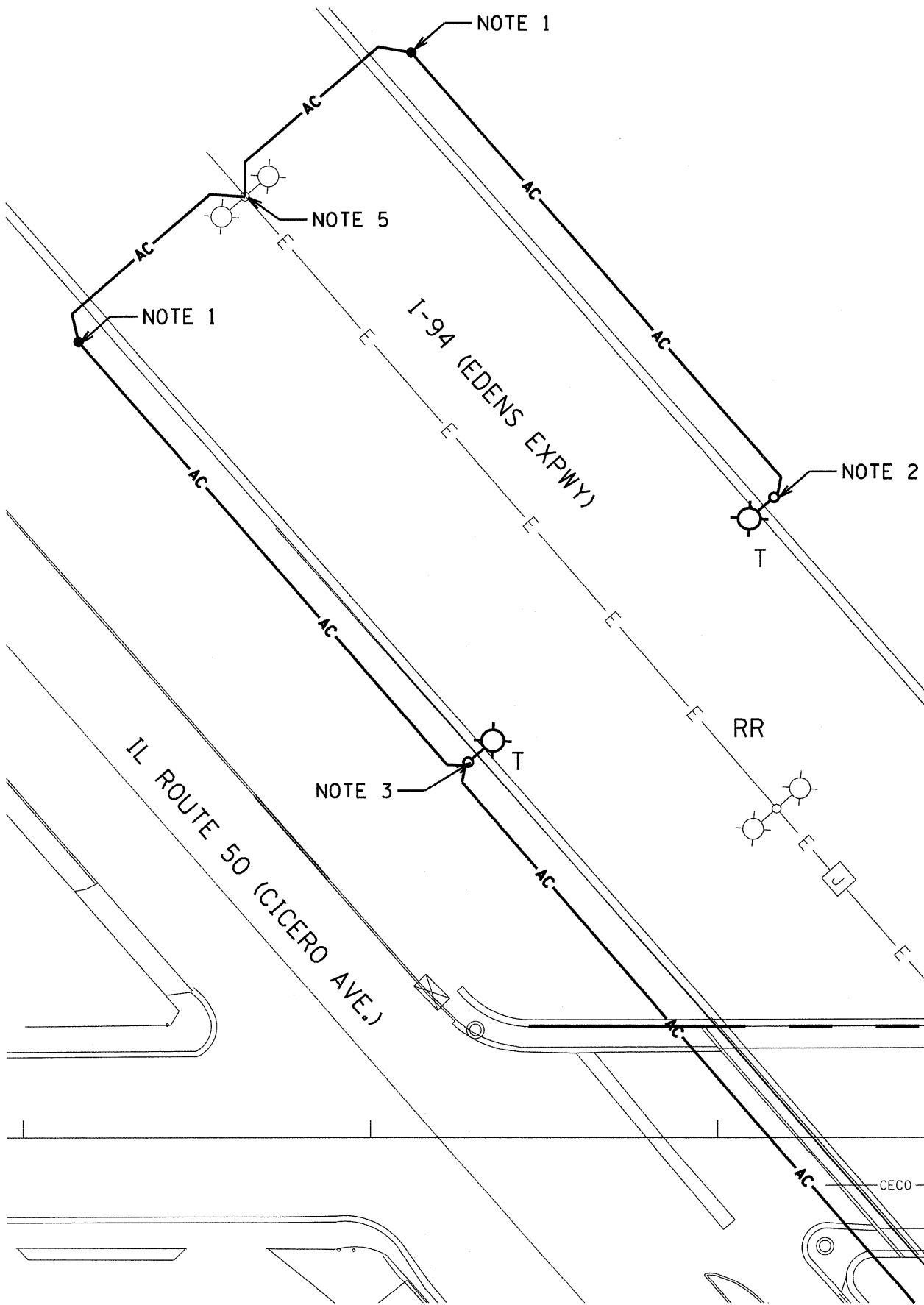

NOTES

1. TEMPORARY 60' CLASS 3 WOOD POLE. ATTACH AERIAL CABLE AT A HEIGHT TO PROVIDE REQUIRED CLEARANCE TO GROUND PER CITY OF CHICAGO ELECTRICAL CODE.
2. TEMPORARY 60' CLASS 3 WOOD POLE WITH 15' MAST ARM AND 400 WATT HPS LUMINAIRE. LUMINAIRE MOUNTING HEIGHT SHALL BE 50'. ATTACH AERIAL CABLE AT A HEIGHT TO PROVIDE REQUIRED CLEARANCE TO GROUND PER CITY OF CHICAGO ELECTRICAL CODE
3. TEMPORARY 90' CLASS 3 WOOD POLE WITH 15' MAST ARM AND 400 WATT HPS LUMINAIRE. LUMINAIRE MOUNTING HEIGHT SHALL BE 50'. ATTACH AERIAL CABLE AT A HEIGHT TO PROVIDE MAXIMUM CLEARANCE TO OVER ELSTON AVENUE WHILE PROVIDING CLEARANCE TO GROUND PER NATIONAL ELECTRICAL CODE SECTION 225.18.
4. ALL AERIAL CABLES FOR TEMPORARY LIGHTING SHALL BE 3-1/C #2 WITH MESSENGER WIRE.
5. SECURE AERIAL CABLE ATTACHMENT TO POLE WITH A POLE BAND AT A HEIGHT TO PROVIDE REQUIRED CLEARANCE TO GROUND PER CITY OF CHICAGO ELECTRICAL CODE SECTION 18-27-225.18. REMOVE POLE CAP AND INSERT CONDUCTORS THROUGH TOP OF POLE. CONNECT TO EXISTING CIRCUITS AT BASE OF POLE. REPLACE POLE CAP WHEN TEMPORARY AERIAL CABLE IS REMOVED.

SHEET E-8 MATCH LINE

50+00

ELSTON AVE.

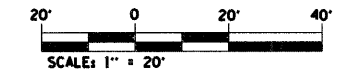

E-7

FILE NAME = \$FILES\$
PLOT DATE = \$DATES\$

SPAAN Tech, Inc.
311 S. Wacker Drive, Suite 2400
Chicago, Illinois 60606
phone: 312.277.8800
fax: 312.277.8800
web: www.spaanTech.com

DESIGNED	I. A. B.	REVISED	-
DRAWN	R. B. G.	REVISED	-
CHECKED	A. D. O.	REVISED	-
DATE	MAY 2010	REVISED	-

**STATE OF ILLINOIS
DEPARTMENT OF TRANSPORTATION**

**TEMPORARY LIGHTING PLAN - IDOT
ELSTON AVENUE OVER I-94**

SCALE: 1" = 20' SHEET NO. 1 OF SHEETS STA. TO STA.

F.A.J. RTE.	SECTION	COUNTY	TOTAL SHEETS	SHEET NO.
94	0101.8B	COOK	139	57
FED. ROAD DIST. NO. - ILLINOIS FED. AID PROJECT			CONTRACT NO. 60C18	