

SHEET E-7 MATCH LINE

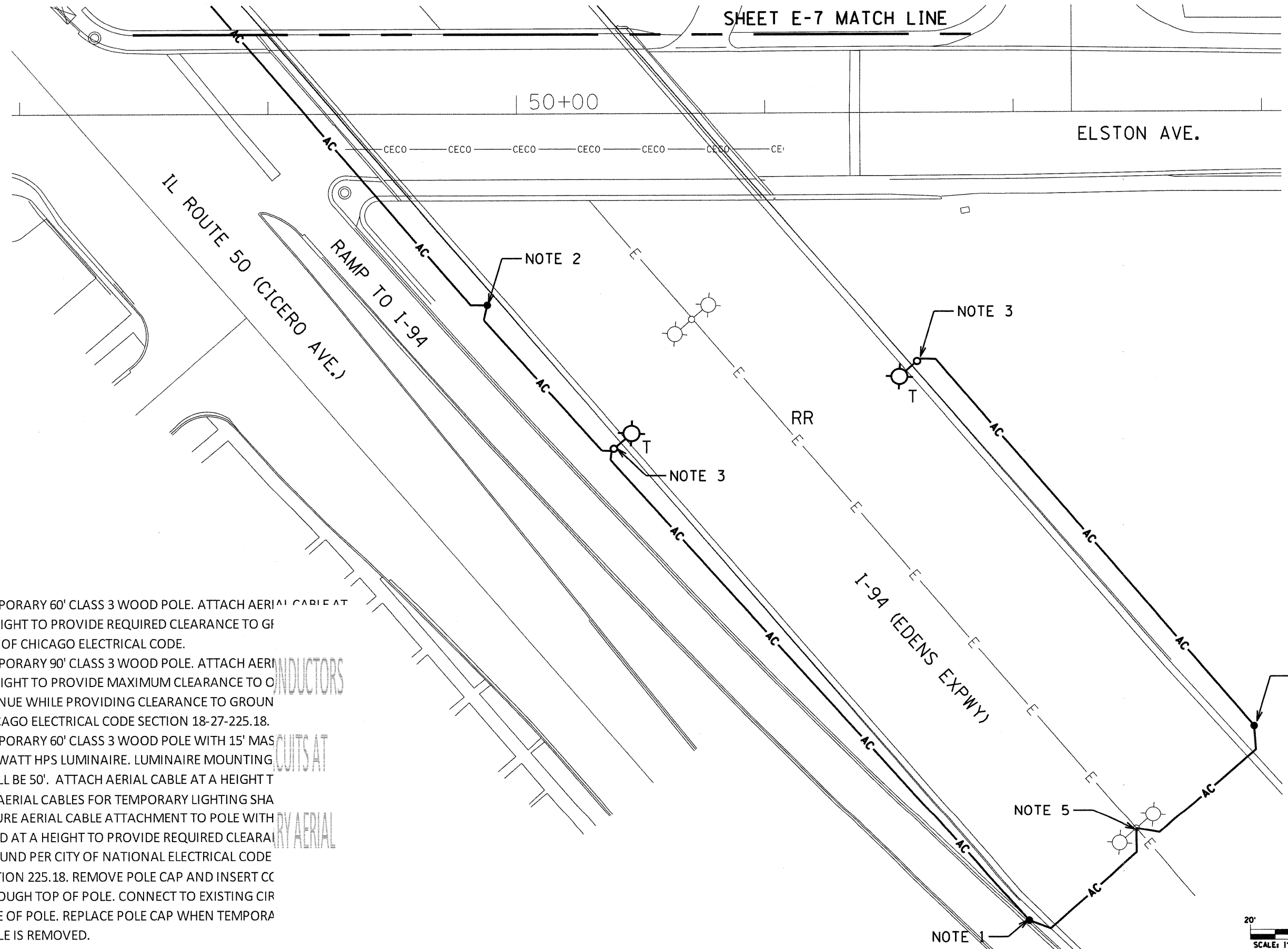

NOTES

1. TEMPORARY 60' CLASS 3 WOOD POLE. ATTACH AERIAL CABLE AT A HEIGHT TO PROVIDE REQUIRED CLEARANCE TO CITY OF CHICAGO ELECTRICAL CODE.
2. TEMPORARY 90' CLASS 3 WOOD POLE. ATTACH AERIAL CABLE AT A HEIGHT TO PROVIDE MAXIMUM CLEARANCE TO OPEN AVENUE WHILE PROVIDING CLEARANCE TO GROUND PER CHICAGO ELECTRICAL CODE SECTION 18-27-225.18.
3. TEMPORARY 60' CLASS 3 WOOD POLE WITH 15' MAXIMUM SPAN. 400 WATT HPS LUMINAIRE. LUMINAIRE MOUNTING SHALL BE 50'. ATTACH AERIAL CABLE AT A HEIGHT TO PROVIDE REQUIRED CLEARANCE TO OPEN AVENUE WHILE PROVIDING CLEARANCE TO GROUND PER CHICAGO ELECTRICAL CODE SECTION 18-27-225.18.
4. ALL AERIAL CABLES FOR TEMPORARY LIGHTING SHALL BE SECURELY ATTACHED TO POLE WITH AERIAL BAND AT A HEIGHT TO PROVIDE REQUIRED CLEARANCE TO OPEN AVENUE WHILE PROVIDING CLEARANCE TO GROUND PER CITY OF NATIONAL ELECTRICAL CODE SECTION 225.18. REMOVE POLE CAP AND INSERT CONDUCTOR THROUGH TOP OF POLE. CONNECT TO EXISTING CIRCUIT BASE OF POLE. REPLACE POLE CAP WHEN TEMPORARY CABLE IS REMOVED.

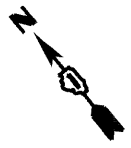
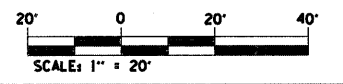

E-8

FILE NAME = #FILES#
PLOT DATE = #DATE#

SPAAN Tech, Inc.
311 S. Wacker Drive, Suite 2400
Chicago, Illinois 60606
phone: 312.277.8800
fax: 312.277.8806
web: www.SpaanTech.com

DESIGNED	I. A. B.	REVISED	-
DRAWN	R. B. G.	REVISED	-
CHECKED	A. D. O.	REVISED	-
DATE	MAY 2010	REVISED	-

**STATE OF ILLINOIS
DEPARTMENT OF TRANSPORTATION**

**TEMPORARY LIGHTING PLAN - IDOT
ELSTON AVENUE OVER I-94**

SCALE: 1" = 20' SHEET NO. OF SHEETS STA. TO STA.

F.A.J. RTE.	SECTION	COUNTY	TOTAL SHEETS	SHEET NO.
94	0101.BB	COOK	139	58
FED. ROAD DIST. NO. - ILLINOIS FED. AID PROJECT			CONTRACT NO. 60C18	