

STATE OF ILLINOIS
DEPARTMENT OF TRANSPORTATION

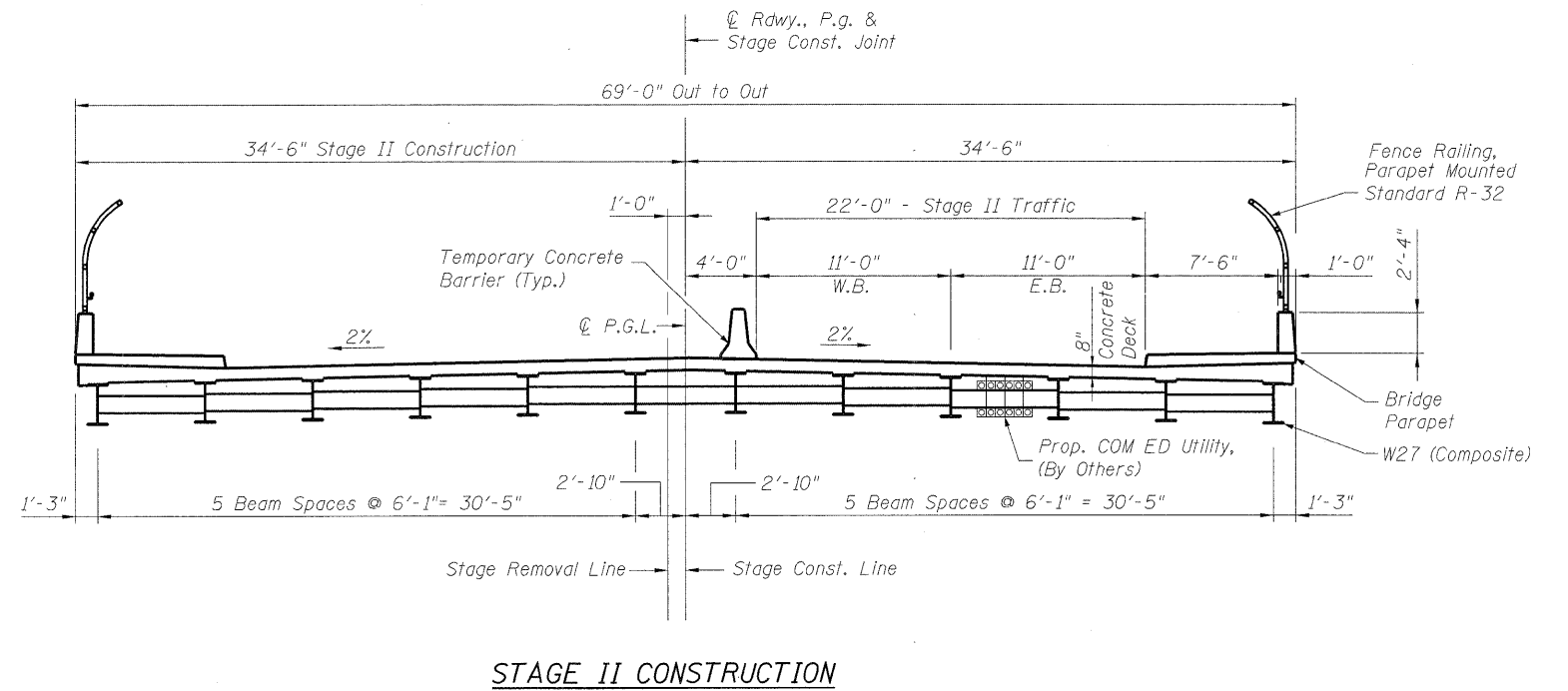
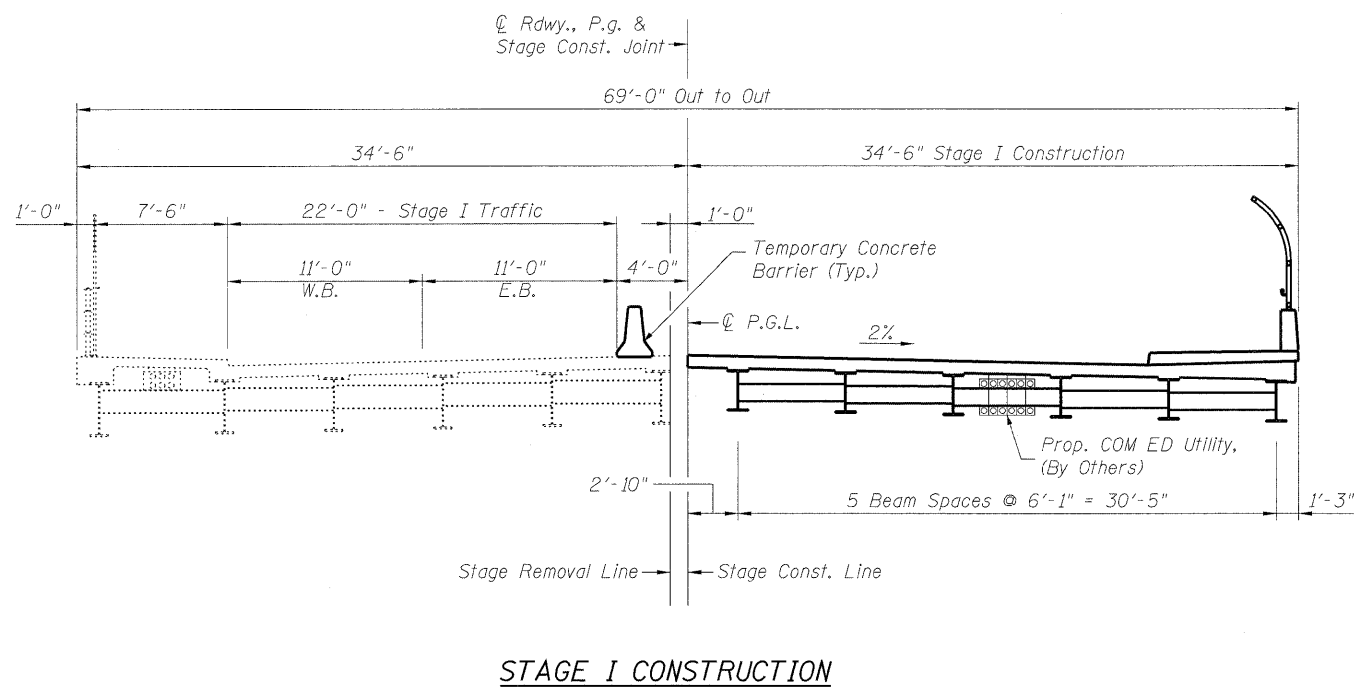
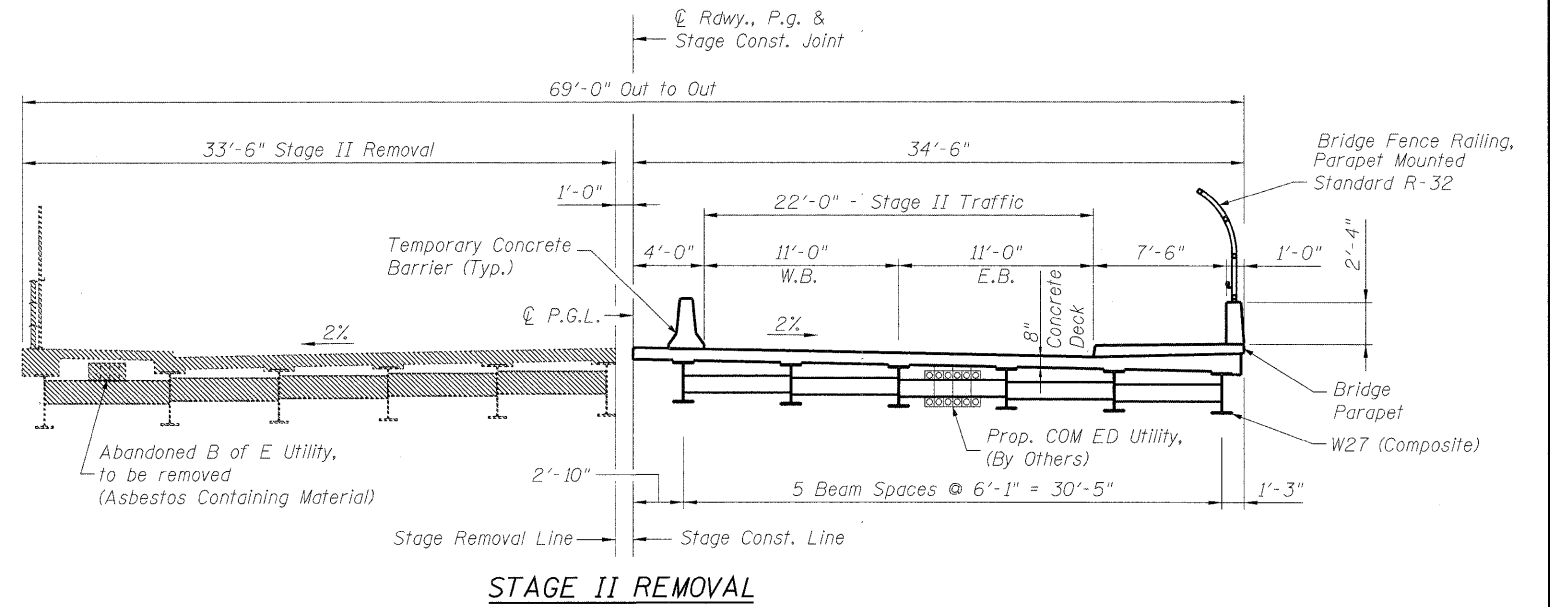
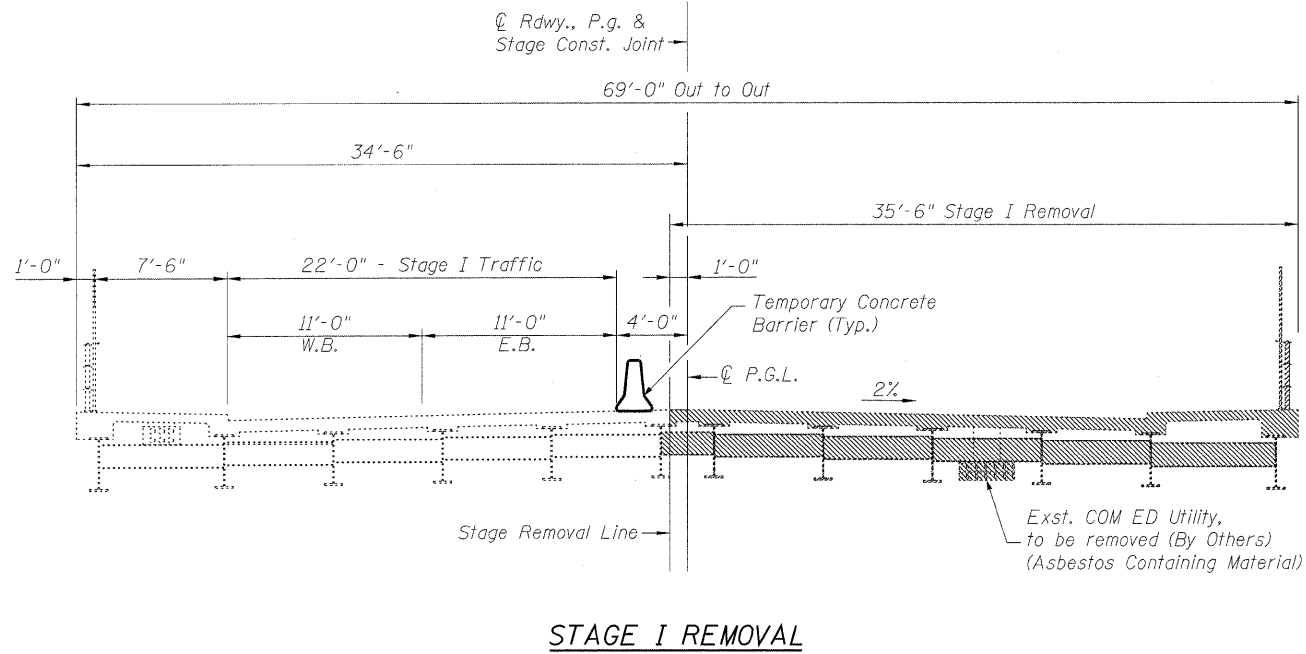

DESIGNED - ASP
CHECKED - WSP
DRAWN - BEM
CHECKED - ASP

Notes:

1. Stage removal and construction locations differ for the superstructure and substructure.
2. The cost of existing bridge rail removal and fence removal is included in the cost of Removal of Existing Superstructure, see Special Provision.
3. See Roadway Plans for quantity of Temporary Concrete Barrier.

**CONSTRUCTION STAGING
STRUCTURE NUMBER 016-0610**

DLZ 85 W. Algonquin Rd. Ste. 220
Arlington Heights IL 60005
DLZ Illinois, Inc. (847)-640-0840

SHEET NO. 3 OF 42 SHEETS	F.A. RTE.	SECTION	COUNTY	TOTAL SHEETS	SHEET NO.
	94	0101.8B	COOK	139	79
CONTRACT NO. 60C18					
ILLINOIS FED. AID PROJECT					