

STATE OF ILLINOIS
DEPARTMENT OF TRANSPORTATION

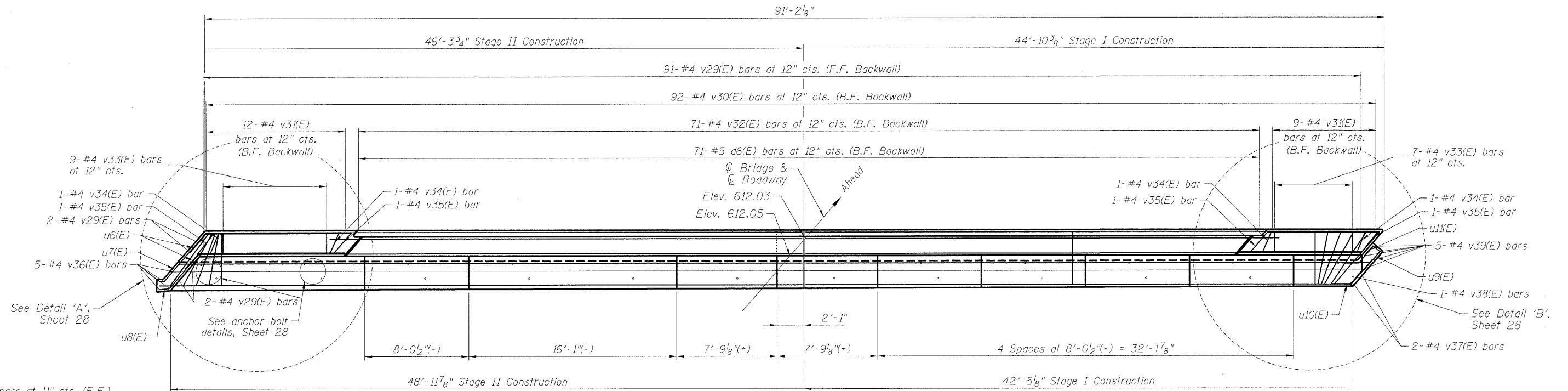

PLAN VIEW (PROPOSED)

- ① 5-#4 u6(E) bars at 11" cts. (E.F.)
5-#4 u7(E) bars at 11" cts. (B.F.)
5-#4 u8(E) bars at 11" cts. (F.F.)
- ② 5-#4 u10(E) bars at 11" cts.
5-#4 u11(E) bars at 11" cts.
- ③ 8-#4 u9(E) bars at 11" cts.

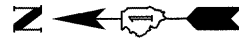
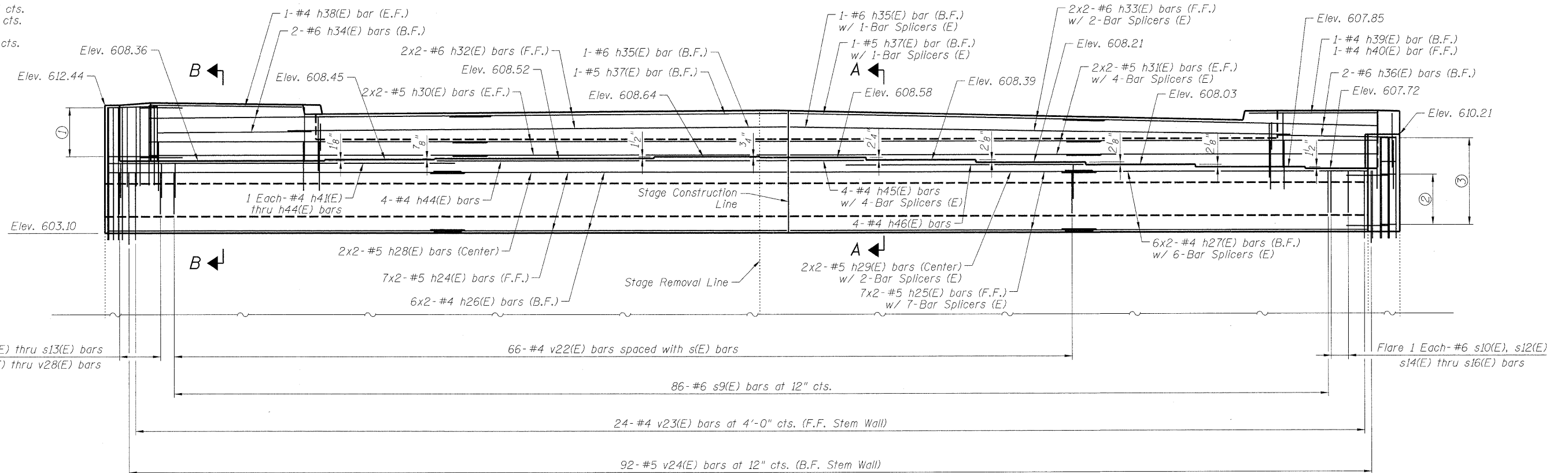

PARTIAL ELEVATION VIEW (PROPOSED)

(Looking Ahead)

Notes:

F.F. = Front Face
B.F. = Back Face
E.F. = Each Face
See Sections A-A and B-B, Sheet 30
for horizontal bar placement.

Bars indicated thus 7x2 - #5 etc.
indicates 7 lines of bars with
2 lengths per line.

DESIGNED - ASP
CHECKED - DPW
DRAWN - LNB
CHECKED - ASP

DLZ 85 W. Algonquin Rd. Ste. 220
Arlington Heights IL 60005
DLZ Illinois, Inc. (847)-640-0840

SHEET NO. 29 OF 42 SHEETS	F.A. RTE. 94	SECTION 0101.8B	COUNTY COOK	TOTAL SHEETS 139	SHEET NO. 105
	CONTRACT NO. 60C18				
ILLINOIS FED. AID PROJECT					

EAST ABUTMENT II
STRUCTURE NUMBER 016-0610