



- EXISTING LEGEND**
-  PAVEMENT REMOVAL
 -  PAVED SHOULDER REMOVAL
 -  DRIVEWAY PAVEMENT REMOVAL
 -  HOT MIX ASPHALT SURFACE REMOVAL
 -  TREE REMOVAL WITH UNIT DIAMETER TRUNK
 -  LINEAL REMOVAL ITEM
 -  CONTROL POINT NUMBER

- NOTES:**
1. SEE ELECTRICAL PLANS FOR LIGHTING REMOVALS.
 2. SEE DRAINAGE PLANS FOR DRAINAGE REMOVALS.

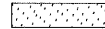
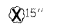
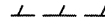
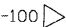
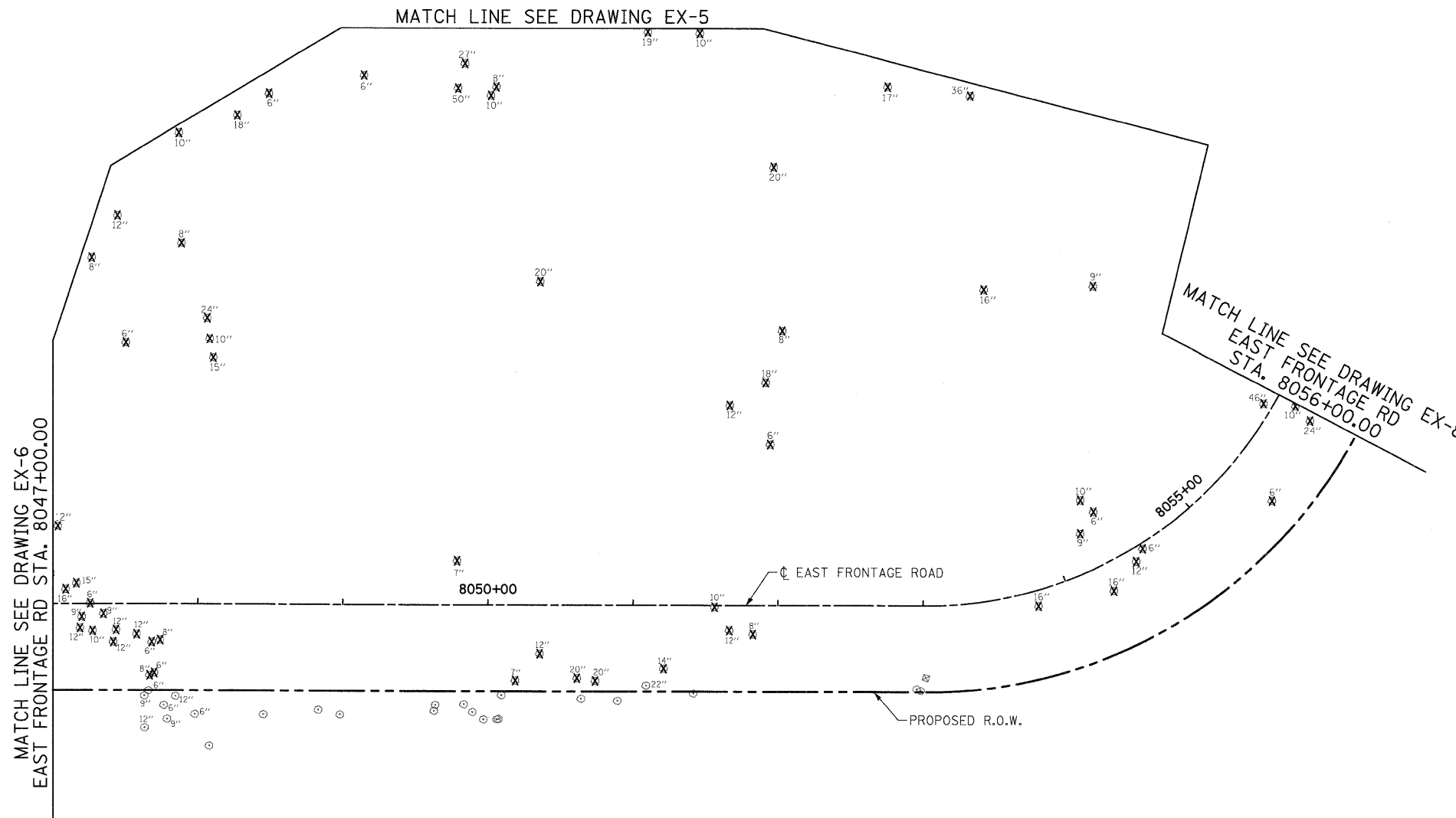

McDonough Associates Inc.
 Engineers / Architects
 130 East Randolph Street, Chicago, Illinois 60601

FILE NAME =	USER NAME = TKluegel
D160C31-SHT-REM07.dgn	

PLOT SCALE = 1:50'	DESIGNED - JTF	REVISED -
PLOT DATE = 12/11/2009	DRAWN - JTF	REVISED -
	CHECKED - DLT	REVISED -
	DATE - 12/18/09	REVISED -

DESIGNED - JTF	REVISED -
DRAWN - JTF	REVISED -
CHECKED - DLT	REVISED -
DATE - 12/18/09	REVISED -

**STATE OF ILLINOIS
DEPARTMENT OF TRANSPORTATION**

EXISTING PLAN AND REMOVALS

SCALE: 1"=50' SHEET NO. 7 OF 15 SHEETS STA. TO STA.

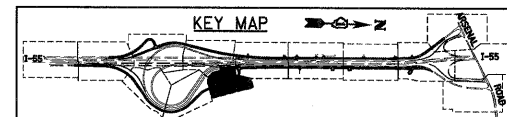

F.A.I. RTE.	SECTION	COUNTY	TOTAL SHEETS	SHEET NO.
55	(99-1&2)AC-3	WILL	524	44
CONTRACT NO. 60C31				
FED. ROAD DIST. NO. 1 ILLINOIS FED. AID PROJECT				

FINAL