

- PROPOSED LEGEND**
- (A) PCC PAVEMENT 10" (JOINTED)
 - (B) PCC SHOULDERS, 10"
 - (C) AGGREGATE SHOULDERS, TYPE B
 - (D) HMA PAVEMENT (SEE TYPICAL SECTIONS)
 - (E) HMA SHOULDERS (SEE TYPICAL SECTIONS)
 - (F) NOT USED
 - (G) HMA DRIVEWAY PAVEMENT
 - (H) PCC DRIVEWAY PAVEMENT, 10"
 - (I) STATION OFFSET
 - FENCE AS INDICATED IN PLANS. (OFFSET FOR CLARITY)

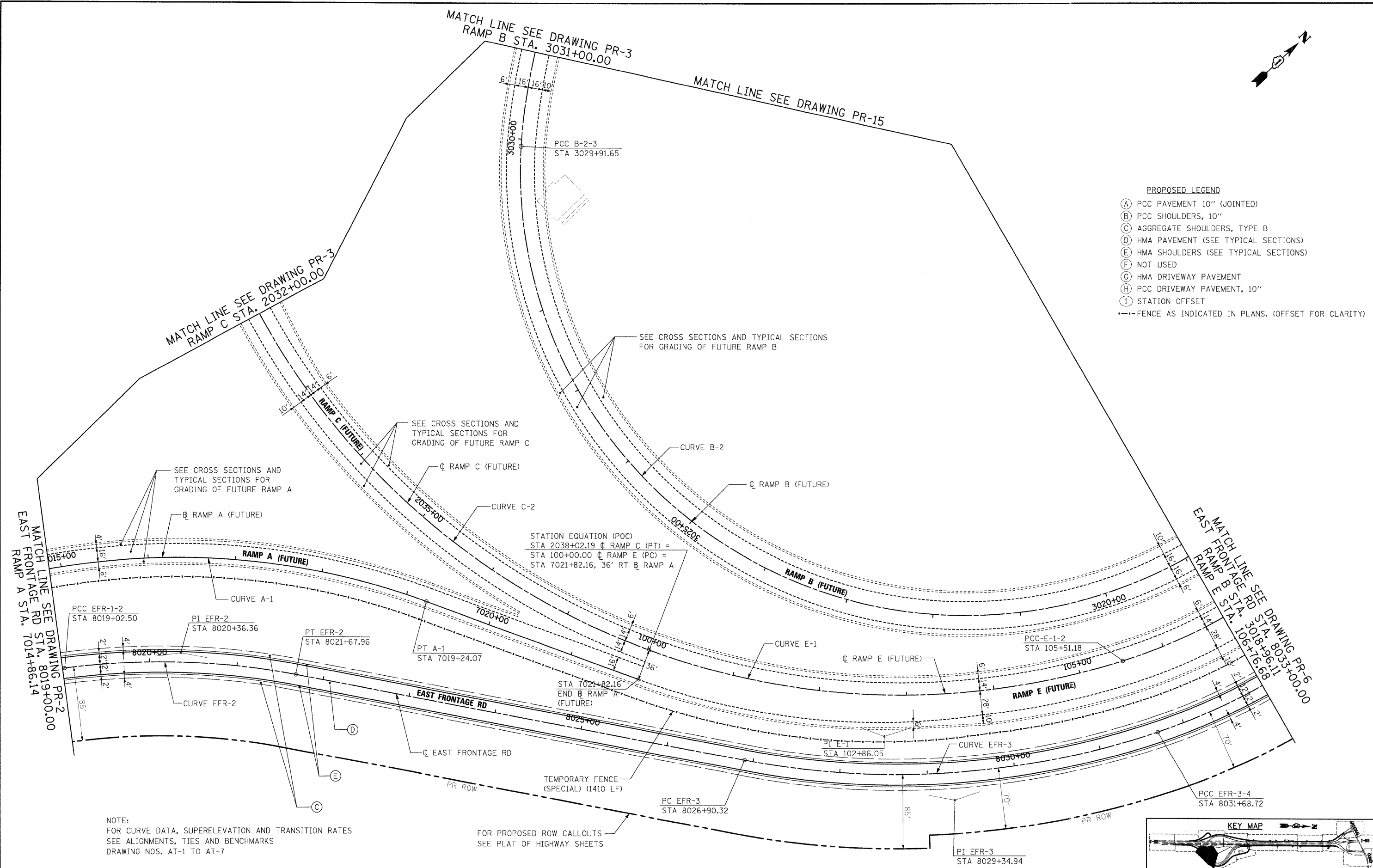

NOTE:
 FOR CURVE DATA, SUPERELEVATION AND TRANSITION RATES
 SEE ALIGNMENTS, TIES AND BENCHMARKS
 DRAWING NOS. AT-1 TO AT-7

FOR PROPOSED ROW CALLOUTS
 SEE PLAT OF HIGHWAY SHEETS

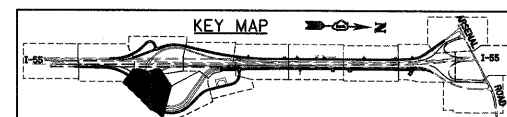

McDonough Associates Inc.
 Engineers / Architects
 130 East Randolph Street, Chicago, Illinois 60601

FILE NAME = D162C31-SHT-PLAN04.dgn	USER NAME = TKluegel	DESIGNED - JTF	REVISED -
		DRAWN - JTF	REVISED -
		CHECKED - DLT	REVISED -
		DATE - 12/18/09	REVISED -

**STATE OF ILLINOIS
 DEPARTMENT OF TRANSPORTATION**

PROPOSED PLAN

SCALE: 1"=50' SHEET NO. 4 OF 15 SHEETS STA. TO STA.

F.A.I. RTE.	SECTION	COUNTY	TOTAL SHEETS	SHEET NO.
55	(99-18.2)AC-3	WILL	524	56
CONTRACT NO. 60C31				
FED. ROAD DIST. NO. 1 ILLINOIS FED. AID PROJECT				

FINAL