

NOTE:  
FOR CURVE DATA, SUPERELEVATION AND TRANSITION  
RATES SEE ALIGNMENTS, TIES AND BENCHMARKS  
DRAWING NOS. AT-1 TO AT-7

STATION EQUATION  
STA 3000+00.00, 21.00 LT  $\phi$  RAMP B =  
STA 126+08.25, 21.00 LT  $\phi$  RAMP E =  
STA 900+00.00  $\phi$  ARSENAL ROAD  
BEGIN ARSENAL RD IMPROVEMENT

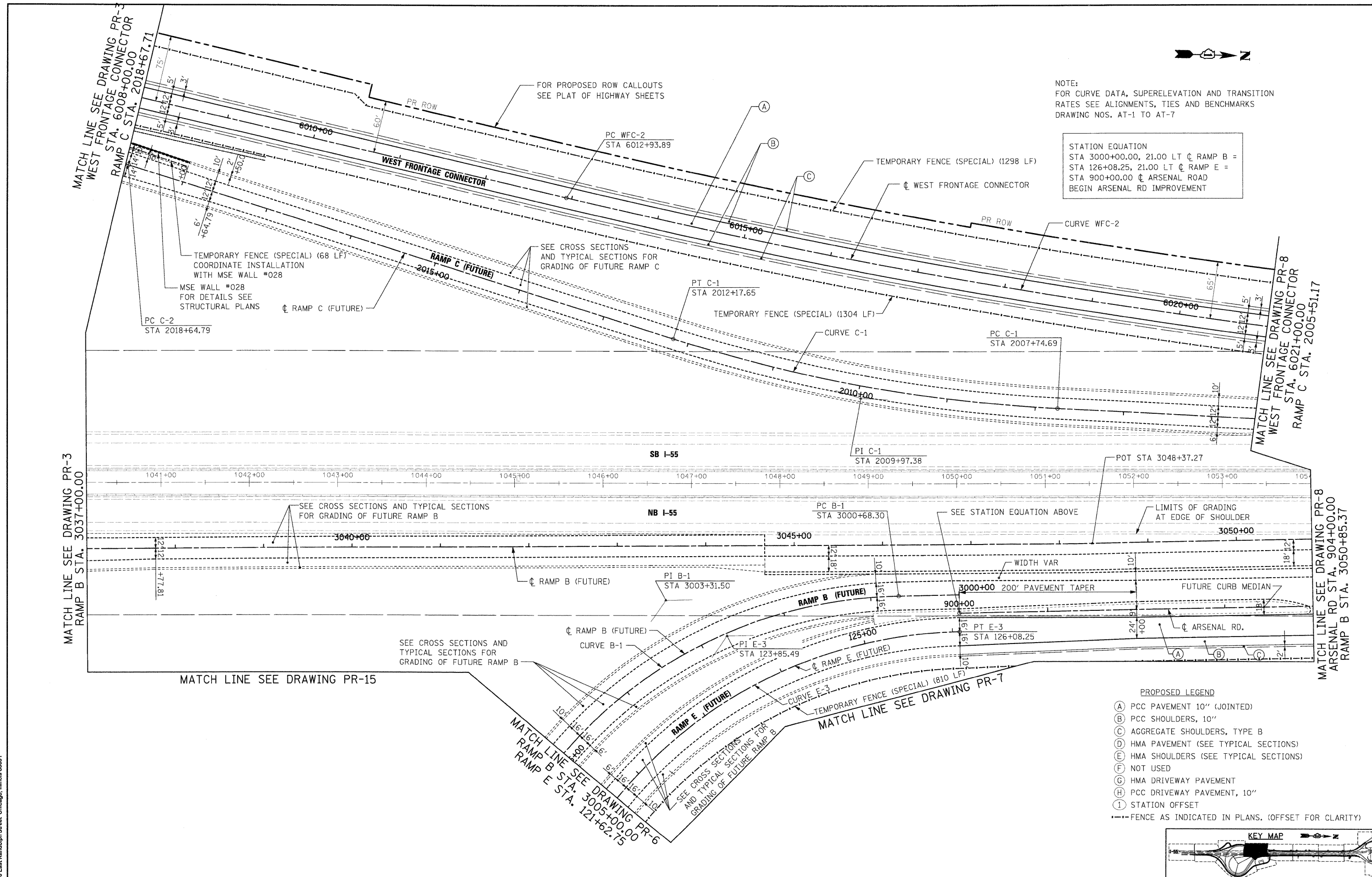

- PROPOSED LEGEND
- (A) PCC PAVEMENT 10" (JOINTED)
  - (B) PCC SHOULDERS, 10"
  - (C) AGGREGATE SHOULDERS, TYPE B
  - (D) HMA PAVEMENT (SEE TYPICAL SECTIONS)
  - (E) HMA SHOULDERS (SEE TYPICAL SECTIONS)
  - (F) NOT USED
  - (G) HMA DRIVEWAY PAVEMENT
  - (H) PCC DRIVEWAY PAVEMENT, 10"
  - (I) STATION OFFSET
- FENCE AS INDICATED IN PLANS. (OFFSET FOR CLARITY)

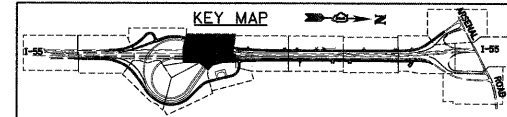

McDonough Associates Inc.  
 Engineers / Architects  
 130 East Randolph Street Chicago, Illinois 60601

FILE NAME = D162C31-SHT-PLAN05.dgn  
 USER NAME = TKLuagel  
 PLOT SCALE = 1:50  
 PLOT DATE = 12/1/2009

DESIGNED - JTF  
 DRAWN - JTF  
 CHECKED - DLT  
 DATE - 12/18/09

REVISED -  
 REVISED -  
 REVISED -  
 REVISED -

**STATE OF ILLINOIS  
 DEPARTMENT OF TRANSPORTATION**

**PROPOSED PLAN**

SCALE: 1"=50' SHEET NO. 5 OF 15 SHEETS STA. TO STA.

F.A.I. RTE.	SECTION	COUNTY	TOTAL SHEETS	SHEET NO.
55	(99-1&2)AC-3	WILL	524	57
CONTRACT NO. 60C31			ILLINOIS FED. AID PROJECT	

**FINAL**