

EJM ENGINEERING, INC.
 411 South Wells Street Suite 800
 Chicago, Illinois 60607

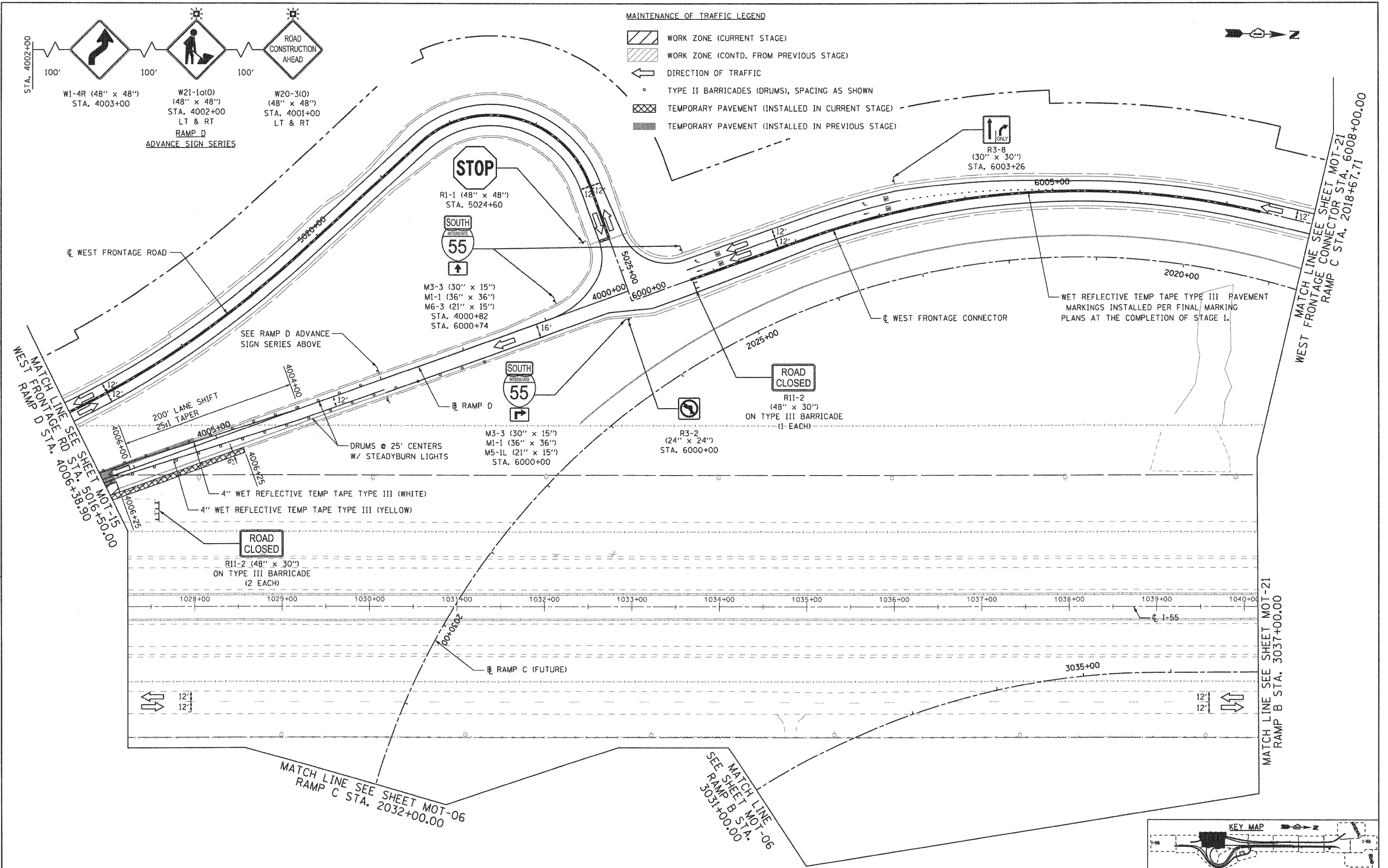

- MAINTENANCE OF TRAFFIC LEGEND**
- WORK ZONE (CURRENT STAGE)
 - WORK ZONE (CONTD. FROM PREVIOUS STAGE)
 - DIRECTION OF TRAFFIC
 - TYPE II BARRICADES (DRUMS), SPACING AS SHOWN
 - TEMPORARY PAVEMENT (INSTALLED IN CURRENT STAGE)
 - TEMPORARY PAVEMENT (INSTALLED IN PREVIOUS STAGE)

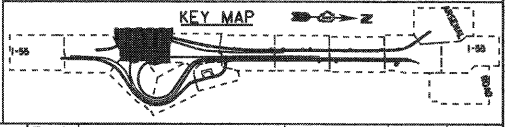

FILE NAME =	USER NAME = gms	DESIGNED - GR	REVISED -
...ND160C31-SHT-STAGING1A03.dgn		DRAWN - GR	REVISED -
	PLOT SCALE = 1/50	CHECKED - RY	REVISED -
	PLOT DATE = 12/15/2009	DATE - 12/18/2009	REVISED -

**STATE OF ILLINOIS
 DEPARTMENT OF TRANSPORTATION**

**MAINTENANCE OF TRAFFIC
 STAGE 1A**

SCALE: 1"=50' SHEET NO. 2 OF 2 SHEETS STA. TO STA.

F.A.1 RTE.	SECTION	COUNTY	TOTAL SHEETS	SHEET NO.
55	(99-1&2)-3	WILL	524	102
CONTRACT NO. 60C31			FED. ROAD DIST. NO. 1 ILLINOIS FED. AID PROJECT	

FINAL