

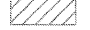

EJM ENGINEERING, INC.
 411 South Wells Street Suite 800
 Chicago, Illinois 60607

- MAINTENANCE OF TRAFFIC LEGEND**
-  WORK ZONE (CURRENT STAGE)
 -  WORK ZONE (CONTD. FROM PREVIOUS STAGE)
 -  DIRECTION OF TRAFFIC
 -  TYPE II BARRICADES (DRUMS), SPACING AS SHOWN
 -  TEMPORARY PAVEMENT (INSTALLED IN CURRENT STAGE)
 -  TEMPORARY PAVEMENT (INSTALLED IN PREVIOUS STAGE)

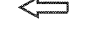
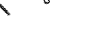

FILE NAME = ...\\DI60C31-SHT-STAGING203.dgn

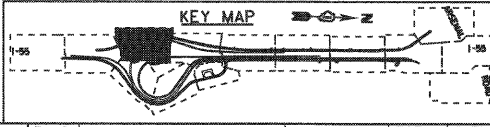
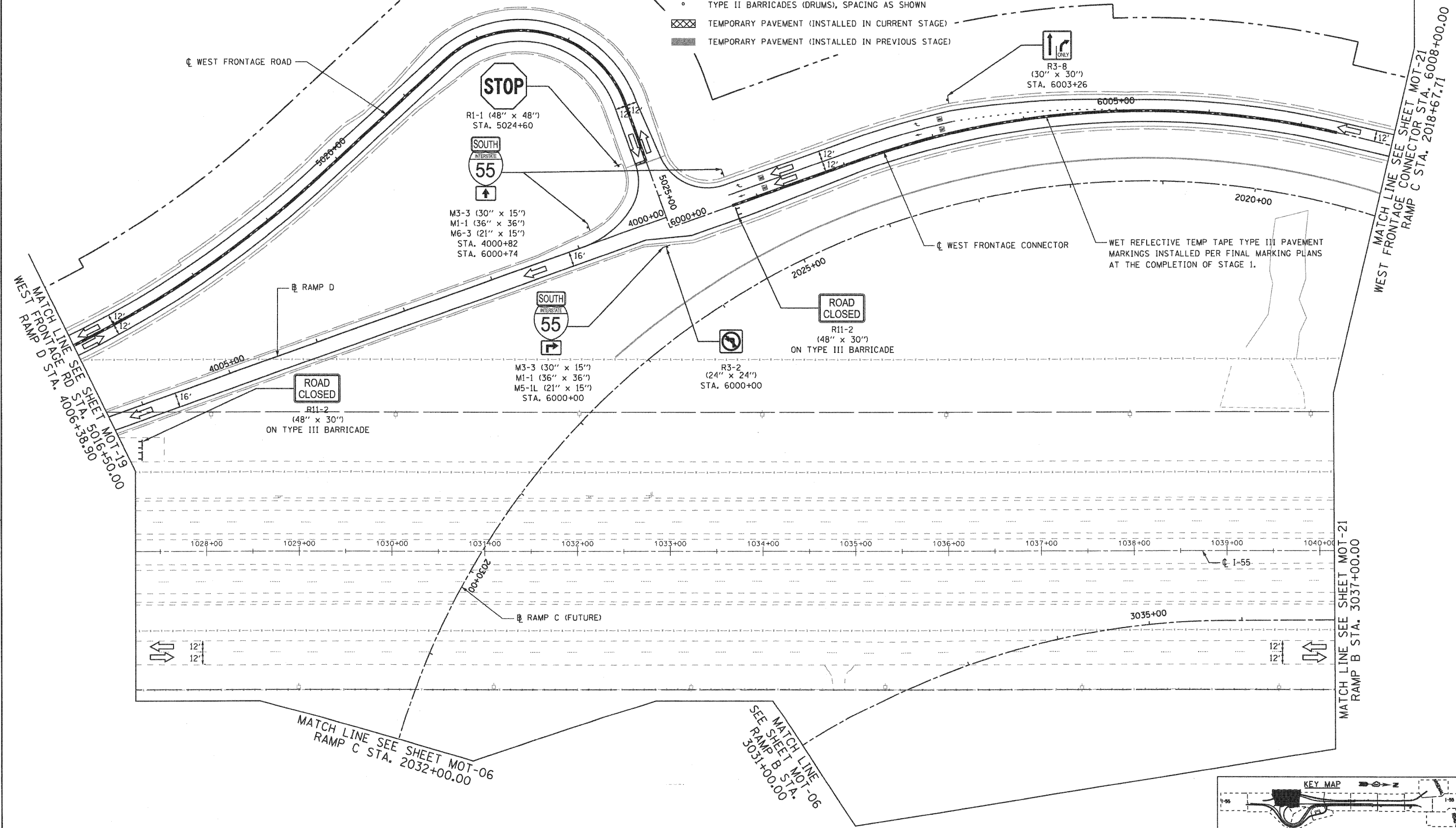
USER NAME = grom	DESIGNED - GR	REVISED -
PLOT SCALE = 1/8"	DRAWN - GR	REVISED -
PLOT DATE = 12/16/2009	CHECKED - RY	REVISED -
	DATE - 12/18/2009	REVISED -

**STATE OF ILLINOIS
 DEPARTMENT OF TRANSPORTATION**

**MAINTENANCE OF TRAFFIC
 STAGE 2**

SCALE: 1"=50' SHEET NO. 2 OF 8 SHEETS STA. TO STA.

F.A.I. RTE.	SECTION	COUNTY	TOTAL SHEETS	SHEET NO.
55	(99-1&2)-3	WILL	524	106
CONTRACT NO. 60C31			FED. ROAD DIST. NO. 1 ILLINOIS FED. AID PROJECT	

FINAL