

FINAL SURVEY	SURVEYED	BY	DATE
NOTE BOOK NO.	PLOTTED		
	DATE		
	AREAS CHECKED		

ORIGINAL SURVEY	SURVEYED	BY	DATE
NOTE BOOK NO.	PLOTTED		
	DATE		
	AREAS CHECKED		

**McDonough Associates Inc.**  
 Engineers/Architects  
 100 East Randolph Street, Chicago, Illinois 60601

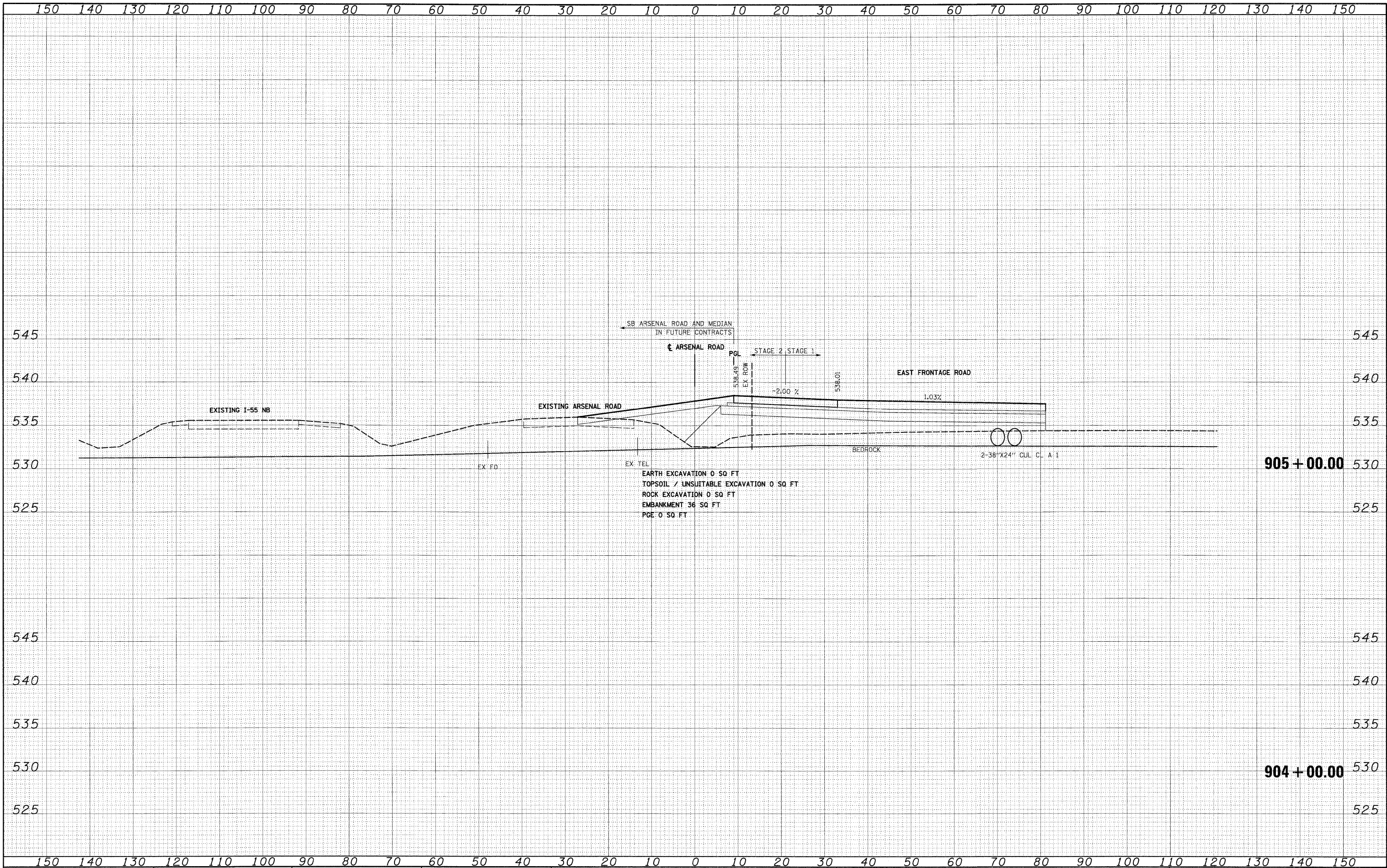

FILE NAME = D:\60C31-SHT-XSSH11.dgn  
 USER NAME = TKluerg1

DESIGNED - TRK  
 DRAWN - TRK  
 CHECKED - DLT  
 PLOT DATE = 12/11/2009

REVISIED -  
 REVISIED -  
 REVISIED -  
 REVISIED -

DATE = 12/18/09

**STATE OF ILLINOIS  
 DEPARTMENT OF TRANSPORTATION**

**STAGE 1 ARSENAL ROAD CROSS SECTIONS**  
 SCALE: 1"=10'H; 1"=5'V SHEET NO. 1 OF 2 SHEETS STA. 904+00.00 TO STA. 905+00.00

F.A.I. RTE.	SECTION	COUNTY	TOTAL SHEETS	SHEET NO.
55	(99-1&2)AC-3	WILL	524	358
CONTRACT NO. 60C31			FED. ROAD DIST. NO. 1   ILLINOIS FED. AID PROJECT	

FINAL