

DATE	
BY	
SURVEYED	
PLOTTED	
NOTE BOOK	
AREAS CHECKED	
NO.	

DATE	
BY	
SURVEYED	
PLOTTED	
NOTE BOOK	
AREAS CHECKED	
NO.	

McDonough Associates Inc.
 Engineers/Architects
 738 East Randolph Street, Chicago, Illinois 60601

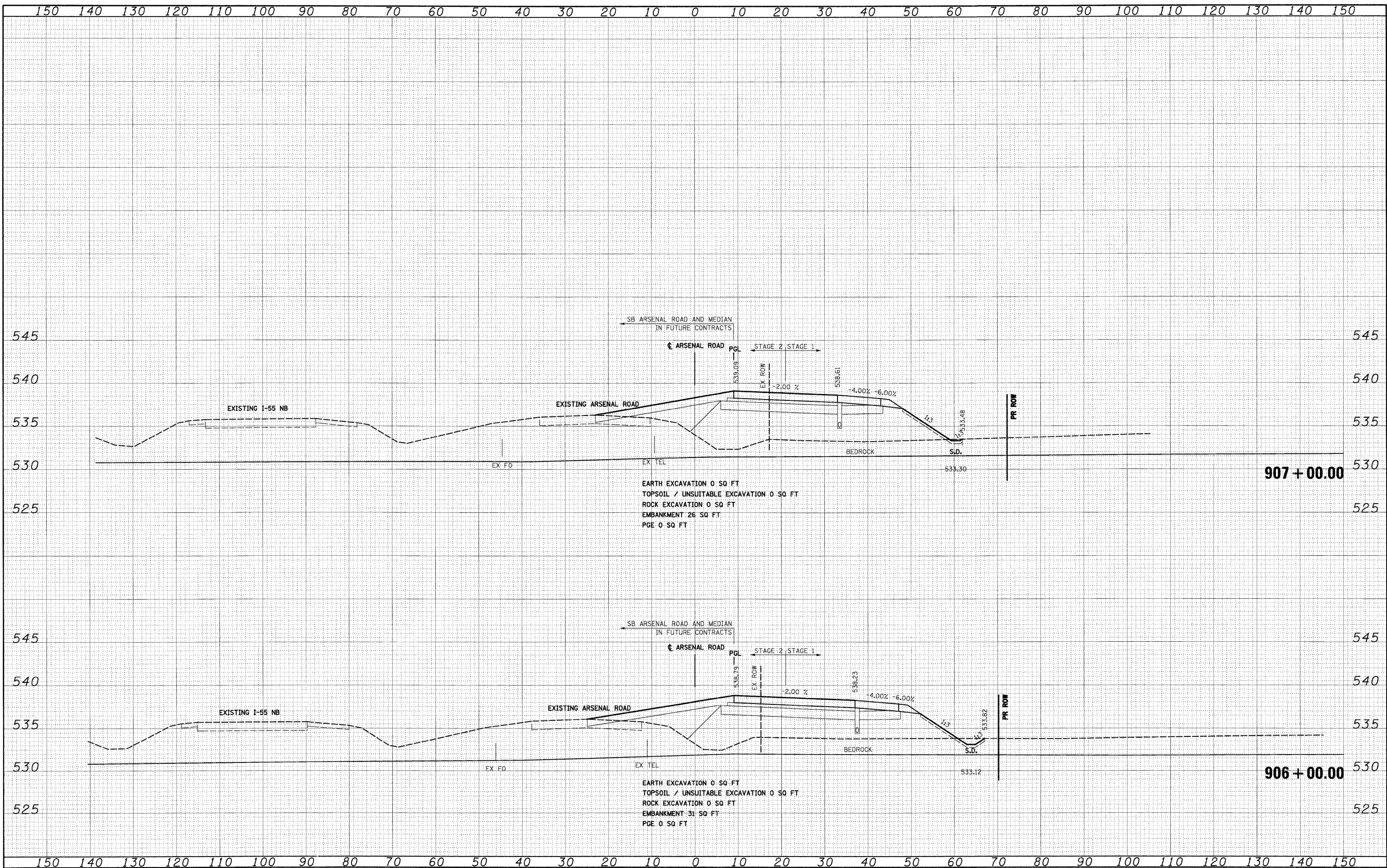

FILE NAME = D:\60C31-SHT-X55HT11.dgn
 USER NAME = TK1uege1

DESIGNED - TRK
 DRAWN - TRK
 CHECKED - DLT
 DATE - 12/18/09

REVISIED -
 REVISIED -
 REVISIED -
 REVISIED -

**STATE OF ILLINOIS
 DEPARTMENT OF TRANSPORTATION**

STAGE 1 ARSENAL ROAD CROSS SECTIONS

SCALE: 1"=10'H; 1"=5'V SHEET NO. 2 OF 2 SHEETS STA. 906+00.00 TO STA. 907+00.00

F.A.I. RTE.	SECTION	COUNTY	TOTAL SHEETS	SHEET NO.
55	(99-1&2)AC-3	WILL	524	359
CONTRACT NO. 60C31				

FED. ROAD DIST. NO. 1 ILLINOIS FED. AID PROJECT