

DATE	
BY	
SURVEYED	
PLOTTED	
NOTE BOOK	
AREAS	
CHECKED	
NO.	

DATE	
BY	
SURVEYED	
PLOTTED	
NOTE BOOK	
AREAS	
CHECKED	
NO.	

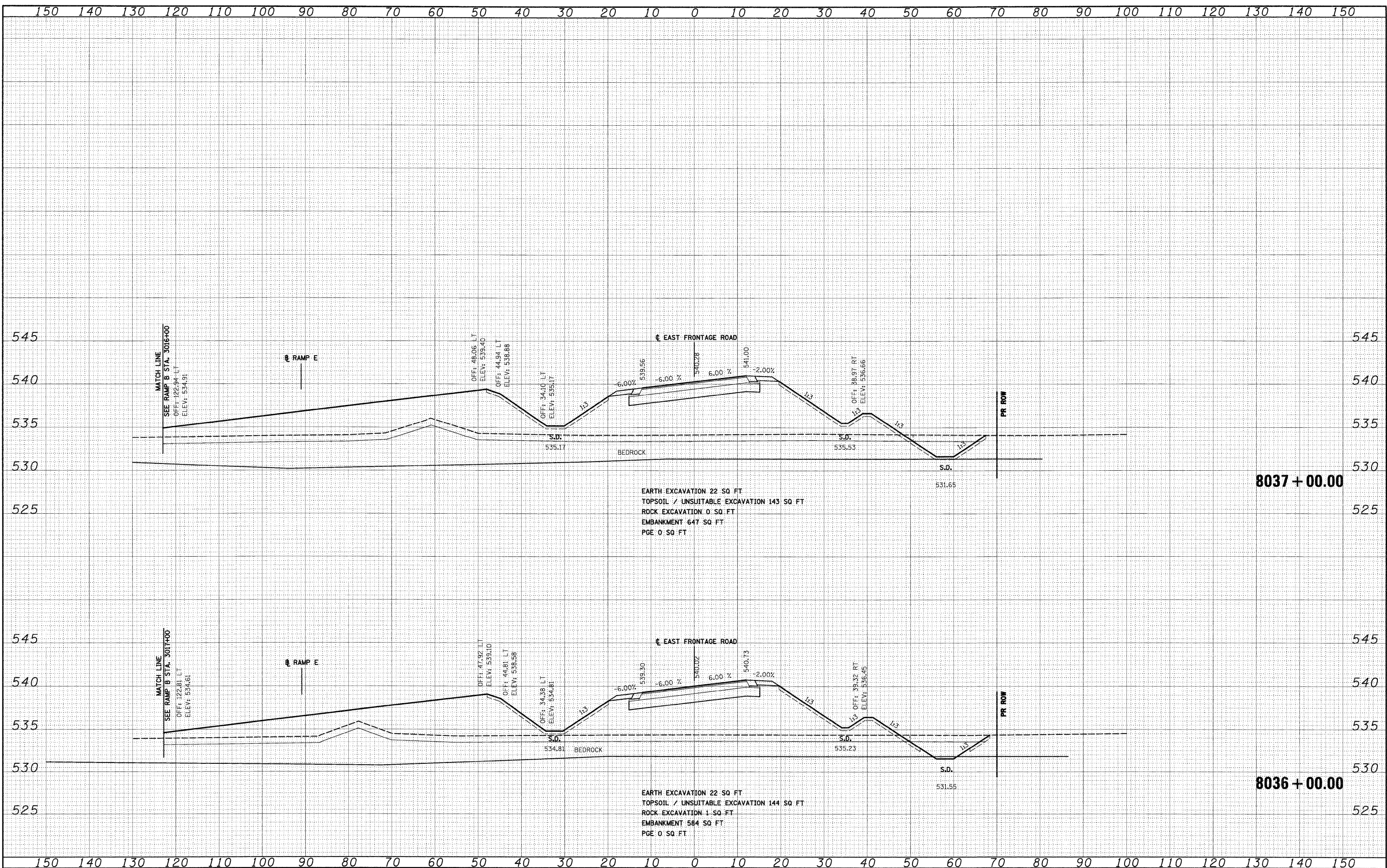

FILE NAME = D:\60C31-SHT-XSSH104.dgn
USER NAME = TK1uegl

DESIGNED	- TRK	REVISED	-
DRAWN	- TRK	REVISED	-
CHECKED	- DLT	REVISED	-
DATE	- 12/18/09	REVISED	-

DESIGNED	- TRK	REVISED	-
DRAWN	- TRK	REVISED	-
CHECKED	- DLT	REVISED	-
DATE	- 12/18/09	REVISED	-

**STATE OF ILLINOIS
DEPARTMENT OF TRANSPORTATION**

EAST FRONTAGE ROAD

SCALE: 1"=10'H; 1"=5'V SHEET NO. 18 OF 30 SHEETS STA. 8036+00.00 TO STA. 8037+00.00

F.A.I. RTE.	SECTION	COUNTY	TOTAL SHEETS	SHEET NO.
55	(99-1&2)AC-3	WILL	524	446
CONTRACT NO. 60C31				
FED. ROAD DIST. NO. 1 ILLINOIS FED. AID PROJECT				