

FINAL SURVEY	SURVEYED	BY	DATE
NOTE BOOK NO.	PLOTTED		
	DATE		
	AREAS CHECKED		

ORIGINAL SURVEY	SURVEYED	BY	DATE
NOTE BOOK NO.	PLOTTED		
	DATE		
	AREAS CHECKED		

**McDonough Associates Inc.**  
 Engineers/Architects  
 700 East Randolph Street, Chicago, Illinois 60601

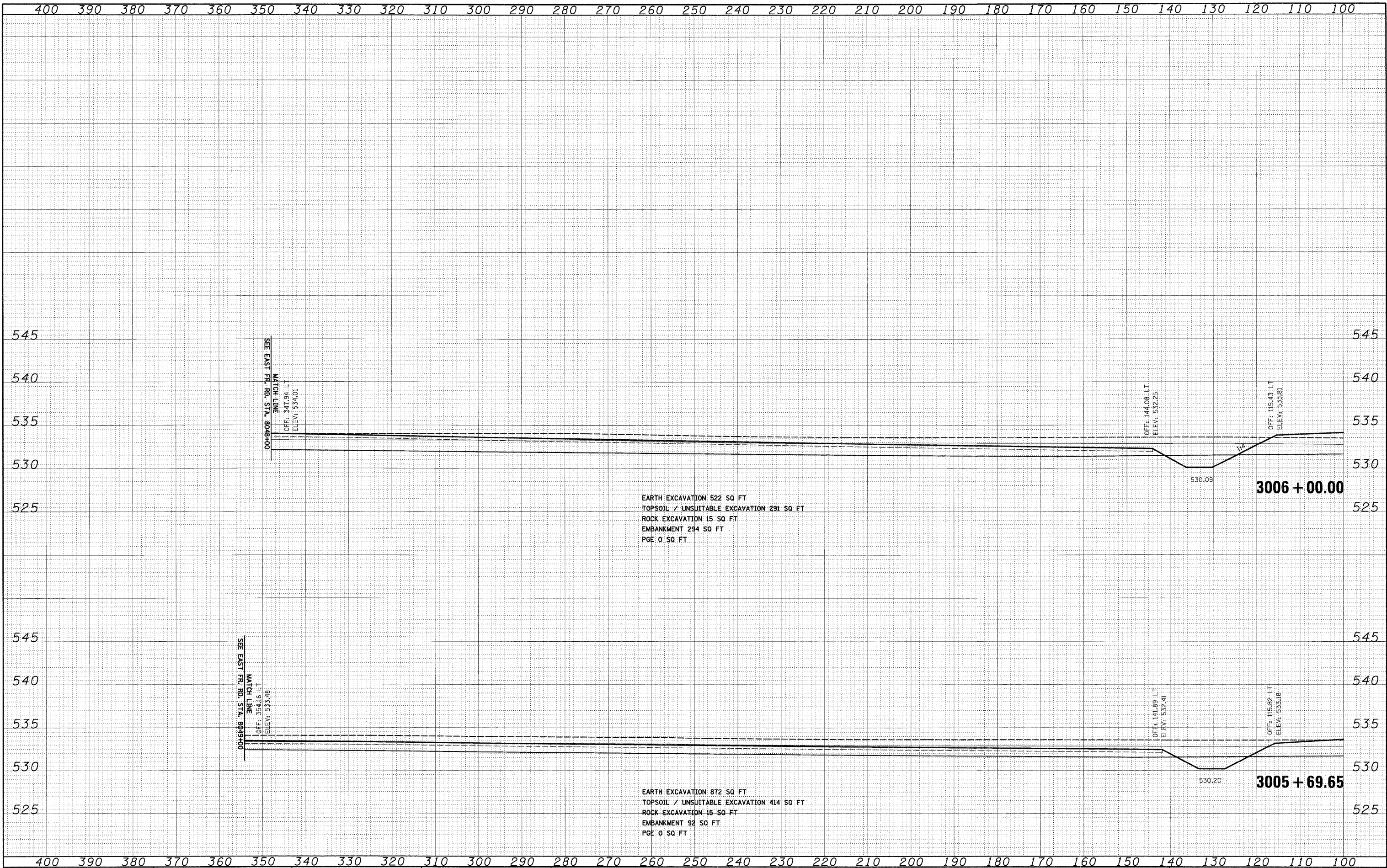

FILE NAME = D:\60C31-SHT-XSSH705.dgn

USER NAME = TKluegel	DESIGNED - TRK	REVISED -
PLLOT SCALE = 1:10	DRAWN - TRK	REVISED -
PLLOT DATE = 12/11/2009	CHECKED - DLT	REVISED -
	DATE - 12/18/09	REVISED -

**STATE OF ILLINOIS  
 DEPARTMENT OF TRANSPORTATION**

**RAMP B CROSS SECTIONS**

SCALE: 1"=10'H; 1"=5'V SHEET NO. 23 OF 36 SHEETS STA. 3005+69.65 TO STA. 3006+00.00

F.A.I. RTE. 55	SECTION (99-1&2)AC-3	COUNTY WILL	TOTAL SHEETS 524	SHEET NO. 481
CONTRACT NO. 60C31			FED. ROAD DIST. NO. 1   ILLINOIS   FED. AID PROJECT	

**FINAL**