

STATE OF ILLINOIS  
DEPARTMENT OF TRANSPORTATION

Notes:  
See sheet S12 of S19 for Sections C-C & D-D and View E-E.  
All a(E) and w(E) bar spacings measured parallel to  $\phi$  Rdwy.  
East Approach Slab Shown, West Approach Slab is similar and opposite hand.

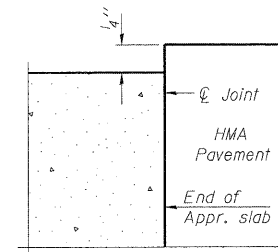
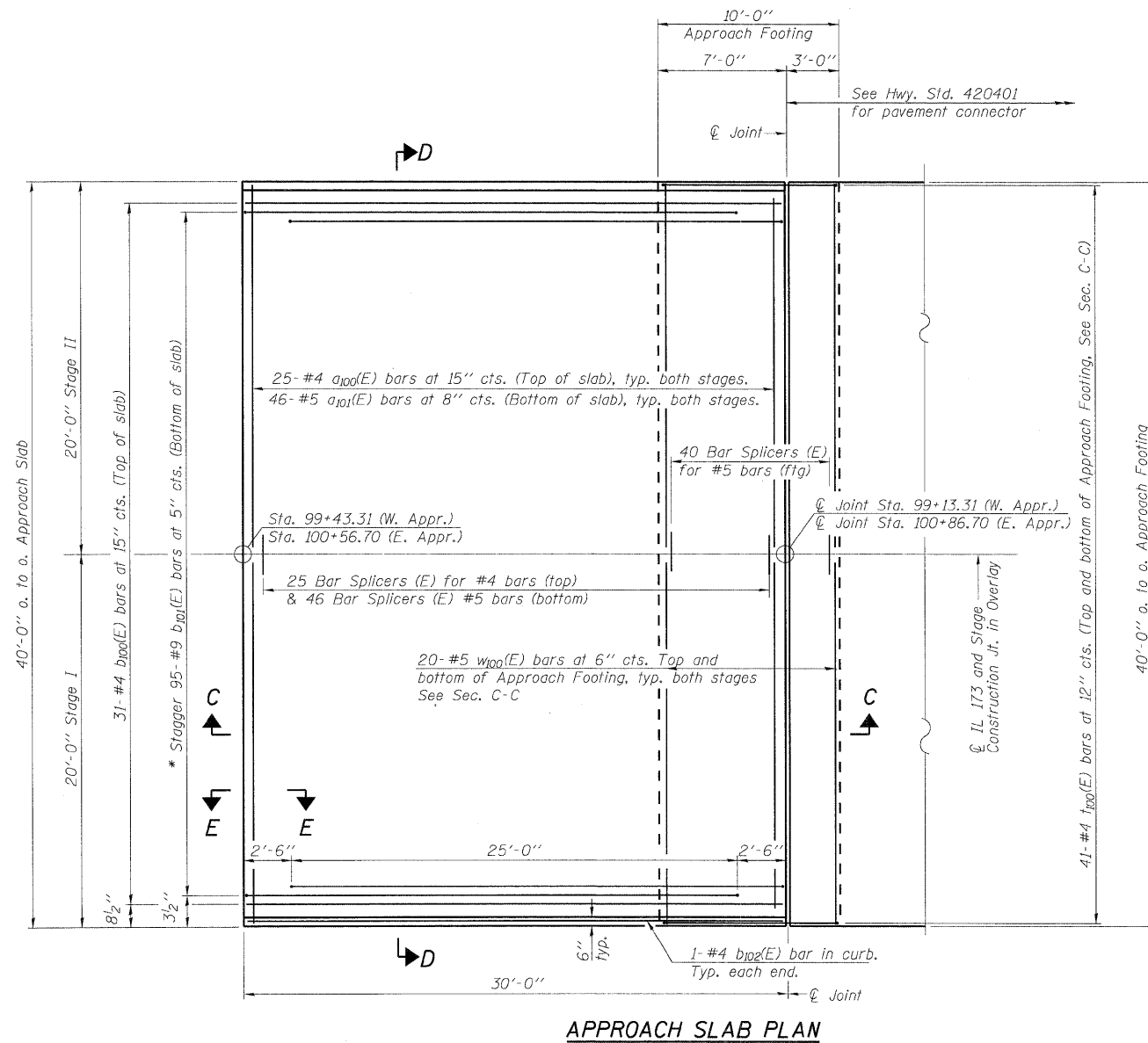

**FLEXIBLE PAVEMENT**

**DETAIL A**

\* Tilt #9  $b_{101}(E)$  bars as required to maintain clearance.

DESIGNED -	SLV
CHECKED -	DJB
DRAWN -	SLV
CHECKED -	DJB

**LONCO, INC.**  
CONSULTING ENGINEERS  
1560 WALL ST., SUITE 222  
NAPERVILLE, ILLINOIS 60563 PH: (630) 577-9100

(Sheet 1 of 2)  
**BRIDGE APPROACH SLAB DETAILS**  
**STRUCTURE NO. 049-0059**

SHEET NO. S11 OF S20 SHEETS	F.A.P. RTE.	SECTION	COUNTY	TOTAL SHEETS	SHEET NO.
	303	136 B-1	LAKE	43	26
D-91-290-09			CONTRACT NO. 60F93		
FED. ROAD DIST. NO. _		ILLINOIS	FED. AID PROJECT		