

QUANTITY
 4 (100) LINE = 64.1 ft. (19.7 m)
 21.1 sq. ft. (1.97 sq. m)

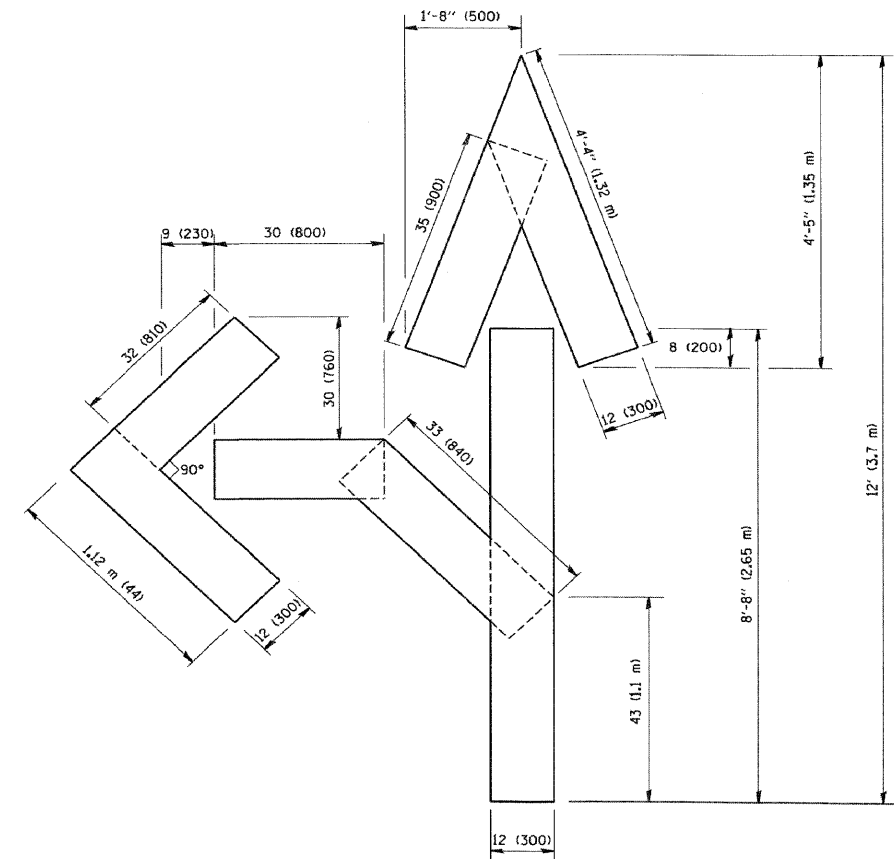

QUANTITY
 4 (100) LINE = 82.5 ft. (25.3 m)
 27.5 sq. ft. (2.53 sq. m)

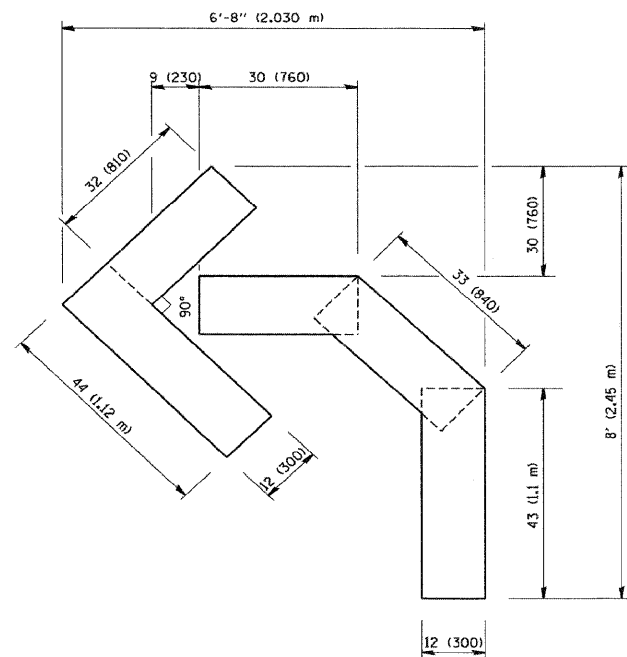

QUANTITY
 4 (100) LINE = 45.5 ft. (13.9 m)
 15.2 sq. ft. (1.39 sq. m)

REVISED	- T. RAMMACHER 06-05-96
REVISED	- T. RAMMACHER 11-04-97
REVISED	- T. RAMMACHER 03-02-98
REVISED	- E. GOMEZ 08-28-00

DISTRICT ONE TYPICAL PAVEMENT MARKINGS

LONCO, INC.
 CONSULTING ENGINEERS
 1560 WALL ST., SUITE 222
 NAPERVILLE, ILLINOIS 60563 PH: (630) 577-9100

DESIGNED - MJY
 DRAWN - ST, TSC
 CHECKED - MJY, SLV
 DATE - 06/25/2010

REVISED -
 REVISED -
 REVISED -

STATE OF ILLINOIS
 DEPARTMENT OF TRANSPORTATION

DISTRICT ONE DETAIL SHEETS
 IL ROUTE 173 OVER DES PLAINES RIVER

SCALE: NONE SHEET NO. 7 OF 8 SHEETS STA. 98+00 TO STA. 101+80

F.A.P. RTE.	SECTION	COUNTY	TOTAL SHEETS	SHEET NO.
303	136 B-1	LAKE	43	42
D-91-290-09			CONTRACT NO. 60F93	
FED. ROAD DIST. NO.		ILLINOIS FED. AID PROJECT		