

MATCHLINE STA. 1218+00.00

MATCHLINE STA. 1232+50.00

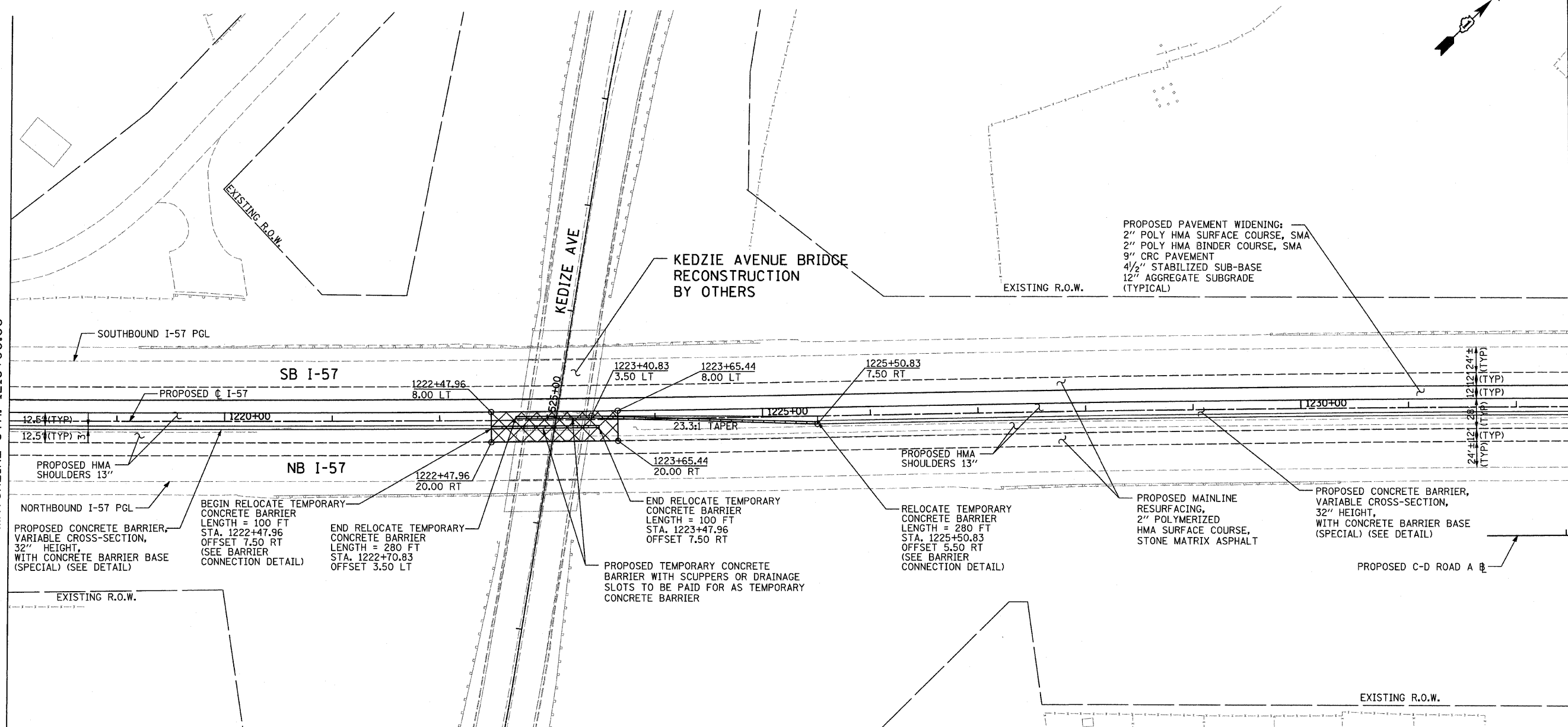

PROPOSED CONCRETE BARRIER, VARIABLE CROSS-SECTION, 32" HEIGHT, WITH CONCRETE BARRIER BASE (SPECIAL) (SEE DETAIL)

BEGIN RELOCATE TEMPORARY CONCRETE BARRIER LENGTH = 100 FT STA. 1222+47.96 OFFSET 7.50 RT (SEE BARRIER CONNECTION DETAIL)

END RELOCATE TEMPORARY CONCRETE BARRIER LENGTH = 280 FT STA. 1222+70.83 OFFSET 3.50 LT

PROPOSED TEMPORARY CONCRETE BARRIER WITH SCUPPERS OR DRAINAGE SLOTS TO BE PAID FOR AS TEMPORARY CONCRETE BARRIER

END RELOCATE TEMPORARY CONCRETE BARRIER LENGTH = 100 FT STA. 1223+47.96 OFFSET 7.50 RT

RELOCATE TEMPORARY CONCRETE BARRIER LENGTH = 280 FT STA. 1225+50.83 OFFSET 5.50 RT (SEE BARRIER CONNECTION DETAIL)

PROPOSED MAINLINE RESURFACING, 2" POLYMERIZED HMA SURFACE COURSE, STONE MATRIX ASPHALT

PROPOSED CONCRETE BARRIER, VARIABLE CROSS-SECTION, 32" HEIGHT, WITH CONCRETE BARRIER BASE (SPECIAL) (SEE DETAIL)

PROPOSED C-D ROAD A

LEGEND:

| | |
|--|--|
| | TEMPORARY PAVEMENT (TO REMAIN) |
| | RELOCATED TEMPORARY CONCRETE BARRIER (TO REMAIN) |
| | RELOCATED IMPACT ATTENUATOR (NON-REDIRECTIVE) DESIGN CRITERIA TEST LEVEL 3 (TO REMAIN) |

NOTES:
 PGL FOR NORTHBOUND AND SOUTHBOUND PROFILES IS LOCATED 56' RT OR LT, RESPECTIVELY, FROM I-57 CL

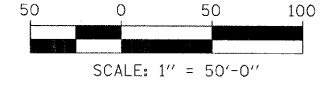
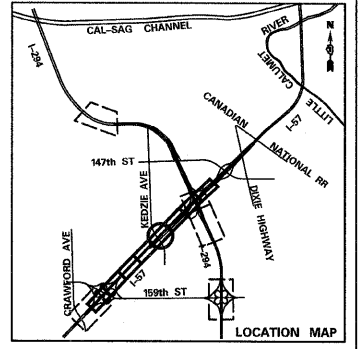

| | | | | | | | | | | | | |
|----------------------------|--------------|------------------|---------------------|---|--|---------|------|---------------------------|---------|--------|--------------|-----------|
| TYLIN INTERNATIONAL | USER NAME = | DESIGNED - CAC | REVISED - 4/29/2010 | STATE OF ILLINOIS DEPARTMENT OF TRANSPORTATION | I-57 AT I-294 INTERCHANGE PROJECT PROPOSED PLANS ALONG I-57 | | | F.A.I. RTE. | SECTION | COUNTY | TOTAL SHEETS | SHEET NO. |
| | PLOT SCALE = | DRAWN - CAC | REVISED - | | 57 | 1414.2B | COOK | 516 | 45 | | | |
| | PLOT DATE = | CHECKED - JDF | REVISED - | | SCALE: 1"=50' SHEET NO. 5 OF 8 SHEETS STA. 1218+00 TO STA. 1232+50 | | | CONTRACT NO. 60J27 | | | | |
| | | DATE - 3/18/2010 | REVISED - | | FED. ROAD DIST. NO. | | | ILLINOIS FED. AID PROJECT | | | | |