

P:\602540(57-294)\road\PI157 BR\PI_PP_SHT06.dgn

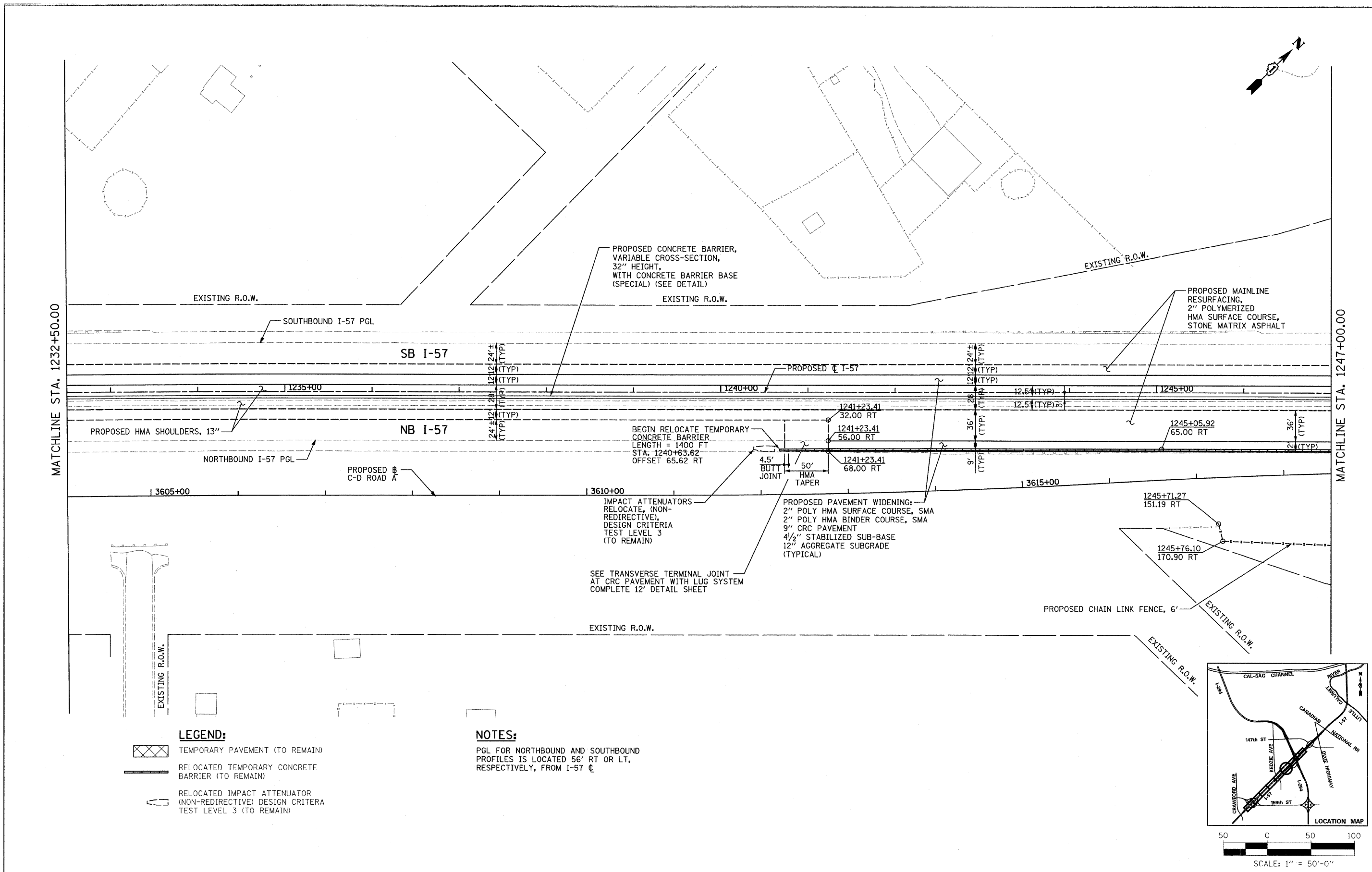

- LEGEND:**
- TEMPORARY PAVEMENT (TO REMAIN)
 - RELOCATED TEMPORARY CONCRETE BARRIER (TO REMAIN)
 - RELOCATED IMPACT ATTENUATOR (NON-REDIRECTIVE) DESIGN CRITERIA TEST LEVEL 3 (TO REMAIN)

NOTES:
 PGL FOR NORTHBOUND AND SOUTHBOUND PROFILES IS LOCATED 56' RT OR LT, RESPECTIVELY, FROM I-57 CL

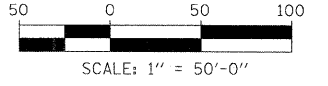
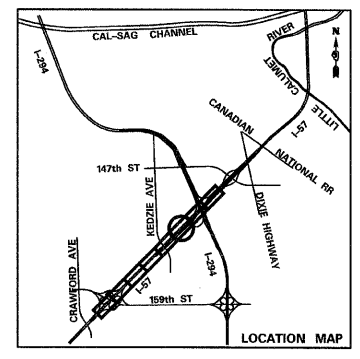

TYLIN INTERNATIONAL	USER NAME =	DESIGNED - CAC	REVISED - 4/29/2010	STATE OF ILLINOIS DEPARTMENT OF TRANSPORTATION	I-57 AT I-294 INTERCHANGE PROJECT PROPOSED PLANS ALONG I-57			F.A.I. RTE.	SECTION	COUNTY	TOTAL SHEETS	SHEET NO.
	PLOT SCALE =	DRAWN - CAC	REVISED -		57	1414.2B	COOK	516	46			
	PLOT DATE =	CHECKED - JDF	REVISED -		SCALE: 1"=50' SHEET NO. 6 OF 8 SHEETS STA. 1232+50 TO STA. 1247+00			CONTRACT NO. 60J27				
						FED. ROAD DIST. NO.		ILLINOIS FED. AID PROJECT				