

PLAN	SURVEYED	BY	DATE
	ALIGNED		
	RT. OF WAY CHECKED		
	DAU FILE NAME		

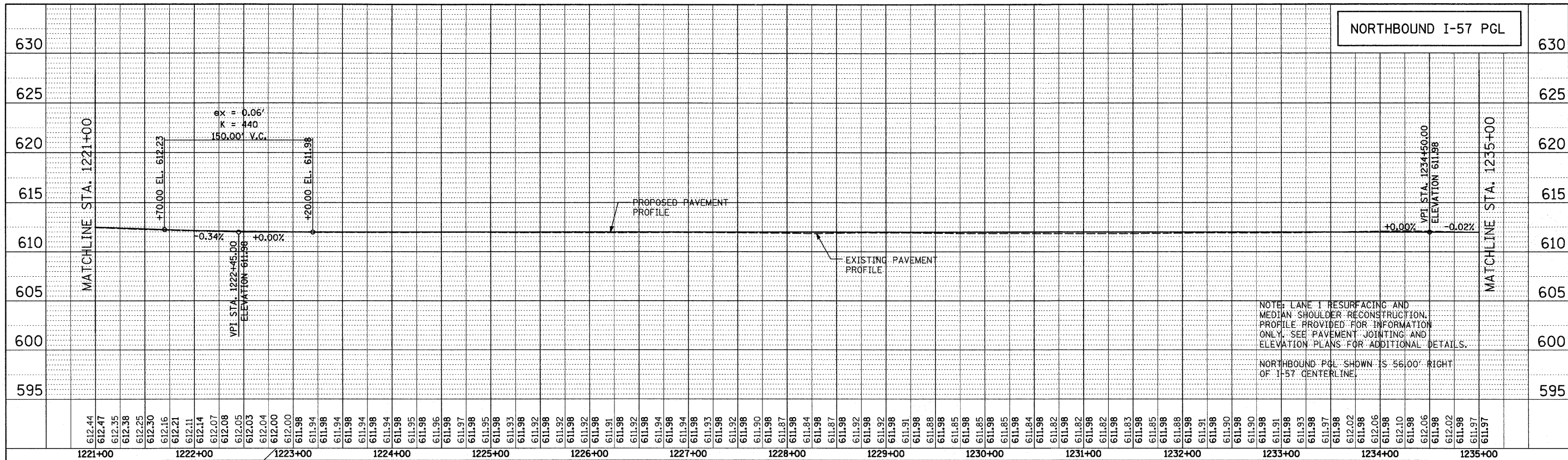

NOTE: LANE 1 RESURFACING AND MEDIAN SHOULDER RECONSTRUCTION. PROFILE PROVIDED FOR INFORMATION ONLY. SEE PAVEMENT JOINTING AND ELEVATION PLANS FOR ADDITIONAL DETAILS.

NORTHBOUND PGL SHOWN IS 56.00' RIGHT OF I-57 CENTERLINE.

PROFILE	SURVEYED	BY	DATE
	PLOTTED		
	STRUCTURE NOTATIONS CHKD		

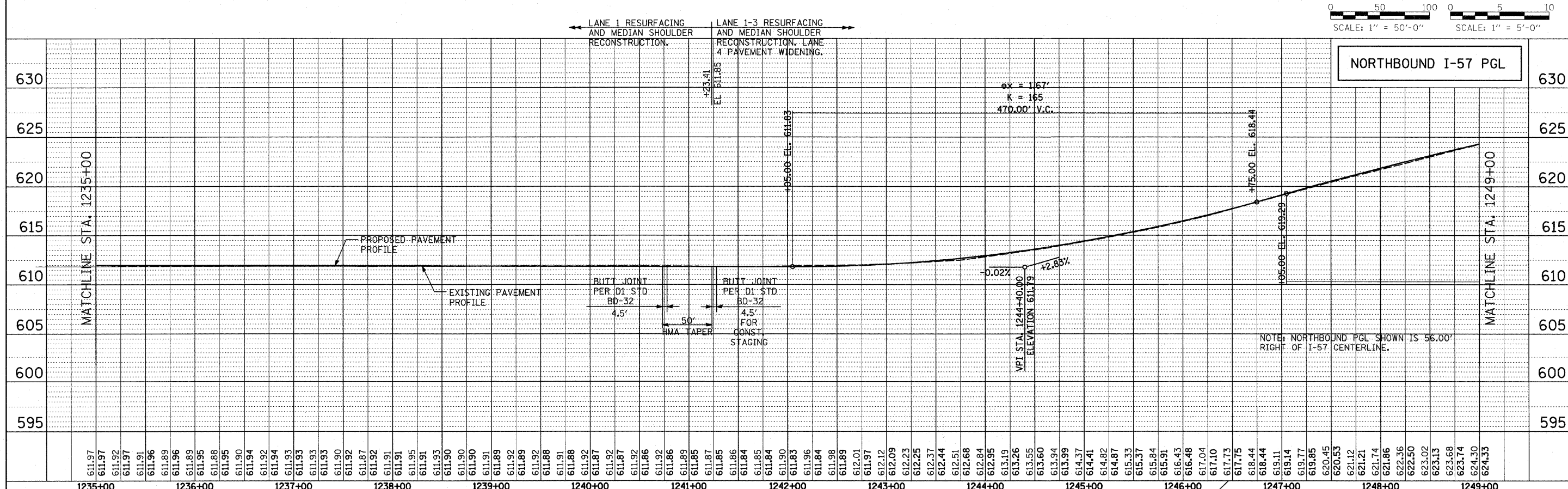

NOTE: NORTHBOUND PGL SHOWN IS 56.00' RIGHT OF I-57 CENTERLINE.

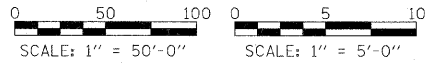

TYLIN INTERNATIONAL USER NAME = PLOT SCALE = PLOT DATE =	DESIGNED - CAC DRAWN - CAC CHECKED - JDF DATE - MARCH 18, 2010	REVISED - REVISED - REVISED - REVISED -	STATE OF ILLINOIS DEPARTMENT OF TRANSPORTATION			I-294 AT I-57 INTERCHANGE NORTHBOUND I-57 PROFILE			F.A.I. RTE. 57 SECTION 1414.2B COUNTY COOK TOTAL SHEETS 516 SHEET NO. 52	CONTRACT NO. 60J27
	SCALE: SHEET NO. 3 OF 4 SHEETS STA. 1221+00 TO STA. 1249+00		FED. ROAD DIST. NO. ILLINOIS FED. AID PROJECT							