

MAINTENANCE OF TRAFFIC GENERAL NOTES:

1. A WORK ZONE SPEED LIMIT OF 45 M.P.H MUST BE MAINTAINED AT ALL TIMES.
2. SEE SPECIAL PROVISION TITLED TRAFFIC CONTROL AND PROTECTION (SPECIAL) AND TRAFFIC CONTROL AND PROTECTION (EXPRESSWAY).
3. AGENCY JURISDICTION:
 INTERSTATE 57 (I-57) AND CD ROAD A ARE UNDER THE JURISDICTION OF THE ILLINOIS DEPARTMENT OF TRANSPORTATION (IDOT).
 INTERSTATE 294 (I-294) IS UNDER THE JURISDICTION OF THE ILLINOIS STATE TOLL HIGHWAY AUTHORITY (TOLLWAY).
4. THE CONTRACTOR SHALL COORDINATE MAINTENANCE OF TRAFFIC OF THIS PROJECT WITH OTHER PROJECTS IN ADJACENT CONTRACTS. SEE MAINTENANCE OF TRAFFIC SPECIAL PROVISION FOR COORDINATION REQUIREMENTS.
5. ALL TEMPORARY PAVEMENT (INTERSTATE) WITHIN IDOT JURISDICTION SHALL BE, AT THE OPTION OF THE CONTRACTOR, EITHER (1) 8" PORTLAND CEMENT CONCRETE BASE COURSE, OR (2) 9 1/2" HMA PAVEMENT CONSISTING OF 1 1/2" HOT-MIX ASPHALT SURFACE COURSE, MIX "D", N70 OVER 8" TEMPORARY PAVEMENT (INTERSTATE).
6. THE CONTRACTOR SHALL REMOVE, SAFELY STORE FREE FROM THEFT OR DAMAGE OR COVER ALL CONFLICTING EXISTING SIGNS FOR THE DURATION OF THE CONSTRUCTION, AND ALL SIGNS SHALL BE RESTORED TO PREVIOUS CONDITIONS AT THE END OF CONSTRUCTION.
7. THE FOLLOWING APPLY TO CONSTRUCTION SIGNS:
 - A) THE CONTRACTOR SHALL FURNISH ALL SIGNS.
 - B) THE CONTRACTOR SHALL BE RESPONSIBLE FOR AND REPLACE ANY SIGNS THAT ARE SUPPLIED BY OTHERS AND DAMAGED BY THE CONTRACTOR'S WORK FORCE OR SUBCONTRACTORS DURING RELOCATION OR CONSTRUCTION OPERATIONS.
 - C) ALL SIGNS AND ASSEMBLIES SHALL BE CERTIFIED BY THE CONTRACTOR AS MEETING THE APPLICABLE REQUIREMENTS OF NCHRP REPORT 350, TEST LEVEL 3.
 - D) ALL SIGNS SHALL BE CONSIDERED INCLUDED IN THE TRAFFIC CONTROL AND PROTECTION (EXPRESSWAYS) PAY ITEM X7011015, EXCEPT FOR TEMPORARY INFORMATIONAL SIGNING AS NOTED ON THE PLANS.
8. OPENING THROUGH THE BARRIER FOR CONTRACTOR'S ACCESS TO WORK ZONE WILL BE PROVIDED AS APPROVED BY THE ENGINEER. SEE 'WORK ZONE OPENING DETAIL' SHEET 127.
9. TEMPORARY CONCRETE BARRIER WALL THAT IS TO REMAIN IN PLACE AFTER THE CONSTRUCTION OF THIS CONTRACT SHALL BE PLACED IN STAGE 2 AND PAID FOR AS "TEMPORARY CONCRETE BARRIER (SPECIAL)". ALL SUBSEQUENT RELOCATIONS OF THIS BARRIER WALL WILL BE PAID FOR AS "RELOCATE TEMPORARY CONCRETE BARRIER WALL".
10. THERE IS 940 FT OF TEMPORARY CONCRETE BARRIER (STATE OWNED) BETWEEN STA. 1264+00 AND STA. 1273+00. THE CONTRACTOR SHALL REMOVE IT FROM THE SITE PER 'REMOVE TEMPORARY CONCRETE BARRIER, STATE OWNED' SPECIAL PROVISION.
11. THRIE BEAM SHALL BE PROVIDED TO CLOSE THE GAP BETWEEN EXISTING AND PROPOSED CONCRETE BARRIER MEDIAN ON I-294 DURING THE WINTER SHUTDOWN STAGES. FOR QUANTITY PURPOSES, THRIE BEAM LENGTH OF 15 FT INCLUDING THE END SHOES HAS BEEN PROVIDED FOR EACH NECESSARY LOCATION. THE CONTRACTOR MAY SHORTEN THIS AMOUNT AS NEEDED TO CLOSE THE GAP.
12. ANY RAISED REFLECTIVE PAVEMENT MARKINGS THAT CONFLICT WITH THE TEMPORARY TRAFFIC LANES MUST HAVE THE RELECTIVE LENSES REMOVED AS DIRECTED BY THE RESIDENT ENGINEER. REPLACEMENT REFLECTORS SHALL BE PLACED INTO THE CASTINGS DURING THE WINTER SHUTDOWN PERIODS.
13. A 'BOXED' NOTE INDICATES AN ITEM OF WORK THAT IS NOT PAID FOR SEPARATELY, BUT IS PAID FOR AS PART OF ANOTHER ITEM LISTED IN THE SUMMARY OF QUANTITIES.
14. MAINLINE I-57 TO BE OVERLAYED FOLLOWING MEDIAN CONSTRUCTION. CONTRACTOR SHALL VARY OVERLAY CROSS SLOPE TO MATCH PROPOSED MEDIAN ELEVATIONS AND EXISTING MAINLINE ELEVATIONS.
15. ALL TEMPORARY PAVEMENT MARKINGS ALONG I-57 DURING STAGES 1, 2 AND 3, SHALL BE WET REFLECTIVE TAPE, TYPE III OF THE WIDTH AND COLOR SPECIFIED ON THE PLAN SHEETS. PAVEMENT MARKINGS ALONG I-57 FOR THE WINTER SHUTDOWN STAGES SHALL BE EPOXY OF THE WIDTH AND COLOR SPECIFIED ON THE PLAN SHEETS.
16. ALL EXISTING PAVEMENT MARKINGS ALONG I-294 WITHIN THE MAINTENANCE OF TRAFFIC WORK AREA SHALL BE COVERED WITH PAVEMENT MARKING TAPE (BLACK). TAPERS SHALL BE PLACED USING WET REFLECTIVE TEMPORARY TAPE, TYPE III OF THE COLOR AND WIDTH SPECIFIED IN THE PLANS.
17. THE QUANTITY FOR TEMPORARY PAVEMENT MARKING - LINE 6" WAS ASSUMED EQUAL TO THE LENGTH OF THE TEMPORARY CONCRETE BARRIER ALONG I-57. UTILIZED WHEN THE BARRIER IS LOCATED WITHIN 1 FT OR LESS FROM THE EDGE OF TRAVELED WAY.
18. MONO-DIRECTIONAL PRISMATIC BARRIER REFLECTORS WILL BE PLACED AT 25' CENTERS ON TOP AND SIDE OF TEMPORARY CONCRETE BARRIER FACING TRAFFIC.

TEMPORARY CONCRETE BARRIER SCHEDULE

	TEMPORARY CONCRETE BARRIER (FT)	TEMPORARY CONCRETE BARRIER (SPECIAL) (FT)	RELOCATE TEMPORARY CONCRETE BARRIER (FT)	REMOVAL AT END OF STAGE (FT)
I-57 STAGE 1	3,120			
I-57 WINTER SHUTDOWN I			3,120	
I-57 STAGE 2	18,050	3,790*	3,120	17,530
I-57 WINTER SHUTDOWN II			7,050	
I-57 STAGE 3			7,050	3,640
I-57 FINAL CONDITION			3,790**	
I-294 OUTER PIER WORK ZONE	1,340			
I-294 INNER PIER WORK ZONE			1,340	1,340
I-294 WINTER SHUTDOWN				
I-294 INNER PIER WORK ZONE	1,340			
I-294 OUTER PIER WORK ZONE			1,340	1,340
I-294 WINTER SHUTDOWN				
I-294 OUTER PIER WORK ZONE	1,340			
I-294 INNER PIER WORK ZONE			1,340	1,340

- * SEE NOTE 9.
- ** 380 FT WILL BE RELOCATED TO THE FINAL CONDITION AFTER STAGE 2 TO CLOSE THE GAP CREATED IN BARRIER WALL UNDER THE KEDZIE BRIDGE.

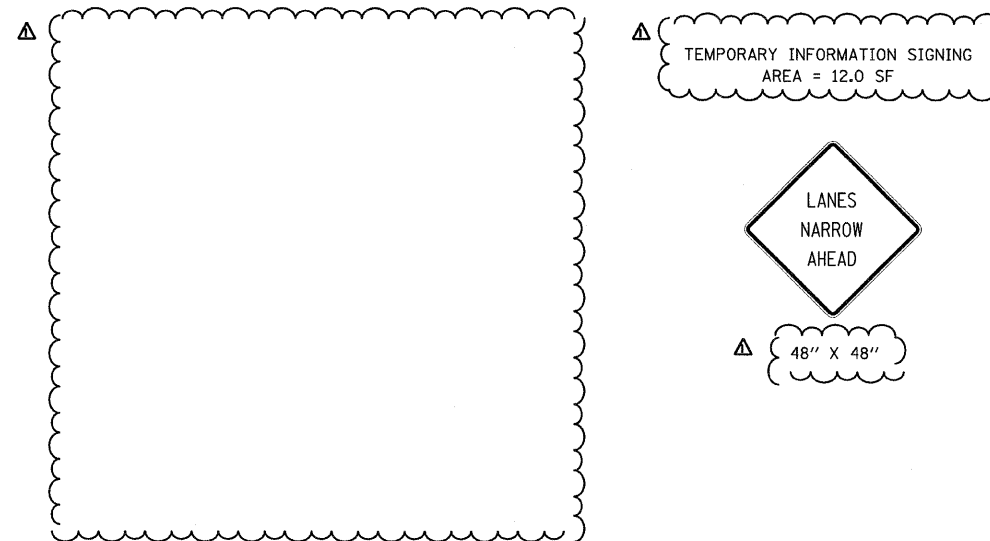

TYLIN INTERNATIONAL USER NAME = PLOT SCALE = PLOT DATE =	DESIGNED - DM	REVISED - 4/29/2010	STATE OF ILLINOIS DEPARTMENT OF TRANSPORTATION				I-57 AT I-294 INTERCHANGE PROJECT MAINTENANCE OF TRAFFIC GENERAL NOTES				F.A.I. RTE.	SECTION	COUNTY	TOTAL SHEETS	SHEET NO.		
	DRAWN - DM	REVISED Δ- ADDENDUM 1 05/24/10									57	1414.2B	COOK	516	91		
	CHECKED - JPM	REVISED -									SCALE:		SHEET NO. 1 OF 1 SHEETS	STA.	TO STA.	CONTRACT NO. 60J27	
	DATE - 3/18/2010	REVISED -									FED. ROAD DIST. NO.		ILLINOIS FED. AID PROJECT				