

MATCHLINE STA. 403+50.00

MATCHLINE STA. 418+00.00

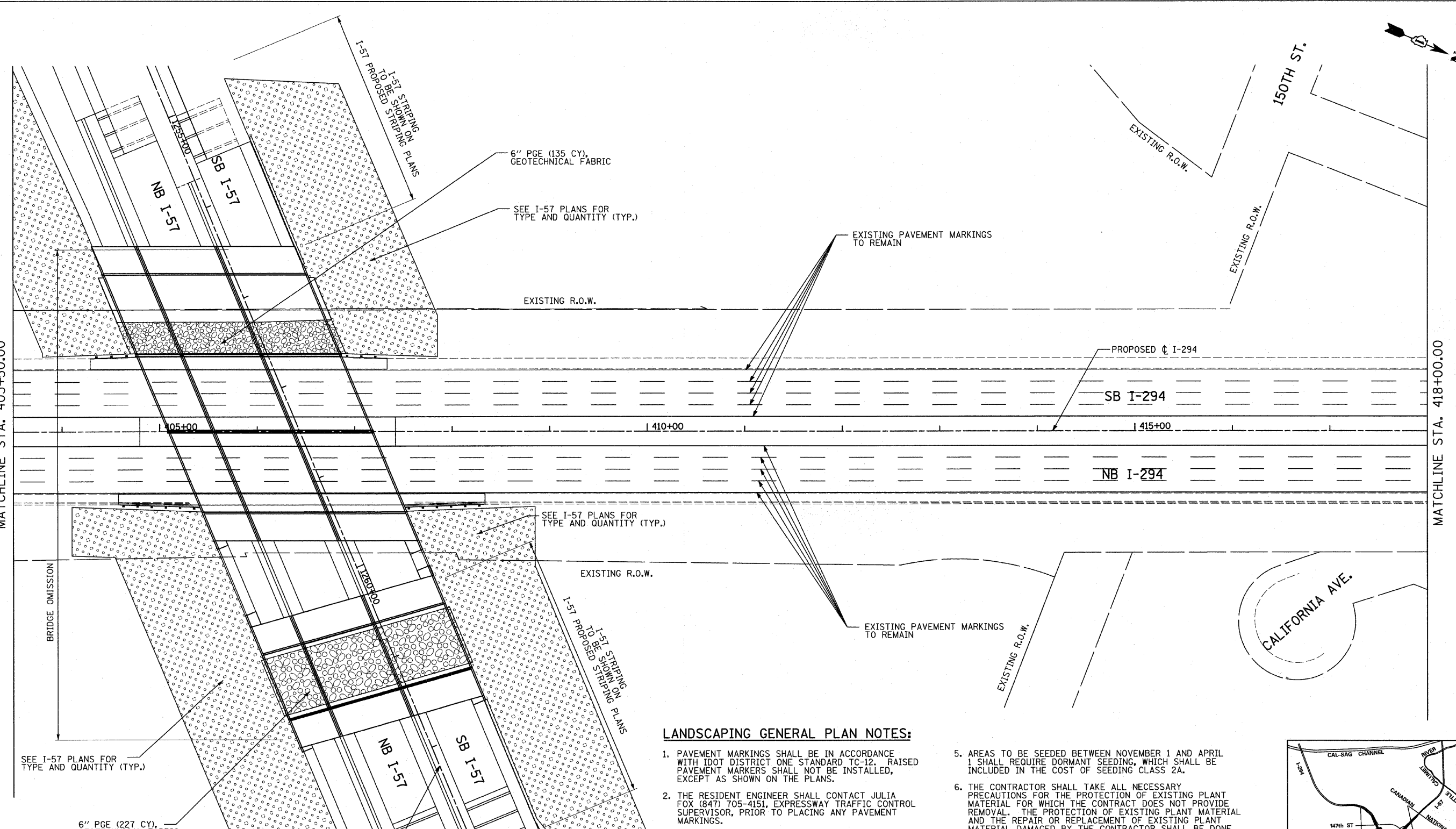

SEE I-57 PLANS FOR TYPE AND QUANTITY (TYP.)

6" PGE (227 CY) GEOTECHNICAL FABRIC

6" PGE (135 CY) GEOTECHNICAL FABRIC

SEE I-57 PLANS FOR TYPE AND QUANTITY (TYP.)

EXISTING R.O.W.

SEE I-57 PLANS FOR TYPE AND QUANTITY (TYP.)

EXISTING R.O.W.

BRIDGE OMISSION

SEE I-57 PLANS FOR TYPE AND QUANTITY (TYP.)

**LEGEND:**

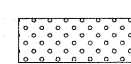

 EROSION CONTROL BLANKET, SEEDING CLASS 2A, NITROGEN, PHOSPHORUS, AND POTASSIUM FERTILIZER NUTRIENTS, TOPSOIL FURNISH AND PLACE, 4"

**PAVEMENT MARKING GENERAL PLAN NOTES:**

1. PAVEMENT MARKING TAPE (BLACK) SHALL BE USED TO COVER EXISTING PAVEMENT MARKINGS DURING MAINTENANCE OF TRAFFIC OPERATIONS. THE CONTRACTOR SHALL REMOVE ALL PAVEMENT MARKING TAPE (BLACK) TAPE FOR THE FINAL CONDITION TO EXPOSE THE EXISTING PAVEMENT MARKINGS.

**LANDSCAPING GENERAL PLAN NOTES:**

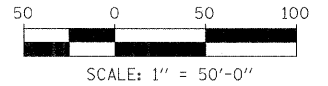
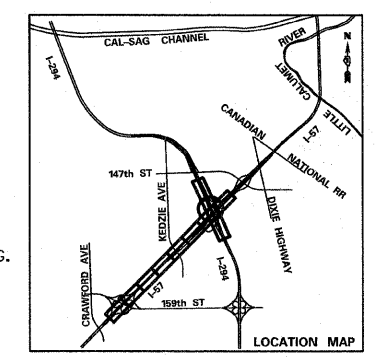
1. PAVEMENT MARKINGS SHALL BE IN ACCORDANCE WITH IDOT DISTRICT ONE STANDARD TC-12. RAISED PAVEMENT MARKERS SHALL NOT BE INSTALLED, EXCEPT AS SHOWN ON THE PLANS.
2. THE RESIDENT ENGINEER SHALL CONTACT JULIA FOX (847) 705-4151, EXPRESSWAY TRAFFIC CONTROL SUPERVISOR, PRIOR TO PLACING ANY PAVEMENT MARKINGS.
3. THE CONTRACTOR SHALL USE CARE IN GRADING OR EXCAVATING NEAR ANY AND ALL EXISTING ITEMS WHICH WILL NOT BE REMOVED. ANY DAMAGE DONE TO EXISTING ITEMS BY THE CONTRACTOR SHALL BE REPAIRED BY THE CONTRACTOR AT THE CONTRACTOR'S EXPENSE.
4. THE SEEDING DATES FOR BARE EARTH SEEDING OF MIXTURE CLASS 2A SHALL BE FROM APRIL 1 TO JUNE 1 AND FROM AUGUST 15 TO SEPTEMBER 30. ALL SEEDING NOT SOWN ACCORDING TO THE SPECIFIED SEASONAL DATE SHALL REQUIRE PRIOR WRITTEN APPROVAL FROM THE ENGINEER. FAILURE TO SECURE SUCH APPROVAL SHALL RESULT IN THE REJECTION OF THE SEEDING AND REPLACEMENT BY THE CONTRACTOR AS HIS/HER EXPENSE.
5. AREAS TO BE SEEDED BETWEEN NOVEMBER 1 AND APRIL 1 SHALL REQUIRE DORMANT SEEDING, WHICH SHALL BE INCLUDED IN THE COST OF SEEDING CLASS 2A.
6. THE CONTRACTOR SHALL TAKE ALL NECESSARY PRECAUTIONS FOR THE PROTECTION OF EXISTING PLANT MATERIAL FOR WHICH THE CONTRACT DOES NOT PROVIDE REMOVAL. THE PROTECTION OF EXISTING PLANT MATERIAL AND THE REPAIR OR REPLACEMENT OF EXISTING PLANT MATERIAL DAMAGED BY THE CONTRACTOR SHALL BE DONE IN ACCORDANCE WITH THE REQUIREMENTS OF SECTION 201 OF THE STANDARD SPECIFICATIONS.
7. LAYOUT OF LANDSCAPED AREAS WILL REQUIRE APPROVAL OF THE ENGINEER PRIOR TO TOPSOIL PLACEMENT, SEEDING, AND PLANTING.



<b>TYLIN INTERNATIONAL</b>	USER NAME =	DESIGNED - EMK	REVISED -	<b>STATE OF ILLINOIS DEPARTMENT OF TRANSPORTATION</b>	<b>I-57 AT I-294 INTERCHANGE PROJECT PAVEMENT MARKING AND LANDSCAPING PLANS</b>			F.A.I. RTE. =	SECTION	COUNTY	TOTAL SHEETS	SHEET NO.
	PLOT SCALE =	DRAWN - EMK	REVISED -		57	1414.2B	COOK	516	200			
	PLOT DATE =	CHECKED - JPM	REVISED -		CONTRACT NO. 60J27							
		DATE - 3/18/2010	REVISED -		FED. ROAD DIST. NO. ILLINOIS FED. AID PROJECT							
				SCALE: 1"=50'	SHEET NO. 10 OF 10 SHEETS	STA. 403+50 TO STA. 418+00						