

MATCHLINE STA. 1247+00.00

MATCHLINE STA. 1261+50.00

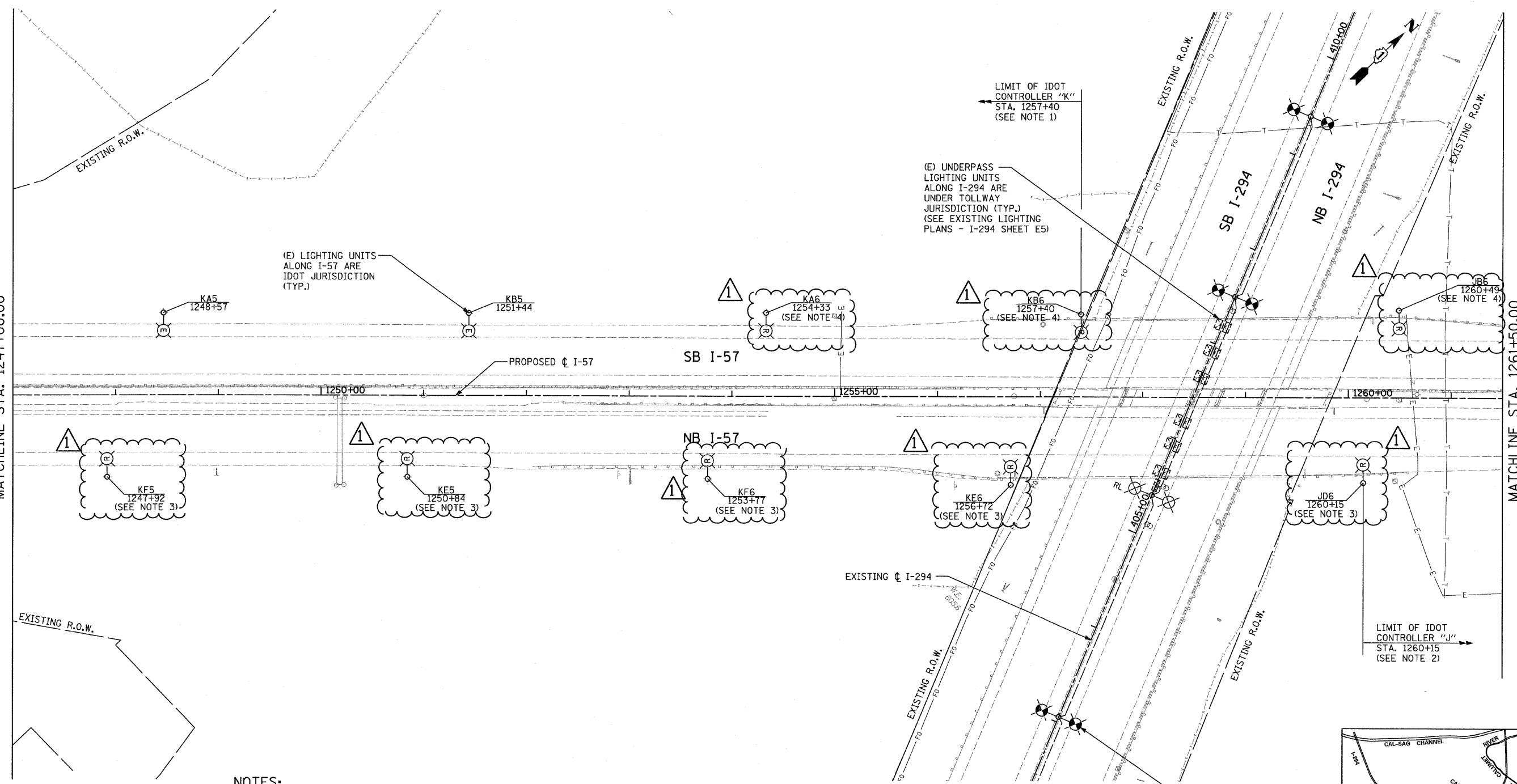

- NOTES:**
1. IDOT LIGHTING CONTROLLER "K" IS LOCATED AT I-57 STA. 1238+45 ALONG SB I-57.
  2. IDOT LIGHTING CONTROLLER "J" IS LOCATED AT I-57 STA. 1286+79 ALONG NB I-57 ON 147TH STREET.
  3. POLE NOT TO BE REMOVED UNTIL TEMPORARY POLES ARE ENERGIZED (STAGE 2).
  4. POLE NOT TO BE REMOVED UNTIL HIGH MAST LIGHT TOWERS ARE ENERGIZED (AFTER STAGE 2).

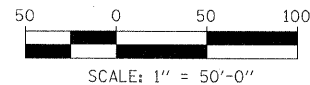
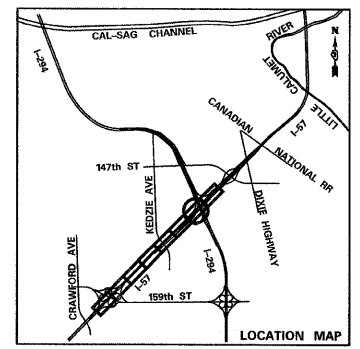

|                            |              |                  |  |
|----------------------------|--------------|------------------|--|
| <b>TYLIN INTERNATIONAL</b> | USER NAME =  | DESIGNED - JDF   | REVISED $\Delta$ - ADDENDUM 1 05/24/10 |
|                            | PLOT SCALE = | DRAWN - JDF      | REVISED -                              |
|                            | PLOT DATE =  | CHECKED - DAJ    | REVISED -                              |
|                            |              | DATE - 3/18/2010 | REVISED -                              |

**STATE OF ILLINOIS  
DEPARTMENT OF TRANSPORTATION**

**I-57 AT I-294 INTERCHANGE PROJECT  
EXISTING LIGHTING AND REMOVAL PLAN - I-57**

|                    |                 |             |                           |               |
|--------------------|-----------------|-------------|---------------------------|---------------|
| F.A.I. RTE. 57     | SECTION 1414.2B | COUNTY COOK | TOTAL SHEETS 516          | SHEET NO. 203 |
| CONTRACT NO. 60J27 |                 |             | ILLINOIS FED. AID PROJECT |               |