

STATE OF ILLINOIS
DEPARTMENT OF TRANSPORTATION

NORTH EDGE OF SHOULDER - SB I-57

Location	Station	Offset	Theoretical Grade Elevations
End W. Appr. Pav't	1260+37.80	-12.00	634.88
A	1260+47.80	-12.00	634.84
B	1260+57.80	-12.00	634.79
Begin W. Appr. Pav't	1260+67.80	-12.00	634.73

P.G.L - SB I-57

Location	Station	Offset	Theoretical Grade Elevations
End W. Appr. Pav't	1260+36.36	0.00	635.14
A	1260+46.36	0.00	635.09
B	1260+56.36	0.00	635.04
Begin W. Appr. Pav't	1260+66.36	0.00	634.99

CROWN - SB I-57

Location	Station	Offset	Theoretical Grade Elevations
End W. Appr. Pav't	1260+34.93	12.00	635.33
A	1260+44.93	12.00	635.29
B	1260+54.93	12.00	635.24
Begin W. Appr. Pav't	1260+64.93	12.00	635.19

CROSS SLOPE BREAK - SB I-57

Location	Station	Offset	Theoretical Grade Elevations
End W. Appr. Pav't	1260+33.50	24.00	635.15
A	1260+43.50	24.00	635.11
B	1260+53.50	24.00	635.06
Begin W. Appr. Pav't	1260+63.50	24.00	635.01

SOUTH EDGE OF PAVEMENT - SB I-57

Location	Station	Offset	Theoretical Grade Elevations
End W. Appr. Pav't	1260+30.63	48.00	634.67
A	1260+40.63	48.00	634.62
B	1260+50.63	48.00	634.57
Begin W. Appr. Pav't	1260+60.63	48.00	634.52

SOUTH EDGE OF SHOULDER - SB I-57

Location	Station	Offset	Theoretical Grade Elevations
End W. Appr. Pav't	1260+29.13	60.50	634.41
A	1260+39.13	60.50	634.37
B	1260+49.13	60.50	634.32
Begin W. Appr. Pav't	1260+59.13	60.50	634.27

NORTH EDGE OF SHOULDER - NB I-57

Location	Station	Offset	Theoretical Grade Elevations
End W. Appr. Pav't	1260+28.78	-48.50	634.57
A	1260+38.78	-48.50	634.52
B	1260+48.78	-48.50	634.47
Begin W. Appr. Pav't	1260+58.78	-48.50	634.42

NORTH EDGE OF PAVEMENT - NB I-57

Location	Station	Offset	Theoretical Grade Elevations
End W. Appr. Pav't	1260+27.29	-36.00	634.83
A	1260+37.29	-36.00	634.79
B	1260+47.29	-36.00	634.74
Begin W. Appr. Pav't	1260+57.29	-36.00	634.69

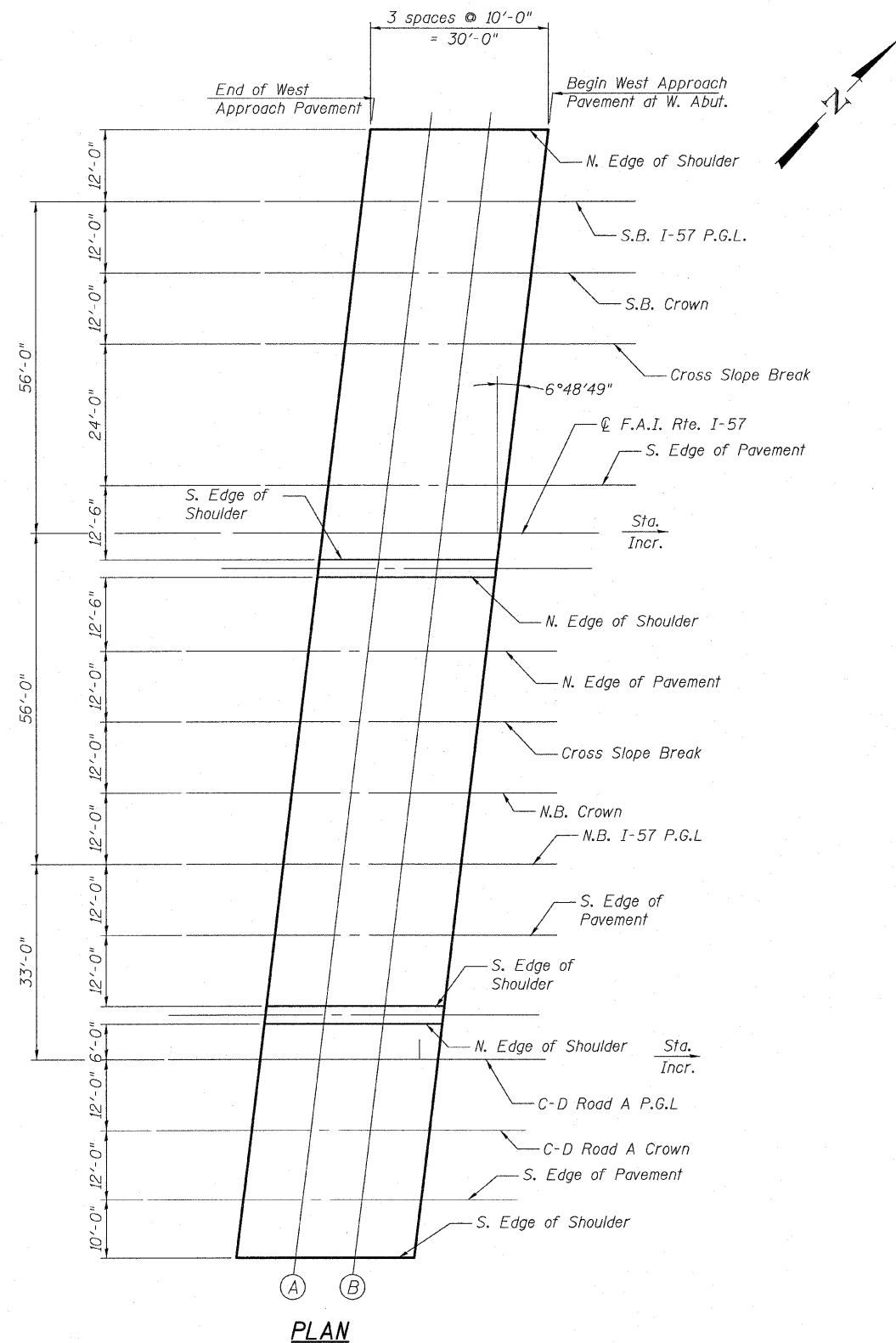

PLAN

TOP OF WEST APPROACH SLAB ELEVATIONS - 1
SN. 016-1252

TYLIN INTERNATIONAL	DESIGNED - DY	REVISIONS		SHEET NO. 13	F.A.I. RTE. 57	SECTION 1414.2B	COUNTY COOK	TOTAL SHEETS 516	SHEET NO. 326
	CHECKED - AD,LS	NAME	DATE						
	DRAWN - DY,EI								
	CHECKED - LS,SP,PDF								
	DATE - 03/18/10								
				62 SHEETS	CONTRACT NO. 60J27				
				FED. ROAD DIST. NO. 1 ILLINOIS FED. AID PROJECT					

P:\60254057-294\STRUCTURAL\I-57 OVER RAMP.BX\Final_Submittal_03-17-2010\Final_Submittal_03172010\0161252-60J27-013-W.TOP_APPR_ELEV1.dgn 9:53:52 AM 3/18/2010