

STATE OF ILLINOIS  
DEPARTMENT OF TRANSPORTATION

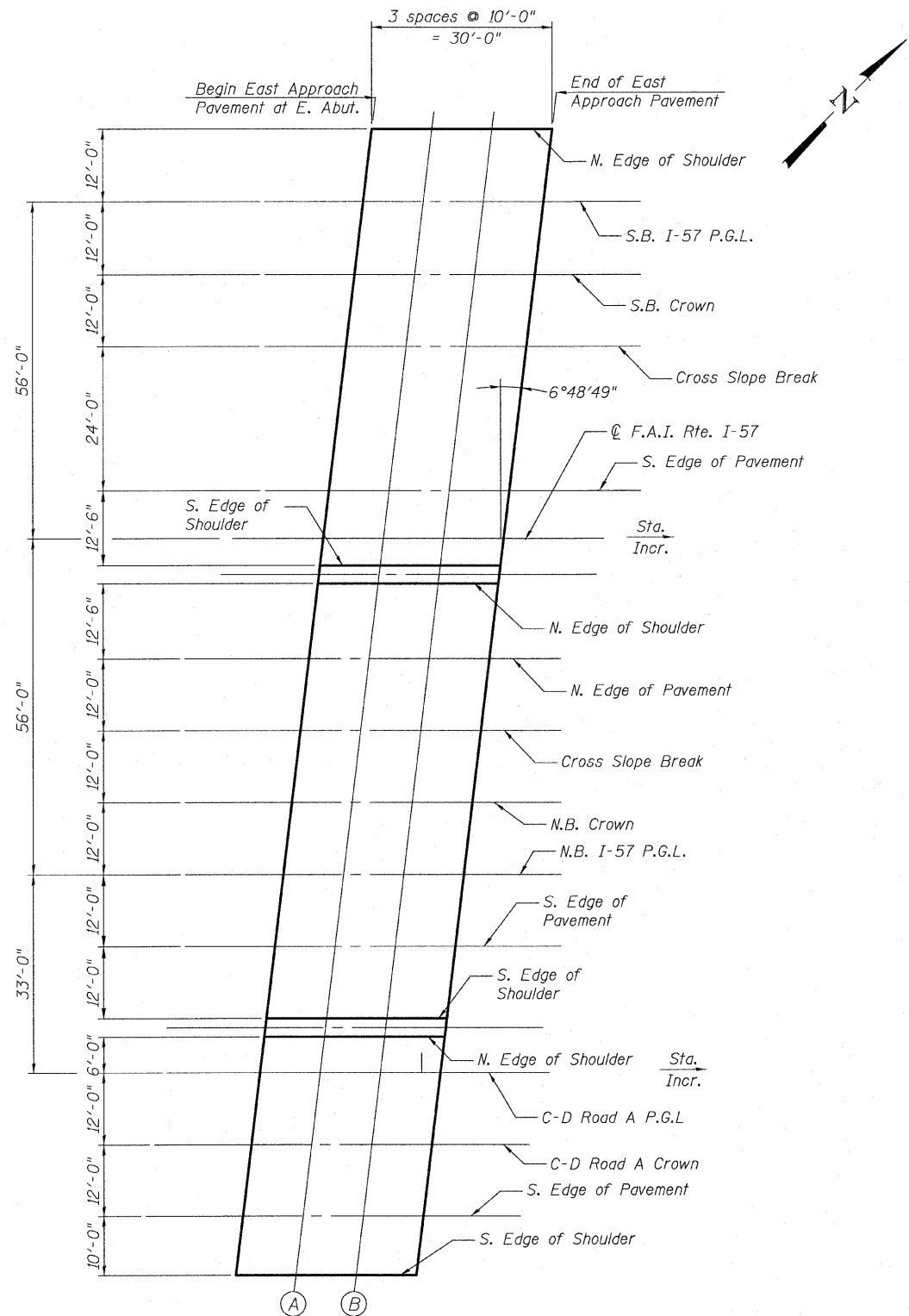

PLAN

**NORTH EDGE OF SHOULDER - SB I-57**

Location	Station	Offset	Theoretical Grade Elevations
Begin E. Appr. Pav't	1261+41.68	-12.00	634.27
A	1261+51.68	-12.00	634.20
B	1261+61.68	-12.00	634.12
End E. Appr. Pav't	1261+71.68	-12.00	634.05

**P.G.L. - SB I-57**

Location	Station	Offset	Theoretical Grade Elevations
Begin E. Appr. Pav't	1261+40.25	0.00	634.53
A	1261+50.25	0.00	634.46
B	1261+60.25	0.00	634.38
End E. Appr. Pav't	1261+70.25	0.00	634.31

**CROWN - SB I-57**

Location	Station	Offset	Theoretical Grade Elevations
Begin E. Appr. Pav't	1261+38.81	12.00	634.73
A	1261+48.81	12.00	634.66
B	1261+58.81	12.00	634.58
End E. Appr. Pav't	1261+68.81	12.00	634.51

**CROSS SLOPE BREAK - SB I-57**

Location	Station	Offset	Theoretical Grade Elevations
Begin E. Appr. Pav't	1261+37.38	24.00	634.55
A	1261+47.38	24.00	634.48
B	1261+57.38	24.00	634.41
End E. Appr. Pav't	1261+67.38	24.00	634.33

**SOUTH EDGE OF PAVEMENT - SB I-57**

Location	Station	Offset	Theoretical Grade Elevations
Begin E. Appr. Pav't	1261+34.51	48.00	634.07
A	1261+44.51	48.00	634.00
B	1261+54.51	48.00	633.93
End E. Appr. Pav't	1261+64.51	48.00	633.85

**SOUTH EDGE OF SHOULDER - SB I-57**

Location	Station	Offset	Theoretical Grade Elevations
Begin E. Appr. Pav't	1261+33.02	60.50	633.82
A	1261+43.02	60.50	633.75
B	1261+53.02	60.50	633.68
End E. Appr. Pav't	1261+63.02	60.50	633.60

**NORTH EDGE OF SHOULDER - NB I-57**

Location	Station	Offset	Theoretical Grade Elevations
Begin E. Appr. Pav't	1261+32.65	-48.50	633.97
A	1261+42.65	-48.50	633.90
B	1261+52.65	-48.50	633.83
End E. Appr. Pav't	1261+62.65	-48.50	633.75

**NORTH EDGE OF PAVEMENT - NB I-57**

Location	Station	Offset	Theoretical Grade Elevations
Begin E. Appr. Pav't	1261+31.16	-36.00	634.24
A	1261+41.16	-36.00	634.17
B	1261+51.16	-36.00	634.10
End E. Appr. Pav't	1261+61.16	-36.00	634.02

**TOP OF EAST APPROACH SLAB ELEVATIONS - 1**  
**SN. 016-1252**

**TYLIN** INTERNATIONAL

DESIGNED	BY	REVISIONS	
CHECKED	AD,LS	NAME	DATE
DRAWN	DY,EI		
CHECKED	LS,SP,PDF		
DATE	03/18/10		

SHEET NO. 15	F.A.I. RTE. 57	SECTION 1414.2B	COUNTY COOK	TOTAL SHEETS 516	SHEET NO. 328
62 SHEETS	CONTRACT NO. 60J27			FED. ROAD DIST. NO. 1 ILLINOIS FED. AID PROJECT	

P:\6202540\57-294\STRUCTURAL\1-57 OVER RAMP.BX\Final submittal\_03-17-2010\Final submittal\_03172010\0161252-60J27-015-E.TOP\_APPR-ELEV.dgn 9:53:55 AM 3/18/2010