

DETAIL "A"

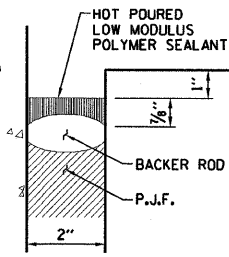

DETAIL "AA"

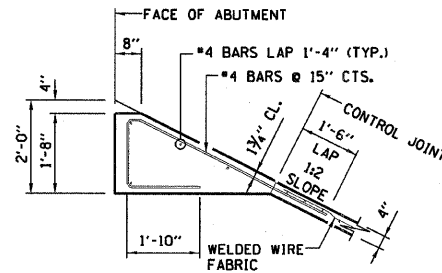

DETAIL "B"

NOTE:

SEALANT, BACKER ROD AND PJF SHALL MEET THE REQUIREMENTS OF SECTIONS 1050 AND 1051 OF THE IDOT STANDARD SPECIFICATIONS.

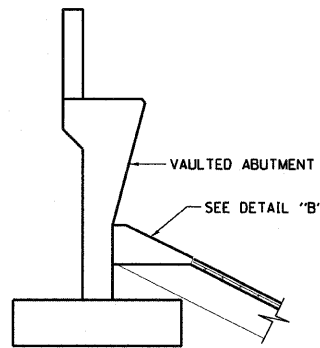

AT VAULTED ABUTMENT

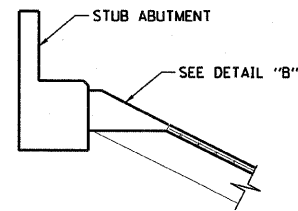

AT STUB ABUTMENT

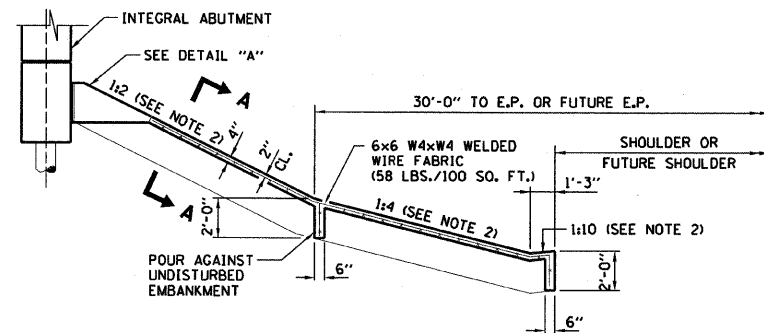

AT INTEGRAL ABUTMENT

SLOPE WALLS FOR BRIDGES OVER TOLLWAY

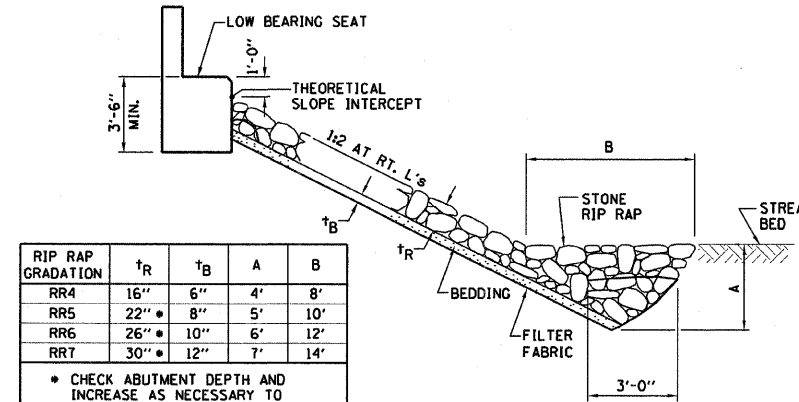

| RIP RAP GRADATION | t _R | t _B | A | B |
|-------------------|----------------|----------------|----|-----|
| RR4 | 16" | 6" | 4' | 8' |
| RR5 | 22" | 8" | 5' | 10' |
| RR6 | 26" | 10" | 6' | 12' |
| RR7 | 30" | 12" | 7' | 14' |

* CHECK ABUTMENT DEPTH AND INCREASE AS NECESSARY TO MATCH DEPTH OF RIP RAP

STONE RIPRAP FOR TOLLWAY BRIDGES OVER WATERWAYS

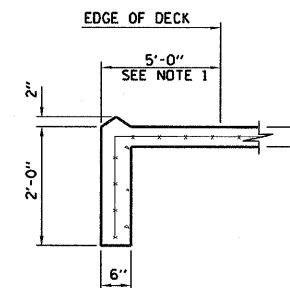

SECTION A-A

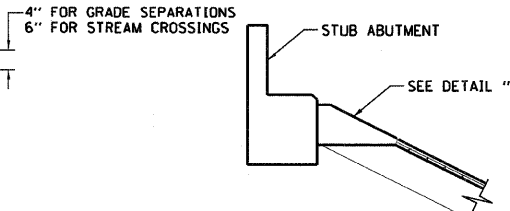

AT STUB ABUTMENT

NOTE:

SEE ROADWAY PLANS FOR DIMENSION "X" MEASURED NORMAL TO E.P.

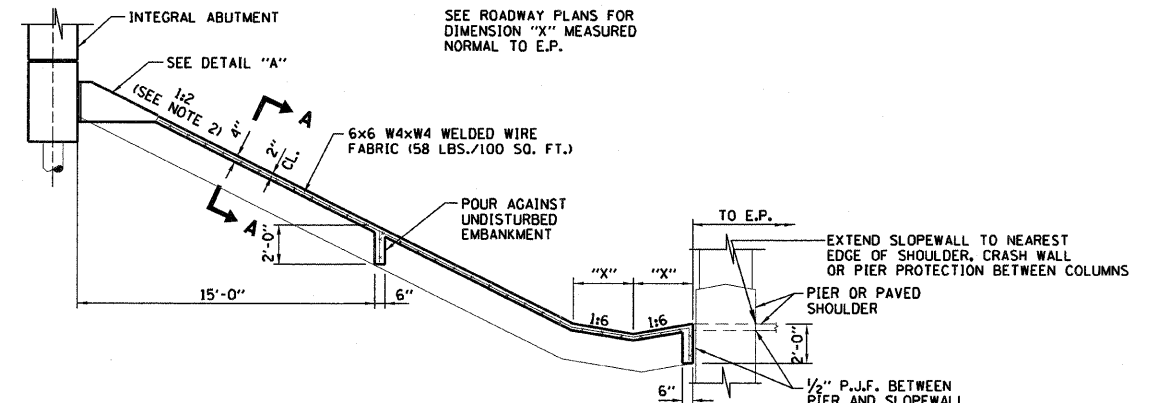

AT INTEGRAL ABUTMENT

TOLLWAY BRIDGES OVER CROSSROADS

NOTES:

1. DIMENSIONS SHALL BE 2'-0" IF DECK DRAINS ARE NOT PROVIDED.
2. DIMENSIONS MARKED THUS ARE MEASURED NORMAL TO E.P.
3. ALL SLOPES ARE EXPRESSED AS UNITS OF VERTICAL DISPLACEMENT TO UNITS OF HORIZONTAL DISPLACEMENT (V:H).

APPROVED *Paul Kovacs* CHIEF ENGINEER DATE 6-1-2009

| DATE | REVISIONS |
|----------|---------------|
| 6-1-2009 | REVISED NOTES |
| | |
| | |

Illinois Tollway
Open Roads for a Faster Future

SLOPEWALL DETAILS

STANDARD G2-01