

DATE	
BY	
ORIGINAL SURVEY	
FINAL SURVEY	
PLOTTED	
TEMPLATE	
NOTE BOOK	
AREAS CHECKED	
NO.	

DATE	
BY	
ORIGINAL SURVEY	
FINAL SURVEY	
PLOTTED	
TEMPLATE	
NOTE BOOK	
AREAS CHECKED	
NO.	

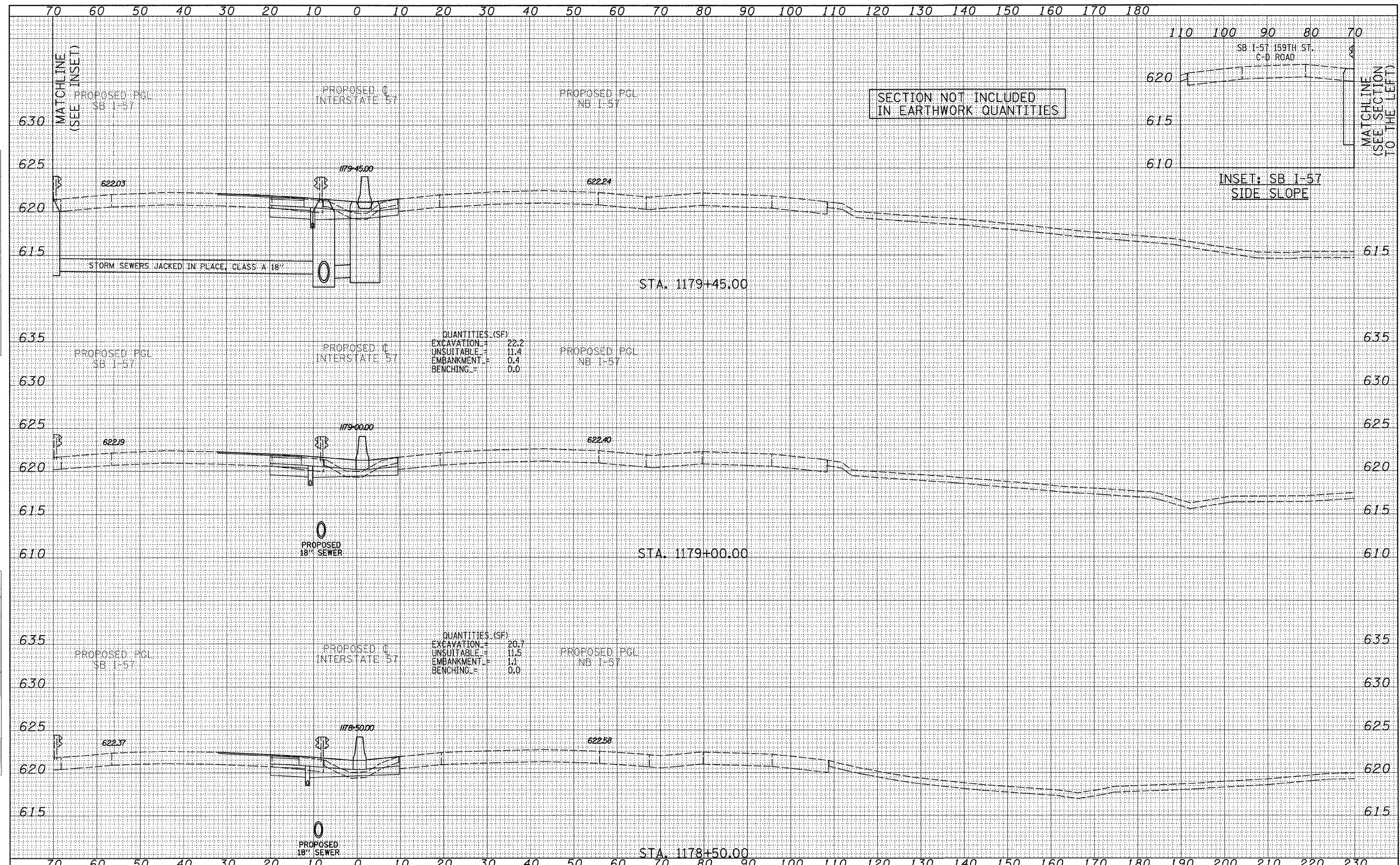

TYLIN INTERNATIONAL USER NAME = PLOT SCALE = PLOT DATE =	DESIGNED - JDF DRAWN - JDF CHECKED - JPM DATE - 3/18/2010	REVISED - REVISED - REVISED - REVISED -	STATE OF ILLINOIS DEPARTMENT OF TRANSPORTATION I-57 AT I-294 INTERCHANGE PROJECT PROPOSED I-57 CROSS SECTIONS	F.A.I. RTE. 57 SECTION 1414.2B COUNTY COOK TOTAL SHEETS 516 SHEET NO. 422 CONTRACT NO. 60J27
	SCALE: 1" = 10' H SHEET NO. OF SHEETS STA. 1178+50.00 TO STA. 1179+45.00			FED. ROAD DIST. NO. ILLINOIS FED. AID PROJECT