

FINAL SURVEY	DATE
SURVEYED	
PLOTTED	
REPLATE	
NOTE BOOK	
AREAS CHECKED	
NO.	

ORIGINAL SURVEY	DATE
SURVEYED	
PLOTTED	
REPLATE	
NOTE BOOK	
AREAS CHECKED	
NO.	

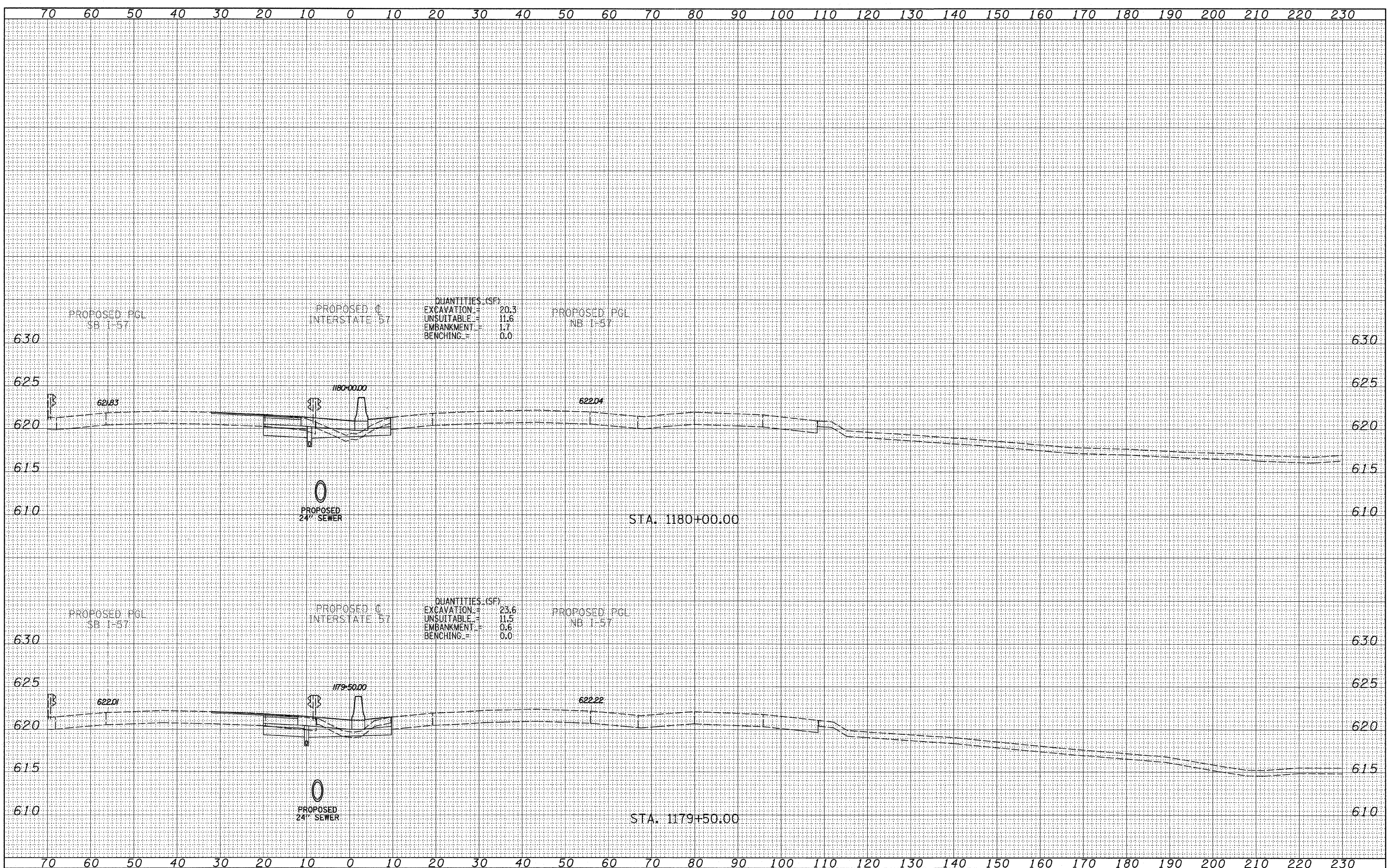

QUANTITIES (SF)

EXCAVATION	=	20.3
UNSUITABLE	=	11.6
EMBANKMENT	=	1.7
BENCHING	=	0.0

QUANTITIES (SF)

EXCAVATION	=	23.6
UNSUITABLE	=	11.5
EMBANKMENT	=	0.6
BENCHING	=	0.0

TYLIN INTERNATIONAL

USER NAME =	DESIGNED - JDF	REVISED -
PLOT SCALE =	DRAWN - JDF	REVISED -
PLOT DATE =	CHECKED - JPM	REVISED -
	DATE - 3/18/2010	REVISED -

**STATE OF ILLINOIS
DEPARTMENT OF TRANSPORTATION**

I-57 AT I-294 INTERCHANGE PROJECT			
PROPOSED I-57 CROSS SECTIONS			
SCALE: 1" = 10' V, 1" = 100' H	SHEET NO. OF SHEETS	STA. 1179+50.00 TO STA. 1180+00.00	

F.A.I. RTE. 57	SECTION 1414.2B	COUNTY COOK	TOTAL SHEETS 516	SHEET NO. 423
FED. ROAD DIST. NO.		ILLINOIS FED. AID PROJECT		
CONTRACT NO. 60J27				