

FINAL SURVEY	DATE
SURVEYED	BY
PLOTTED	
TEMPLATE	
NOTE BOOK	
AREAS CHECKED	
NO.	

ORIGINAL SURVEY	DATE
SURVEYED	BY
PLOTTED	
TEMPLATE	
NOTE BOOK	
AREAS CHECKED	
NO.	

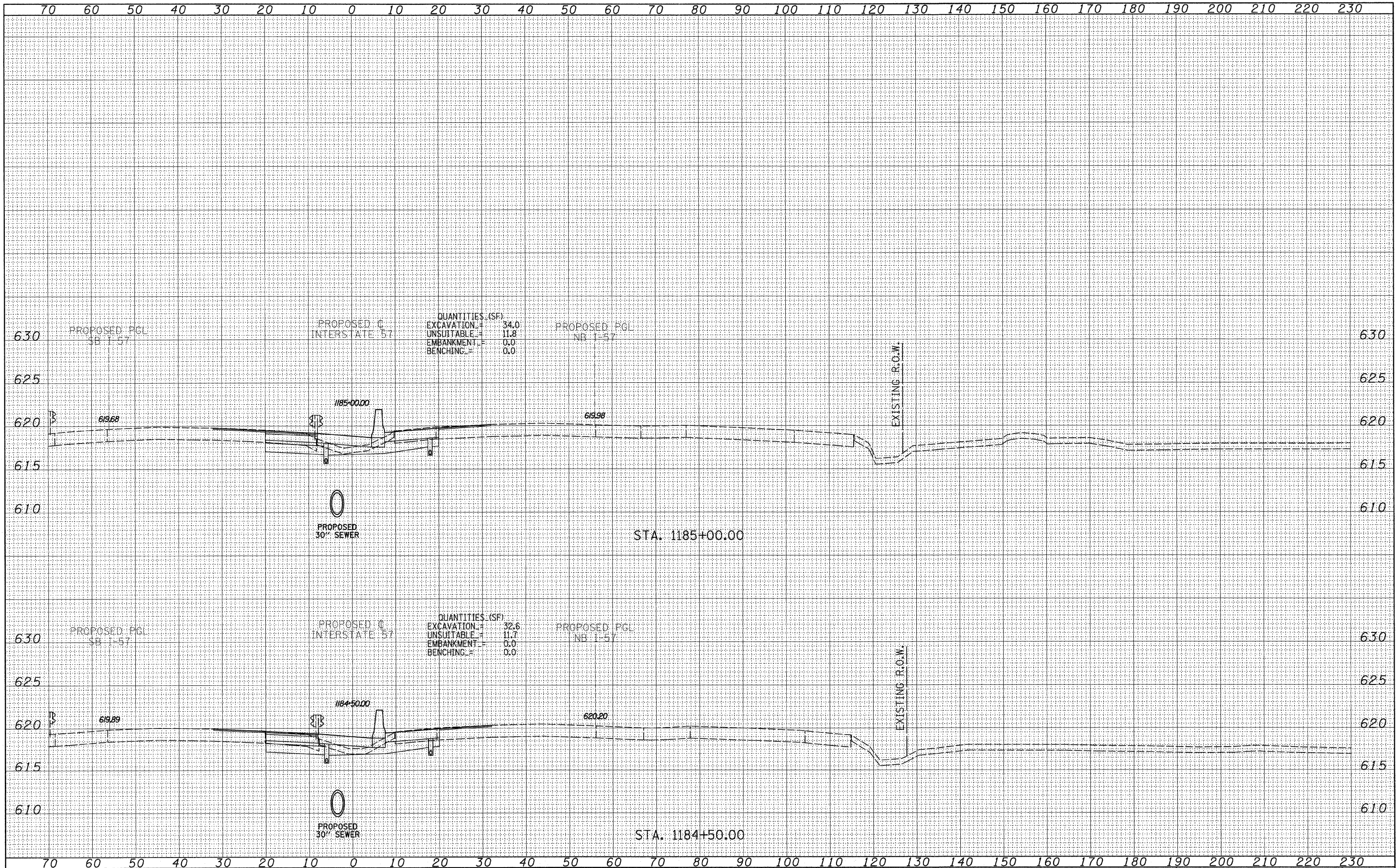

TYLIN INTERNATIONAL	USER NAME =	DESIGNED - JDF	REVISED -	STATE OF ILLINOIS DEPARTMENT OF TRANSPORTATION	I-57 AT I-294 INTERCHANGE PROJECT			F.A.I. RTE.	SECTION	COUNTY	TOTAL SHEETS	SHEET NO.
	PLOT SCALE =	DRAWN - JDF	REVISED -		SCALE: 1" = 10' H 1" = 80' V	SHEET NO.	OF	SHEETS	STA. 1184+50.00 TO STA. 1185+00.00	57	1414.2B	COOK
	PLOT DATE =	CHECKED - JPM	REVISED -					FED. ROAD DIST. NO.	ILLINOIS FED. AID PROJECT	CONTRACT NO. 60J27		
		DATE - 3/18/2010	REVISED -									