

DATE	
BY	
FINAL SURVEY	
SHRIVED PLOTTED	
NOTE BOOK	
AREAS CHECKED	
NO.	

DATE	
BY	
ORIGINAL SURVEY	
SHRIVED PLOTTED	
NOTE BOOK	
AREAS CHECKED	
NO.	

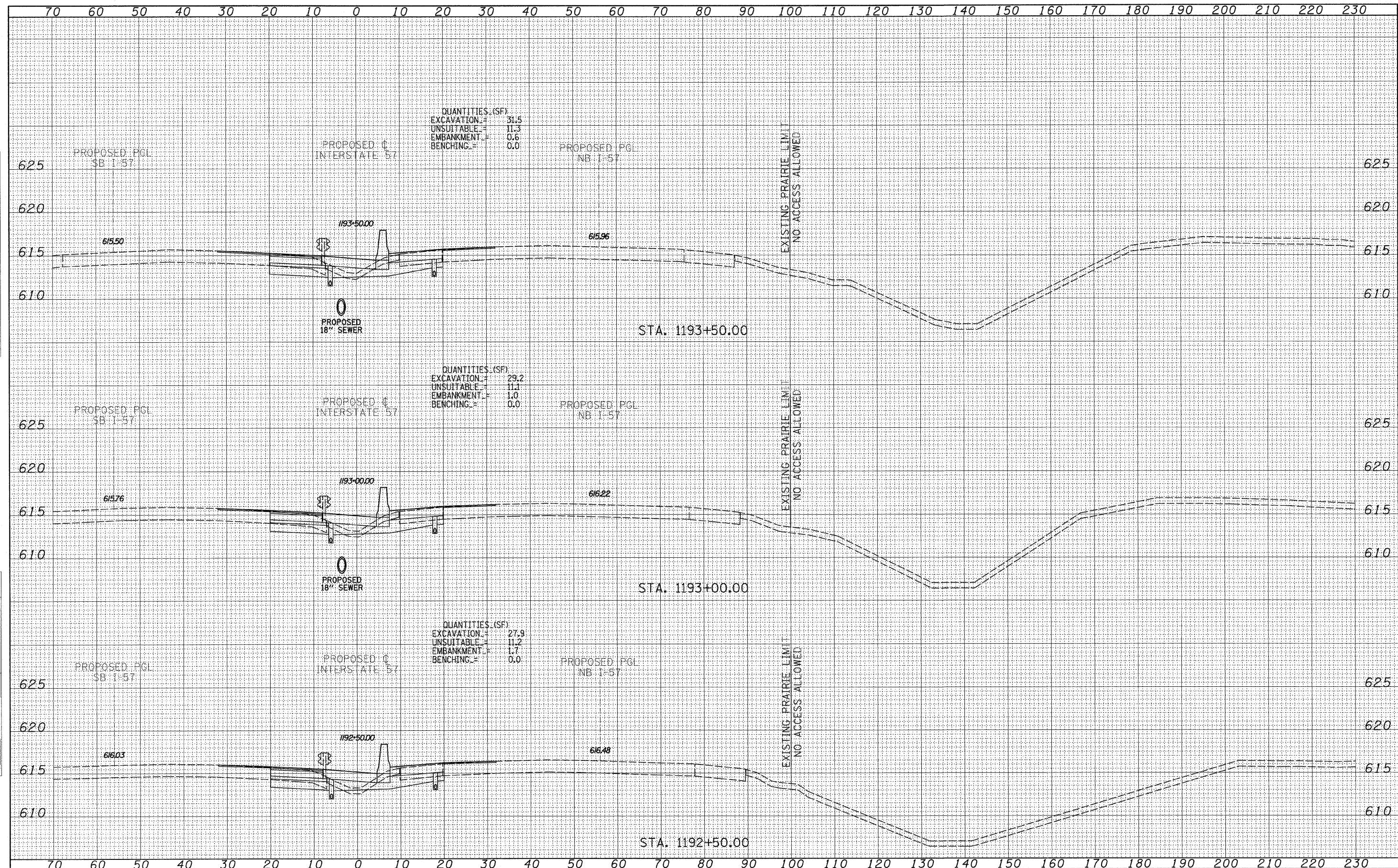

QUANTITIES (SF)
 EXCAVATION = 31.5
 UNSUITABLE = 11.3
 EMBANKMENT = 0.6
 BENCHING = 0.0

QUANTITIES (SF)
 EXCAVATION = 29.2
 UNSUITABLE = 11.1
 EMBANKMENT = 1.0
 BENCHING = 0.0

QUANTITIES (SF)
 EXCAVATION = 27.9
 UNSUITABLE = 11.2
 EMBANKMENT = 1.7
 BENCHING = 0.0

TYLIN INTERNATIONAL
 USER NAME =
 PLOT SCALE =
 PLOT DATE =

DESIGNED - JDF	REVISED -
DRAWN - JDF	REVISED -
CHECKED - JPM	REVISED -
DATE - 3/18/2010	REVISED -

STATE OF ILLINOIS
 DEPARTMENT OF TRANSPORTATION

I-57 AT I-294 INTERCHANGE PROJECT
 PROPOSED I-57 CROSS SECTIONS
 SCALE: 1" = 10' V
 SHEET NO. OF SHEETS STA. 1192+50.00 TO STA. 1193+50.00

F.A.I. RTE. 57	SECTION 1414.2B	COUNTY COOK	TOTAL SHEETS 516	SHEET NO. 435
FED. ROAD DIST. NO. ILLINOIS FED. AID PROJECT			CONTRACT NO. 60J27	