

DATE	
BY	
FINAL SURVEY	
SURVEYED	
PLOTTED	
TEMPLATE	
NOTE BOOK	
AREAS CHECKED	
NO.	

DATE	
BY	
ORIGINAL SURVEY	
SURVEYED	
PLOTTED	
TEMPLATE	
NOTE BOOK	
AREAS CHECKED	
NO.	

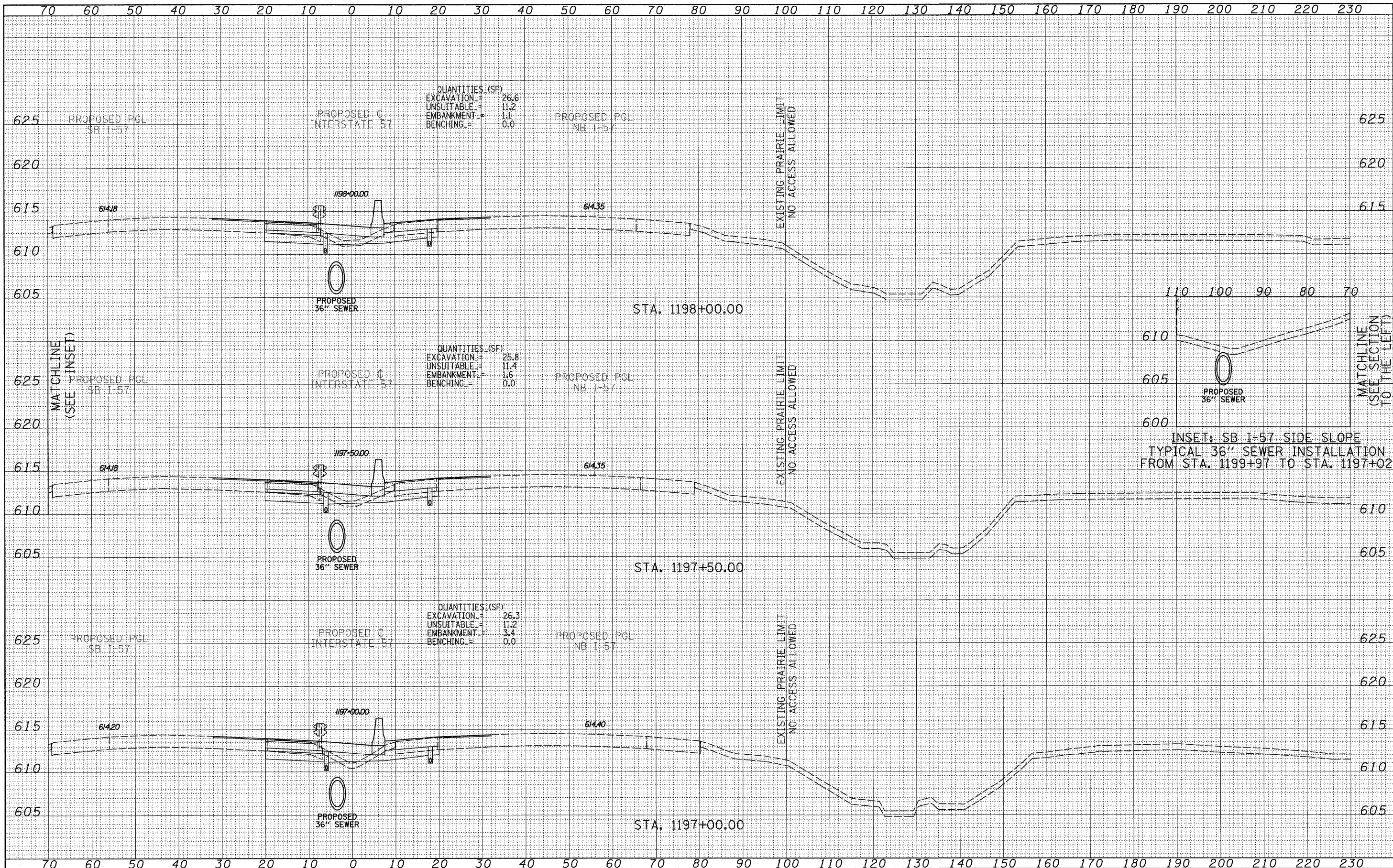

INSET: SB I-57 SIDE SLOPE  
TYPICAL 36" SEWER INSTALLATION  
FROM STA. 1199+97 TO STA. 1197+02

TYLIN INTERNATIONAL

USER NAME =	DESIGNED - JDF	REVISED -
PLOT SCALE =	DRAWN - JDF	REVISED -
PLOT DATE =	CHECKED - JPM	REVISED -
	DATE - 3/18/2010	REVISED -

STATE OF ILLINOIS  
DEPARTMENT OF TRANSPORTATION

I-57 AT I-294 INTERCHANGE PROJECT			
PROPOSED I-57 CROSS SECTIONS			
SCALE: 1" = 10' H	SHEET NO. OF SHEETS	STA. 1197+00.00 TO STA. 1198+00.00	

F.A.I. RTE. 57	SECTION 1414.2B	COUNTY COOK	TOTAL SHEETS 516	SHEET NO. 438
CONTRACT NO. 60J27			ILLINOIS FED. AID PROJECT	

P:\602540\57-294\Road\PI\_157\_BR\PI\_57XS\_SHT.dgn