

DATE	
BY	
FINAL SURVEY	
SURVEYED	
PLOTTED	
TEMPLATE	
NOTE BOOK	
NO.	
AREAS CHECKED	

DATE	
BY	
ORIGINAL SURVEY	
SURVEYED	
PLOTTED	
TEMPLATE	
NOTE BOOK	
NO.	
AREAS CHECKED	

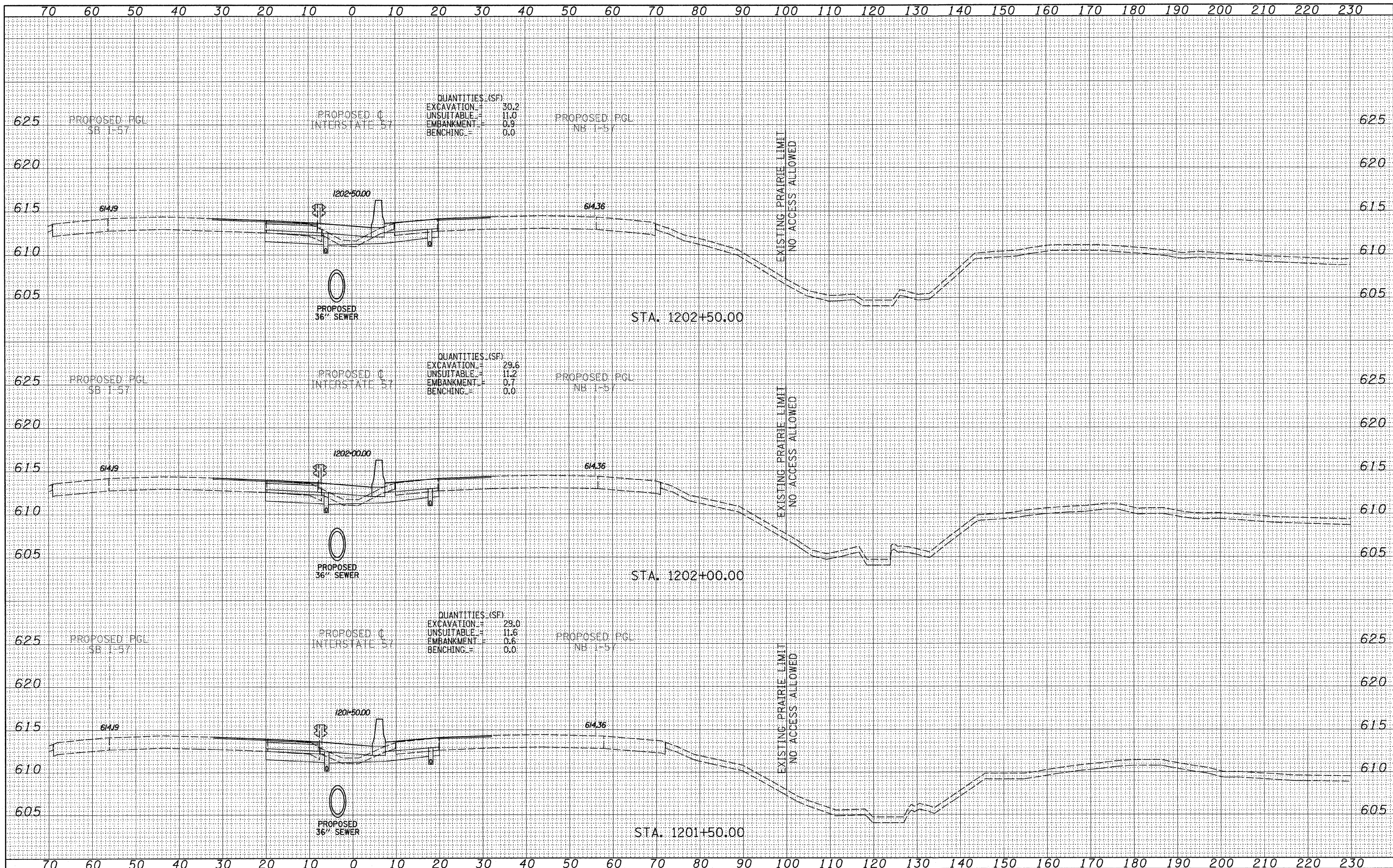

QUANTITIES (SF)  
 EXCAVATION = 30.2  
 UNSUITABLE = 11.0  
 EMBANKMENT = 0.9  
 BENCHING = 0.0

QUANTITIES (SF)  
 EXCAVATION = 29.6  
 UNSUITABLE = 11.2  
 EMBANKMENT = 0.7  
 BENCHING = 0.0

QUANTITIES (SF)  
 EXCAVATION = 29.0  
 UNSUITABLE = 11.6  
 EMBANKMENT = 0.6  
 BENCHING = 0.0

TYLIN INTERNATIONAL

USER NAME =  
 PLOT SCALE =  
 PLOT DATE =

DESIGNED - JDF  
 DRAWN - JDF  
 CHECKED - JPM  
 DATE - 3/18/2010

REVISED -  
 REVISED -  
 REVISED -  
 REVISED -

STATE OF ILLINOIS  
 DEPARTMENT OF TRANSPORTATION

I-57 AT I-294 INTERCHANGE PROJECT  
 PROPOSED I-57 CROSS SECTIONS  
 SCALE: 1" = 10' H  
 SHEET NO. OF SHEETS STA. 1201+50.00 TO STA. 1202+50.00

F.A.I. RTE. 57	SECTION 1414.2B	COUNTY COOK	TOTAL SHEETS 516	SHEET NO. 441
FED. ROAD DIST. NO. ILLINOIS FED. AID PROJECT			CONTRACT NO. 60J27	