

DATE	
BY	
FINAL SURVEY	
SURVEYED	
PLOTTED	
TEMPLATE	
NOTE BOOK	
AREAS CHECKED	
NO.	

DATE	
BY	
ORIGINAL SURVEY	
SURVEYED	
PLOTTED	
TEMPLATE	
NOTE BOOK	
AREAS CHECKED	
NO.	

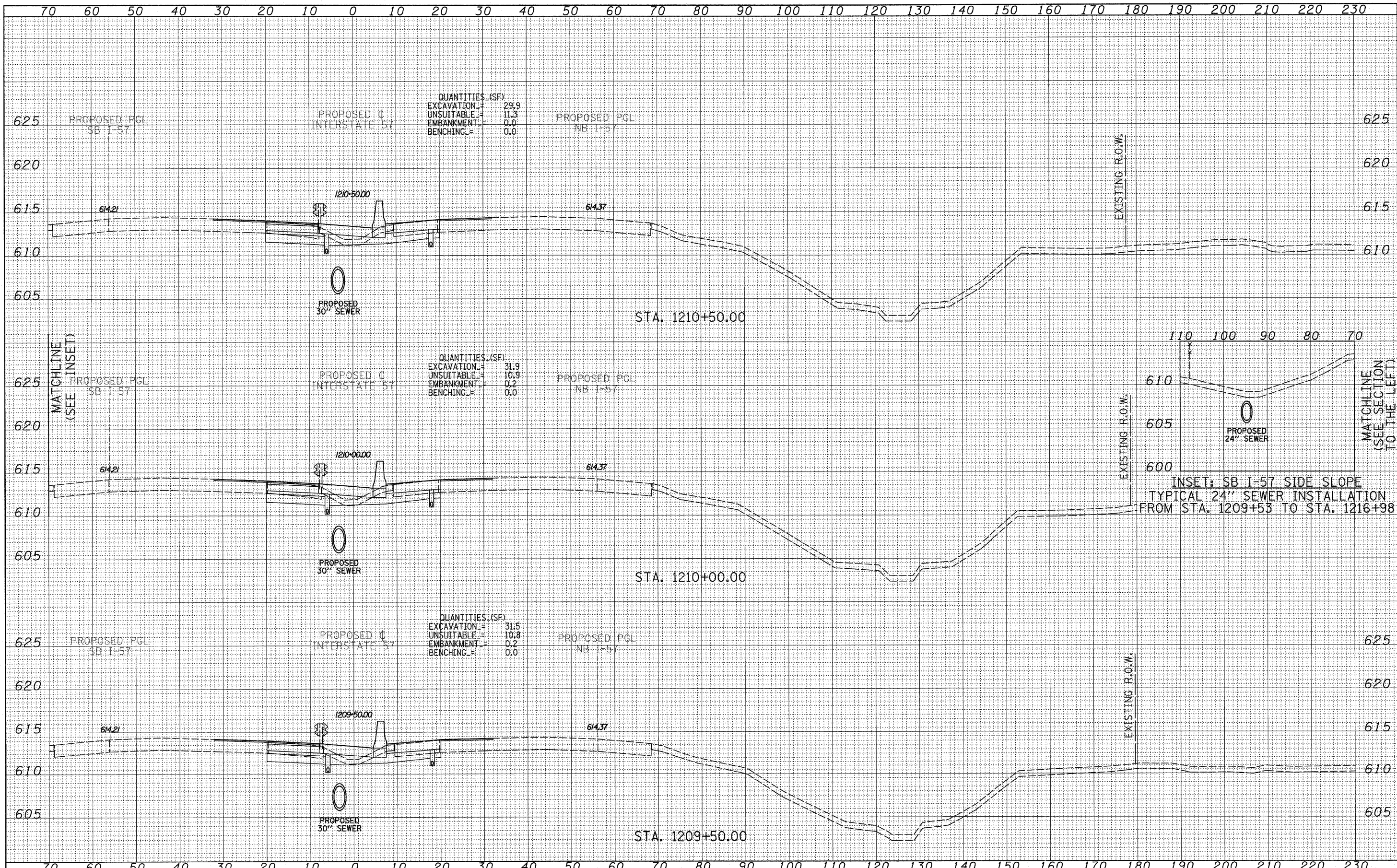

QUANTITIES (SF)  
 EXCAVATION = 29.9  
 UNSUITABLE = 11.3  
 EMBANKMENT = 0.0  
 BENCHING = 0.0

QUANTITIES (SF)  
 EXCAVATION = 31.9  
 UNSUITABLE = 10.9  
 EMBANKMENT = 0.2  
 BENCHING = 0.0

QUANTITIES (SF)  
 EXCAVATION = 31.5  
 UNSUITABLE = 10.8  
 EMBANKMENT = 0.2  
 BENCHING = 0.0

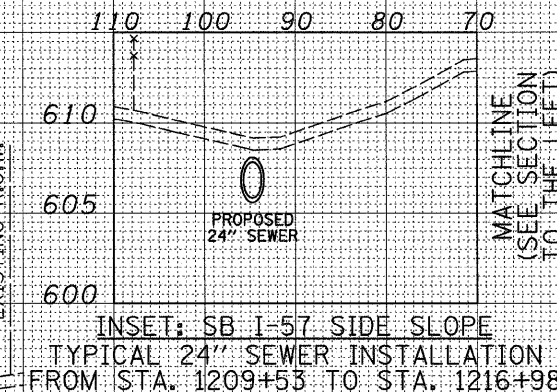

TYLIN INTERNATIONAL

USER NAME =	DESIGNED - JDF	REVISED -
PLOT SCALE =	DRAWN - JDF	REVISED -
PLOT DATE =	CHECKED - JPM	REVISED -
	DATE - 3/18/2010	REVISED -

STATE OF ILLINOIS  
 DEPARTMENT OF TRANSPORTATION

I-57 AT I-294 INTERCHANGE PROJECT  
 PROPOSED I-57 CROSS SECTIONS  
 SCALE: 1" = 10' H  
 SHEET NO. OF SHEETS STA. 1209+50.00 TO STA. 1210+50.00

F.A.I. RTE.	SECTION	COUNTY	TOTAL SHEETS	SHEET NO.
57	1414.2B	COOK	516	447
FED. ROAD DIST. NO. ILLINOIS FED. AID PROJECT			CONTRACT NO. 60J27	