

DATE	
BY	
SURVEYED	
PLOTTED	
TEMPLATE	
NOTE BOOK	
AREAS CHECKED	
NO.	

DATE	
BY	
SURVEYED	
PLOTTED	
TEMPLATE	
NOTE BOOK	
AREAS CHECKED	
NO.	

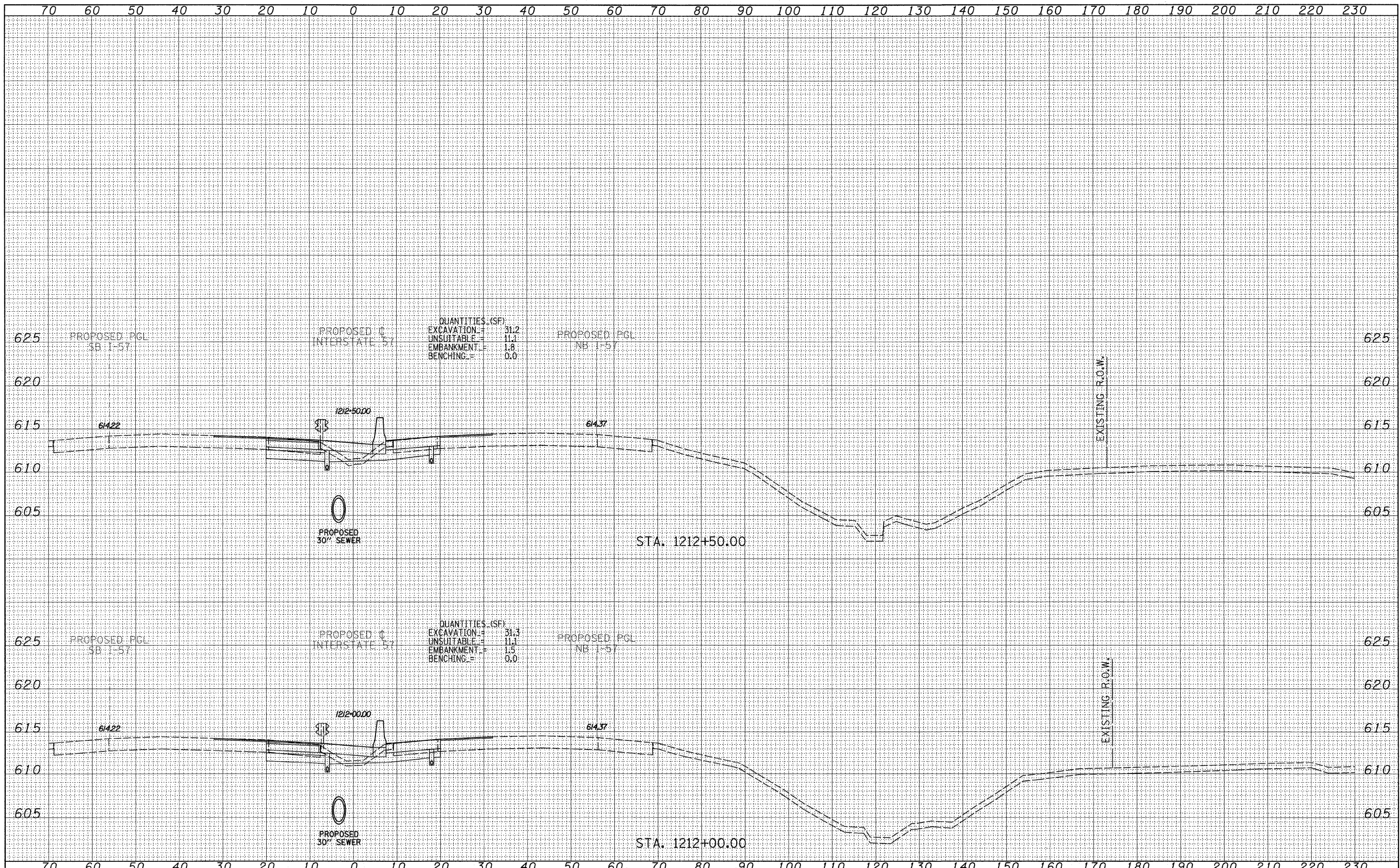

QUANTITIES (SF)
 EXCAVATION = 31.2
 UNSUITABLE = 11.1
 EMBANKMENT = 1.8
 BENCHING = 0.0

QUANTITIES (SF)
 EXCAVATION = 31.3
 UNSUITABLE = 11.1
 EMBANKMENT = 1.5
 BENCHING = 0.0

TYLIN INTERNATIONAL

USER NAME =	DESIGNED - JDF	REVISED -
PLOT SCALE =	DRAWN - JDF	REVISED -
PLOT DATE =	CHECKED - JPM	REVISED -
	DATE - 3/18/2010	REVISED -

**STATE OF ILLINOIS
 DEPARTMENT OF TRANSPORTATION**

**I-57 AT I-294 INTERCHANGE PROJECT
 PROPOSED I-57 CROSS SECTIONS**
 SCALE: 1" = 10' H
 SHEET NO. OF SHEETS STA. 1212+00.00 TO STA. 1212+50.00

F.A.I. RTE. 57	SECTION 1414.2B	COUNTY COOK	TOTAL SHEETS 516	SHEET NO. 449
FED. ROAD DIST. NO. ILLINOIS FED. AID PROJECT			CONTRACT NO. 60J27	

P:\602540(57-294)\Road\PI_157 BR\PI_157XS_SHT.dgn