

FINAL	DATE
SURVEY	
PLOTTED	
NOTE BOOK	
REPLATE	
AREAS CHECKED	
NO.	

ORIGINAL	DATE
SURVEY	
PLOTTED	
NOTE BOOK	
REPLATE	
AREAS CHECKED	
NO.	

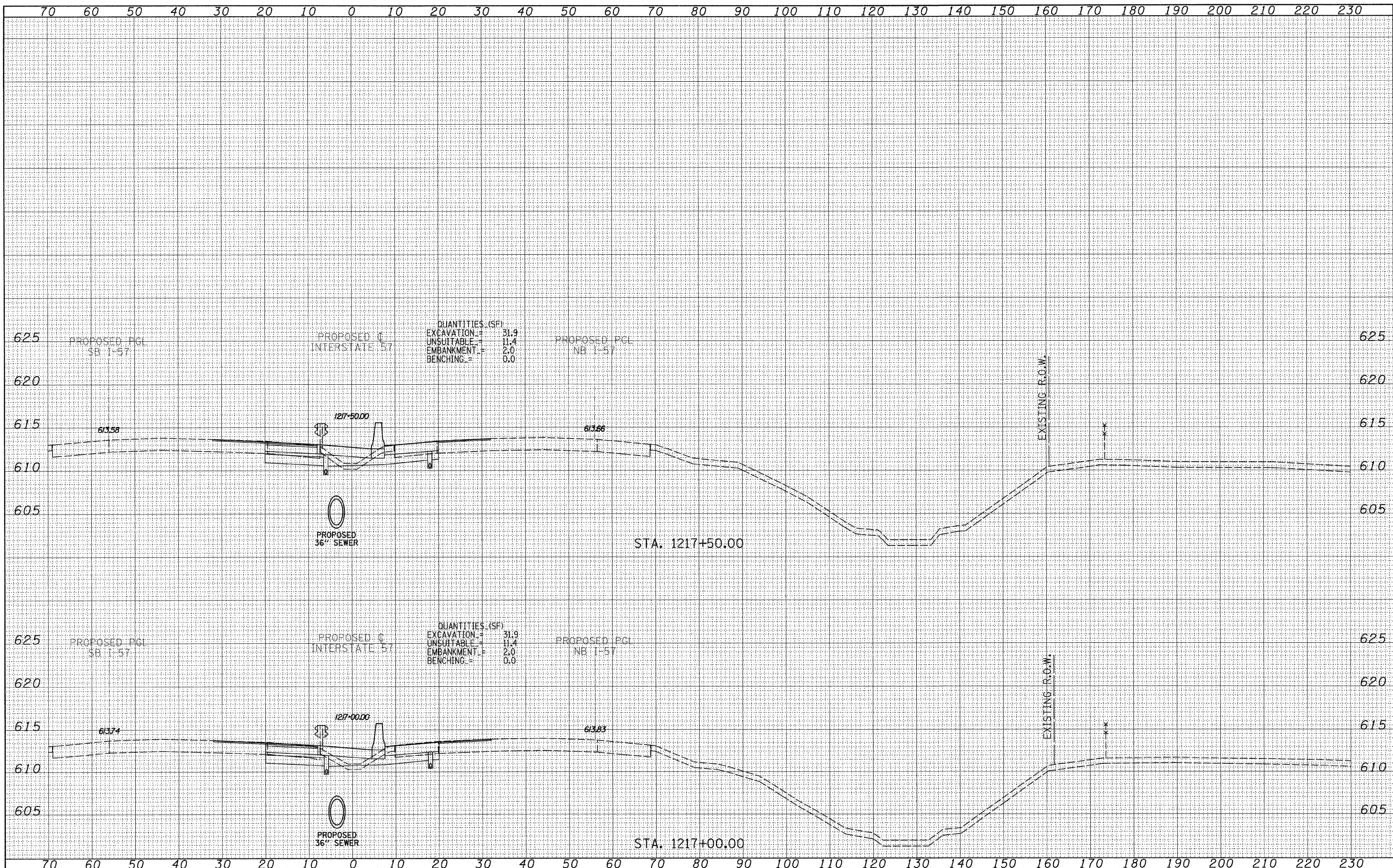

TYLIN INTERNATIONAL

USER NAME =
 PLOT SCALE =
 PLOT DATE =

DESIGNED - JDF
 DRAWN - JDF
 CHECKED - JPM
 DATE - 3/18/2010

REVISED -
 REVISED -
 REVISED -
 REVISED -

**STATE OF ILLINOIS
 DEPARTMENT OF TRANSPORTATION**

**I-57 AT I-294 INTERCHANGE PROJECT
 PROPOSED I-57 CROSS SECTIONS**
 SCALE: 1" = 10' H
 SHEET NO. OF SHEETS STA. 1217+00.00 TO STA. 1217+50.00

F.A.I. RTE. 57	SECTION 1414.2B	COUNTY COOK	TOTAL SHEETS 516	SHEET NO. 454
FED. ROAD DIST. NO. ILLINOIS FED. AID PROJECT			CONTRACT NO. 60J27	

P:\602540(57-294)\Road\PI_157_BR\PI_57XS_SHT.dgn