

DATE	
BY	
FINAL SURVEY	
NOTED SURVEY	
NOTE BOOK NO.	
AREAS CHECKED	

DATE	
BY	
ORIGINAL SURVEY	
NOTED SURVEY	
NOTE BOOK NO.	
AREAS CHECKED	

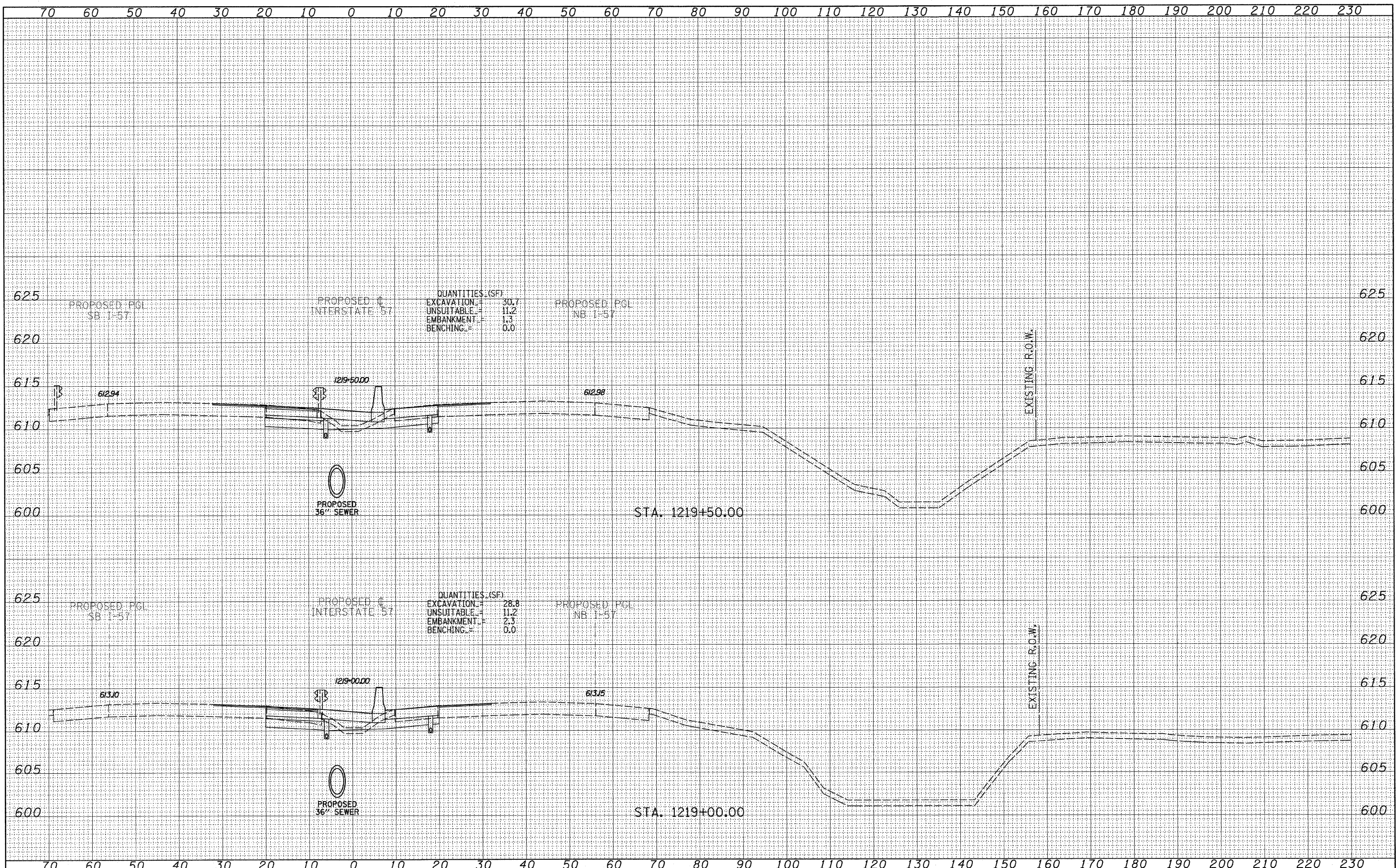

QUANTITIES (SF)

EXCAVATION	30.7
UNSUITABLE	11.2
EMBANKMENT	1.3
BENCHING	0.0

QUANTITIES (SF)

EXCAVATION	28.8
UNSUITABLE	11.2
EMBANKMENT	2.3
BENCHING	0.0

TYLIN INTERNATIONAL

USER NAME =	DESIGNED - JDF	REVISED -
PLOT SCALE =	DRAWN - JDF	REVISED -
PLOT DATE =	CHECKED - JPM	REVISED -
	DATE - 3/18/2010	REVISED -

STATE OF ILLINOIS
DEPARTMENT OF TRANSPORTATION

I-57 AT I-294 INTERCHANGE PROJECT
PROPOSED I-57 CROSS SECTIONS

SCALE: 1/2" = 10' H
1/2" = 8' V

SHEET NO.	OF	SHEETS	STA. 1219+00.00 TO STA. 1219+50.00
-----------	----	--------	------------------------------------

F.A.I. RTE.	SECTION	COUNTY	TOTAL SHEETS	SHEET NO.
57	1414.2B	COOK	516	456
FED. ROAD DIST. NO.	ILLINOIS FED. AID PROJECT	CONTRACT NO. 60J27		