

DATE	
BY	
FINAL SURVEY	
SURVEYED	
PLOTTED	
NOTE BOOK	
AREAS CHECKED	
NO.	

DATE	
BY	
ORIGINAL SURVEY	
SURVEYED	
PLOTTED	
NOTE BOOK	
AREAS CHECKED	
NO.	

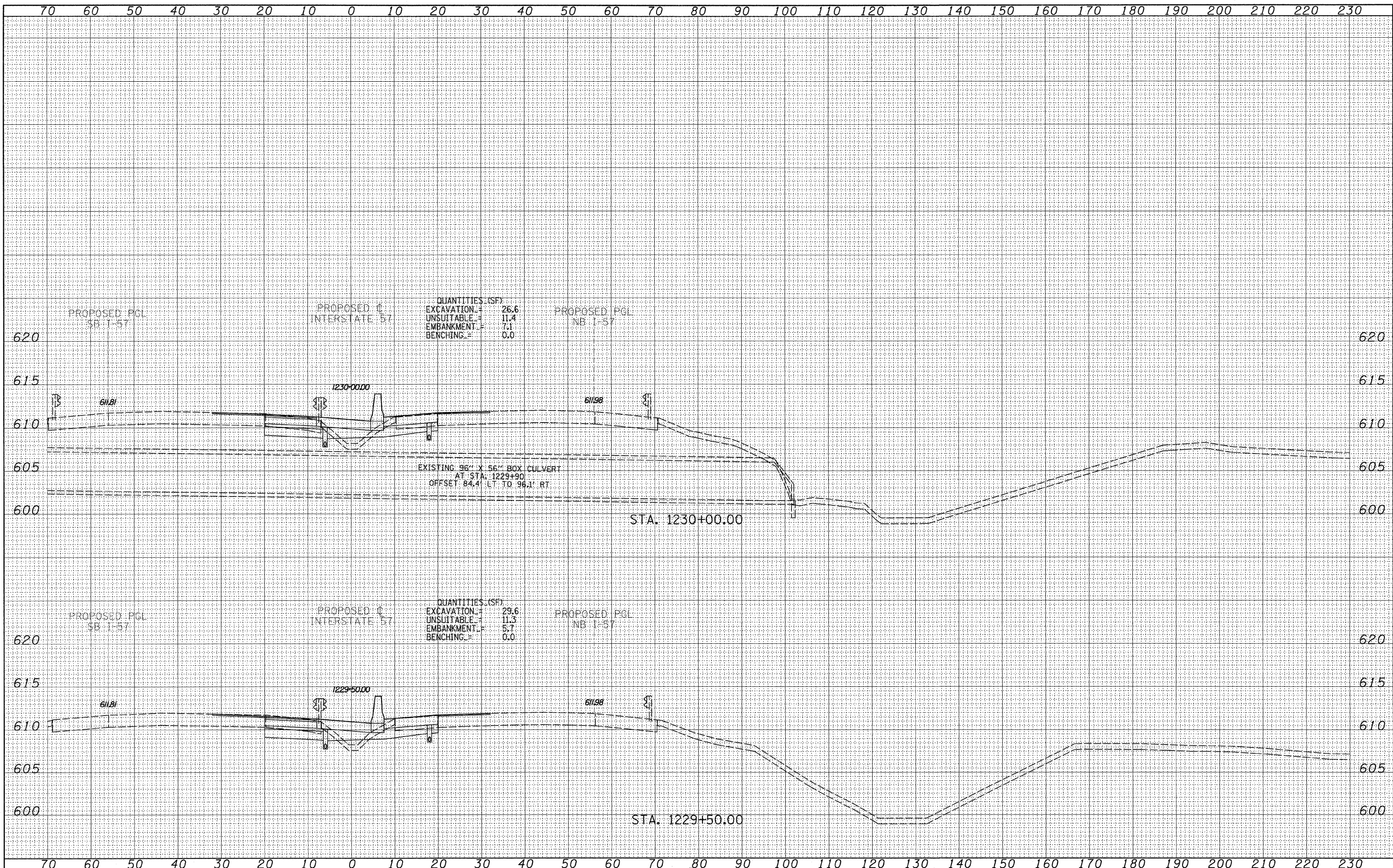

QUANTITIES (SF)
 EXCAVATION = 26.6
 UNSUITABLE = 11.4
 EMBANKMENT = 7.1
 BENCHING = 0.0

QUANTITIES (SF)
 EXCAVATION = 29.6
 UNSUITABLE = 11.3
 EMBANKMENT = 5.7
 BENCHING = 0.0

EXISTING 96" X 56" BOX CULVERT
 AT STA. 1229+90
 OFFSET 84.4' LT TO 96.1' RT

TYLIN INTERNATIONAL
 USER NAME =
 PLOT SCALE =
 PLOT DATE =

DESIGNED - JDF
 DRAWN - JDF
 CHECKED - JPM
 DATE - 3/18/2010

REVISED -
 REVISED -
 REVISED -
 REVISED -

STATE OF ILLINOIS
 DEPARTMENT OF TRANSPORTATION

I-57 AT I-294 INTERCHANGE PROJECT
 PROPOSED I-57 CROSS SECTIONS
 SCALE: 1" = 10' H
 SHEET NO. OF SHEETS STA. 1229+50.00 TO STA. 1230+00.00

F.A.I. RTE.	SECTION	COUNTY	TOTAL SHEETS	SHEET NO.
57	1414.2B	COOK	516	466
CONTRACT NO. 60J27				
FED. ROAD DIST. NO. ILLINOIS FED. AID PROJECT				