

DATE	
BY	
SURVEYED	
PLOTTED	
TEMPLATE	
NOTE BOOK	
AREAS CHECKED	
NO.	

DATE	
BY	
SURVEYED	
PLOTTED	
TEMPLATE	
NOTE BOOK	
AREAS CHECKED	
NO.	

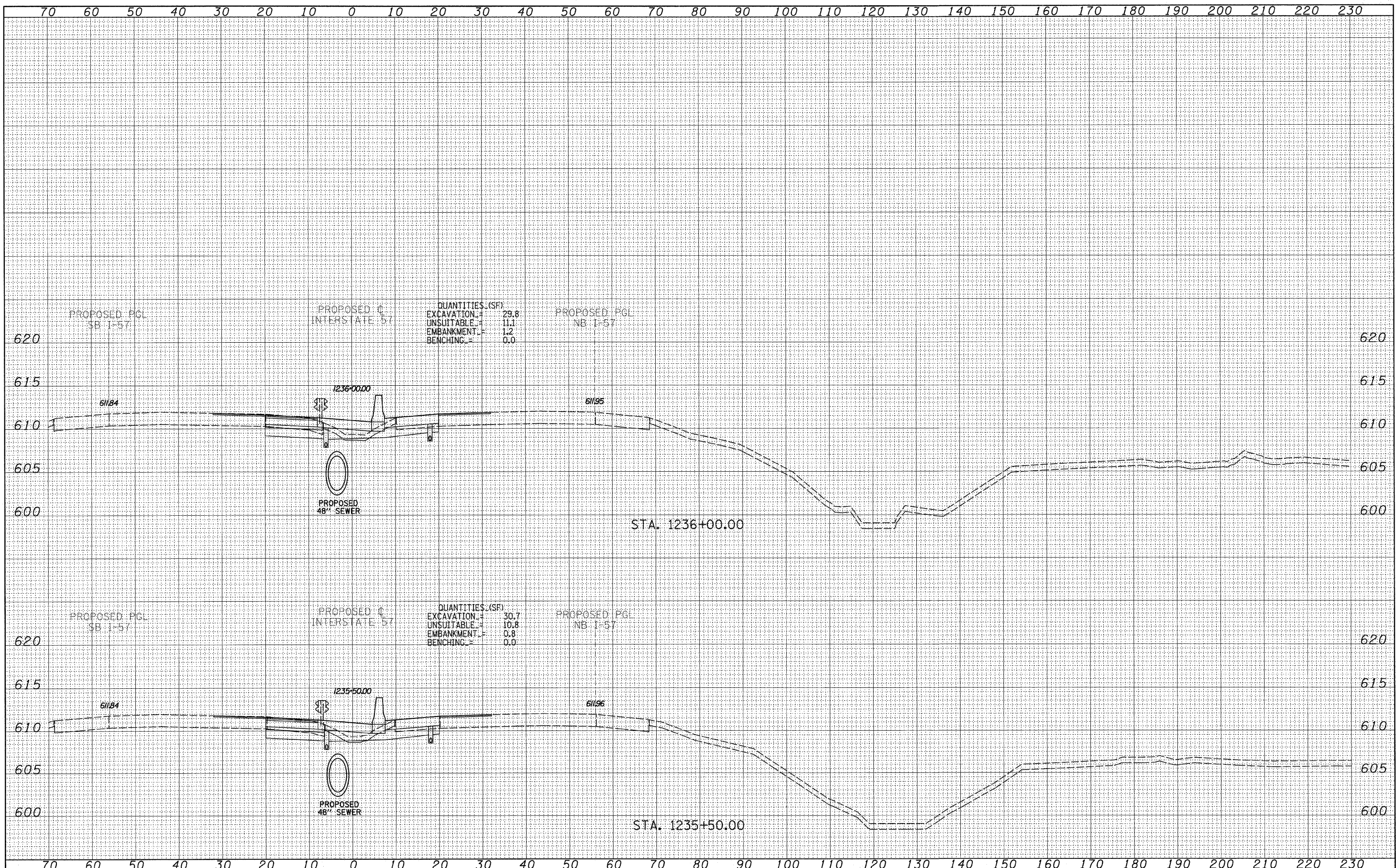

QUANTITIES (SF)  
 EXCAVATION = 29.8  
 UNSUITABLE = 11.1  
 EMBANKMENT = 1.2  
 BENCHING = 0.0

QUANTITIES (SF)  
 EXCAVATION = 30.7  
 UNSUITABLE = 10.8  
 EMBANKMENT = 0.8  
 BENCHING = 0.0

TYLIN INTERNATIONAL

USER NAME =  
 PLOT SCALE =  
 PLOT DATE =

DESIGNED - JDF  
 DRAWN - JDF  
 CHECKED - JPM  
 DATE - 3/18/2010

REVISED -  
 REVISED -  
 REVISED -  
 REVISED -

STATE OF ILLINOIS  
 DEPARTMENT OF TRANSPORTATION

I-57 AT I-294 INTERCHANGE PROJECT  
 PROPOSED I-57 CROSS SECTIONS  
 SCALE: 1" = 10' H  
 SHEET NO. OF SHEETS STA. 1235+50.00 TO STA. 1236+00.00

F.A.I. RTE.	SECTION	COUNTY	TOTAL SHEETS	SHEET NO.
57	1414.2B	COOK	516	472
FED. ROAD DIST. NO. ILLINOIS FED. AID PROJECT			CONTRACT NO. 60J27	

P:\602540(57-294)\Road\PI\_157 BR\PI\_57XS\_SHT.dgn