

| | |
|---------------|--|
| DATE | |
| BY | |
| SURVEYED | |
| PLOTTED | |
| NOTE BOOK | |
| TEMPLATE | |
| AREAS CHECKED | |
| NO. | |

| | |
|---------------|--|
| DATE | |
| BY | |
| SURVEYED | |
| PLOTTED | |
| NOTE BOOK | |
| TEMPLATE | |
| AREAS CHECKED | |
| NO. | |

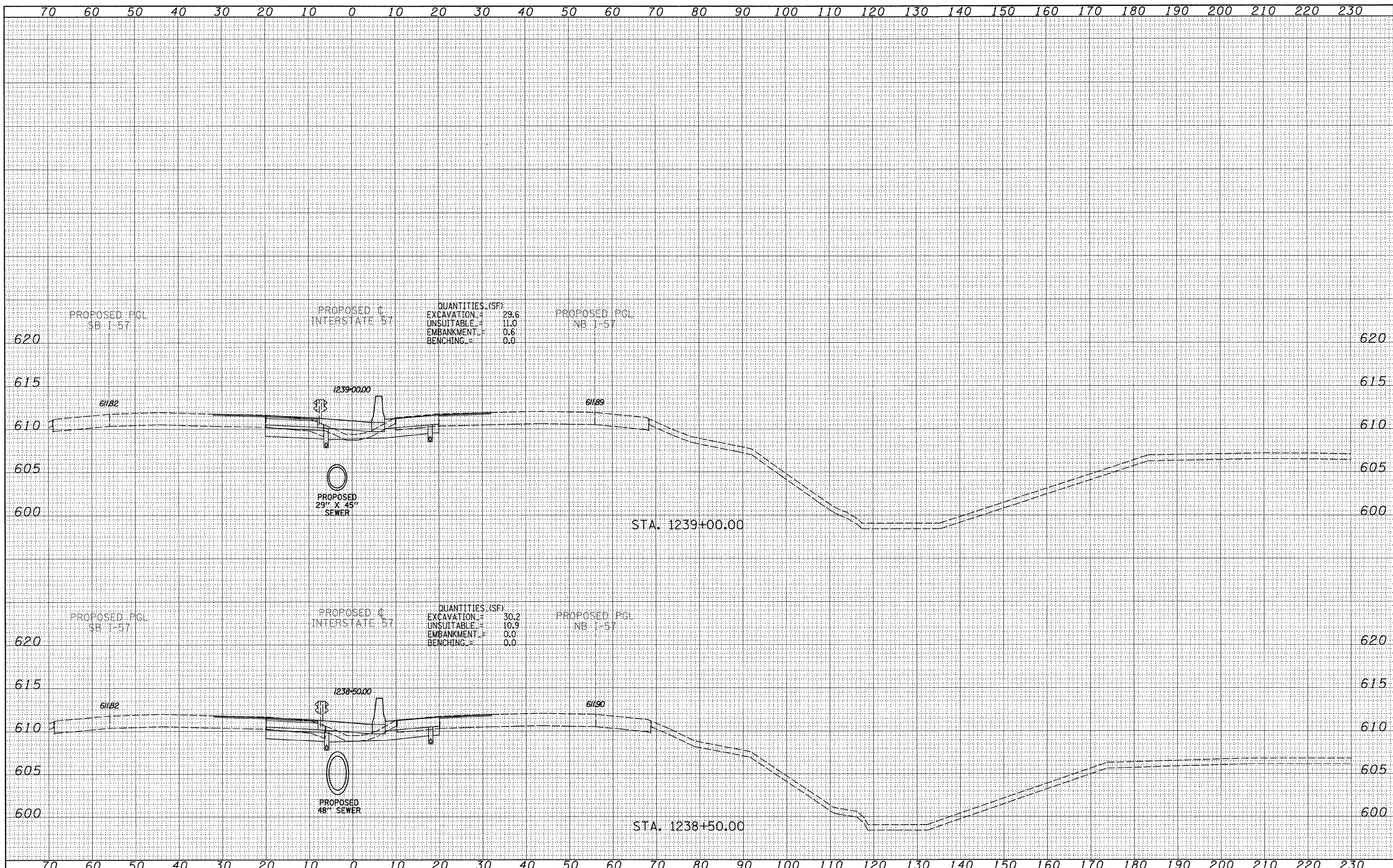

QUANTITIES (SF)

| | | |
|------------|---|------|
| EXCAVATION | = | 29.6 |
| UNSUITABLE | = | 11.0 |
| EMBANKMENT | = | 0.6 |
| BENCHING | = | 0.0 |

QUANTITIES (SF)

| | | |
|------------|---|------|
| EXCAVATION | = | 30.2 |
| UNSUITABLE | = | 10.9 |
| EMBANKMENT | = | 0.0 |
| BENCHING | = | 0.0 |

TYLIN INTERNATIONAL

USER NAME =
 PLOT SCALE =
 PLOT DATE =

DESIGNED - JDF
 DRAWN - JDF
 CHECKED - JPM
 DATE - 3/18/2010

REVISED -
 REVISED -
 REVISED -
 REVISED -

STATE OF ILLINOIS
 DEPARTMENT OF TRANSPORTATION

I-57 AT I-294 INTERCHANGE PROJECT
 PROPOSED I-57 CROSS SECTIONS

SCALE: 1" = 10' H
 SHEET NO. OF SHEETS STA. 1238+50.00 TO STA. 1239+00.00

| | | | | |
|---|---------|--------|--------------------|-----------|
| F.A.I. RTE. | SECTION | COUNTY | TOTAL SHEETS | SHEET NO. |
| 57 | 1414.2B | COOK | 516 | 475 |
| FED. ROAD DIST. NO. ILLINOIS FED. AID PROJECT | | | CONTRACT NO. 60J27 | |