

NOTE: AN EXISTING DITCH FLOWS FROM STA. 1246+25; OFFSET 120' LT TO STA. 1246+50; OFFSET 97' LT (REGRADE FOR THE PROPOSED IMPROVEMENT IS NOT REQUIRED)

DATE	
BY	
SURVEYED	
PLOTTED	
DATE	
AREAS	
CHECKED	
FINAL SURVEY	
NOTE BOOK	
NO.	

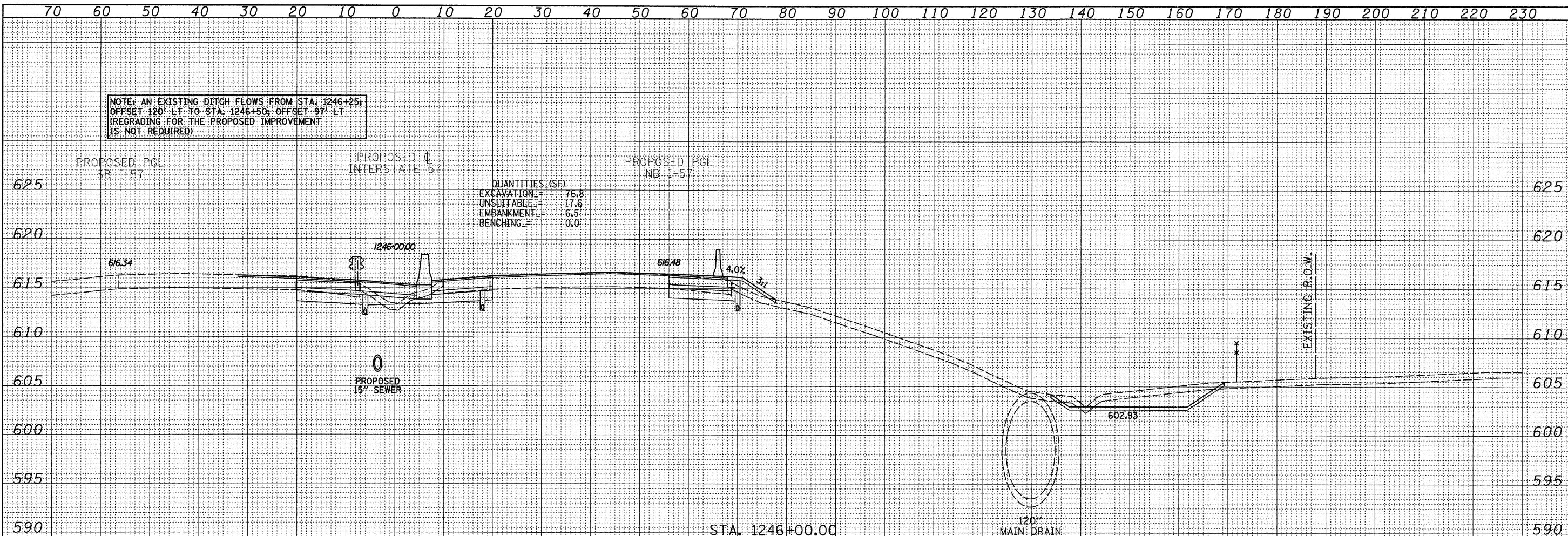

QUANTITIES (SF)
 EXCAVATION = 76.8
 UNSUITABLE = 17.6
 EMBANKMENT = 6.5
 BENCHING = 0.0

DATE	
BY	
SURVEYED	
PLOTTED	
DATE	
AREAS	
CHECKED	
ORIGINAL SURVEY	
NOTE BOOK	
NO.	

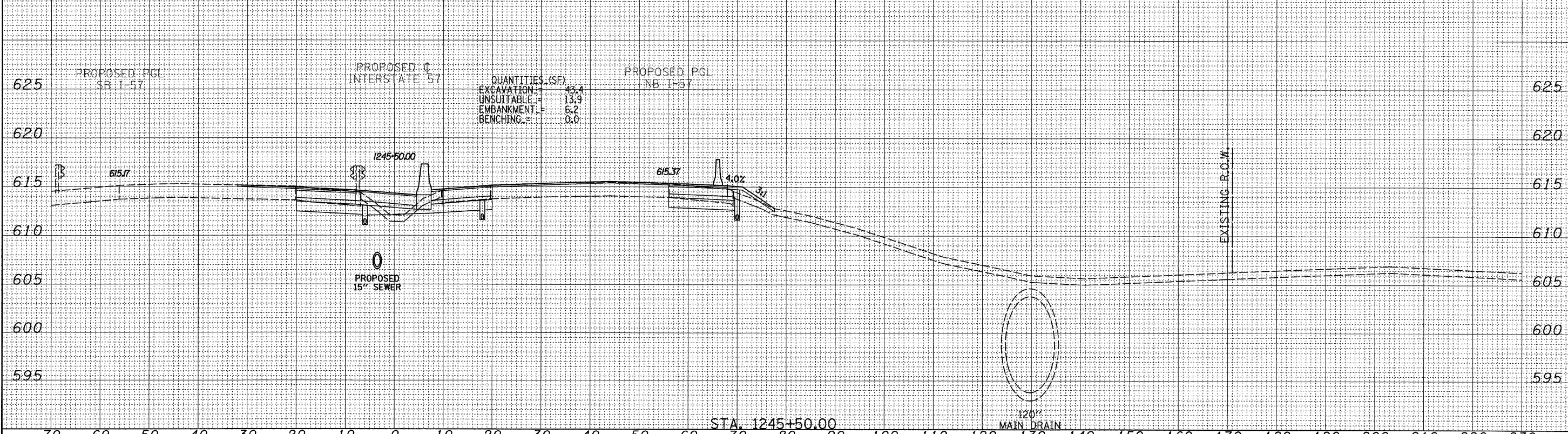

QUANTITIES (SF)
 EXCAVATION = 43.4
 UNSUITABLE = 13.9
 EMBANKMENT = 6.2
 BENCHING = 0.0

TYLIN INTERNATIONAL	USER NAME =	DESIGNED - JDF	REVISED - 4/29/2010	STATE OF ILLINOIS DEPARTMENT OF TRANSPORTATION	I-57 AT I-294 INTERCHANGE PROJECT			F.A.I. RTE.	SECTION	COUNTY	TOTAL SHEETS	SHEET NO.
	PLOT SCALE =	DRAWN - JDF	REVISED -		57	1414.2B	COOK	516	482			
	PLOT DATE =	CHECKED - JPM	REVISED -		PROPOSED I-57 CROSS SECTIONS			CONTRACT NO. 60J27				
		DATE - 3/18/2010	REVISED -		SCALE: 1" = 10' H			FED. ROAD DIST. NO. ILLINOIS FED. AID PROJECT				