

FINAL SURVEY	DATE
SURVEYED	
NOTE BOOK	
NO.	

ORIGINAL SURVEY	DATE
SURVEYED	
NOTE BOOK	
NO.	

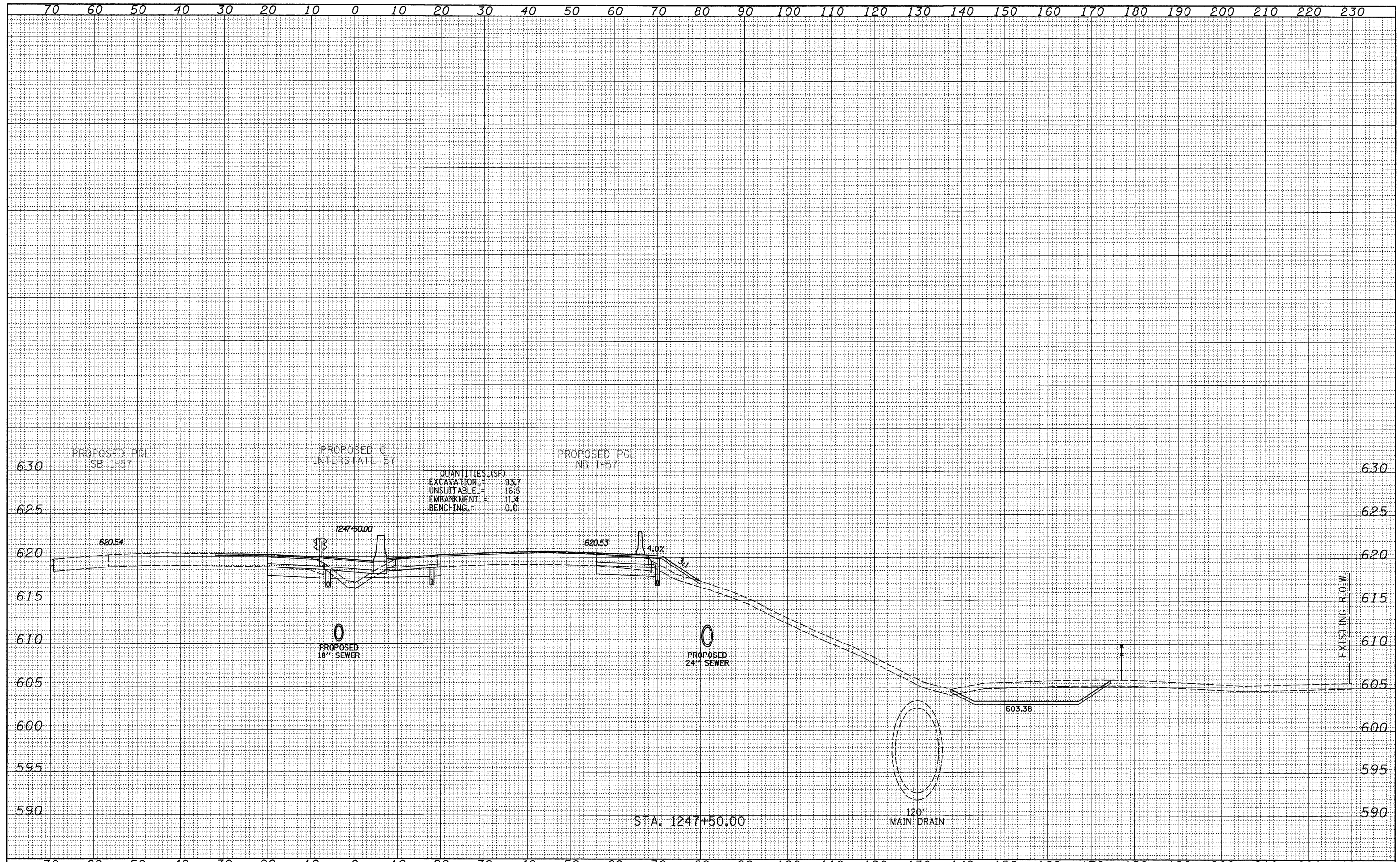

QUANTITIES (SF)
 EXCAVATION = 93.7
 UNSUITABLE = 16.5
 EMBANKMENT = 11.4
 BENCHING = 0.0

TYLIN INTERNATIONAL	USER NAME =	DESIGNED - JDF	REVISED - 4/29/2010	STATE OF ILLINOIS DEPARTMENT OF TRANSPORTATION	I-57 AT I-294 INTERCHANGE PROJECT		F.A.I. RTE. =	SECTION	COUNTY	TOTAL SHEETS	SHEET NO.
	PLOT SCALE =	DRAWN - JDF	REVISED -		57	1414.2B	COOK	516	486		
	PLOT DATE =	CHECKED - JPM	REVISED -		PROPOSED I-57 CROSS SECTIONS		CONTRACT NO. 60J27				
		DATE - 3/18/2010	REVISED -	SCALE: 1" = 10' H		SHEET NO. OF SHEETS	STA. 1247+50.00 TO STA. 1247+50.00		FED. ROAD DIST. NO. ILLINOIS FED. AID PROJECT		

P:\602540(57-294)\Road\PI.157 BR\PI.57XS_SHT_R.dgn