

FINAL SURVEY	SURVEYED	DATE
NOTE BOOK	PLOTTED	
NO.	DATE	
	AREAS	
	CHECKED	

ORIGINAL SURVEY	SURVEYED	DATE
NOTE BOOK	PLOTTED	
NO.	DATE	
	AREAS	
	CHECKED	

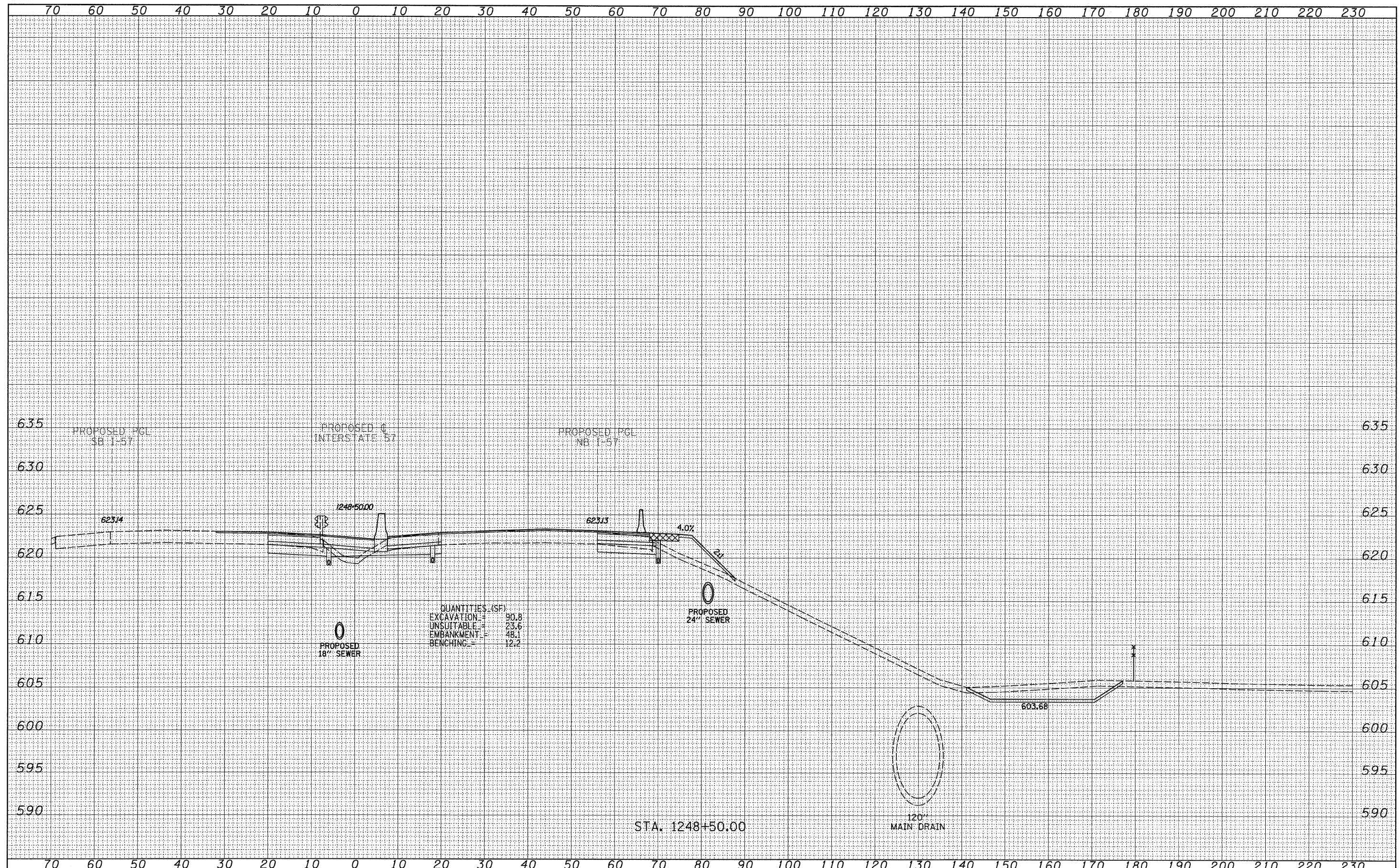

TYLIN INTERNATIONAL USER NAME = PLOT SCALE = PLOT DATE =	DESIGNED - JDF	REVISED - 4/29/2010	STATE OF ILLINOIS DEPARTMENT OF TRANSPORTATION	I-57 AT I-294 INTERCHANGE PROJECT PROPOSED I-57 CROSS SECTIONS		F.A.T. RTE. = 57	SECTION = 1414.2B	COUNTY = COOK	TOTAL SHEETS = 516	SHEET NO. = 488	
	DRAWN - JDF	REVISED -		SCALE: 1" = 10' H	SHEET NO. OF SHEETS	STA. 1248+50.00 TO STA. 1248+50.00	CONTRACT NO. 60J27				
	CHECKED - JPM	REVISED -									
	DATE - 3/18/2010	REVISED -									

P:\602540(57-294)\Road\PI.157 BR\PI-57XS_SHT_R.dgn