

DATE	
BY	
SURVEYED	
PLOTTED	
NOTE BOOK	
AREAS CHECKED	
NO.	

DATE	
BY	
SURVEYED	
PLOTTED	
NOTE BOOK	
AREAS CHECKED	
NO.	

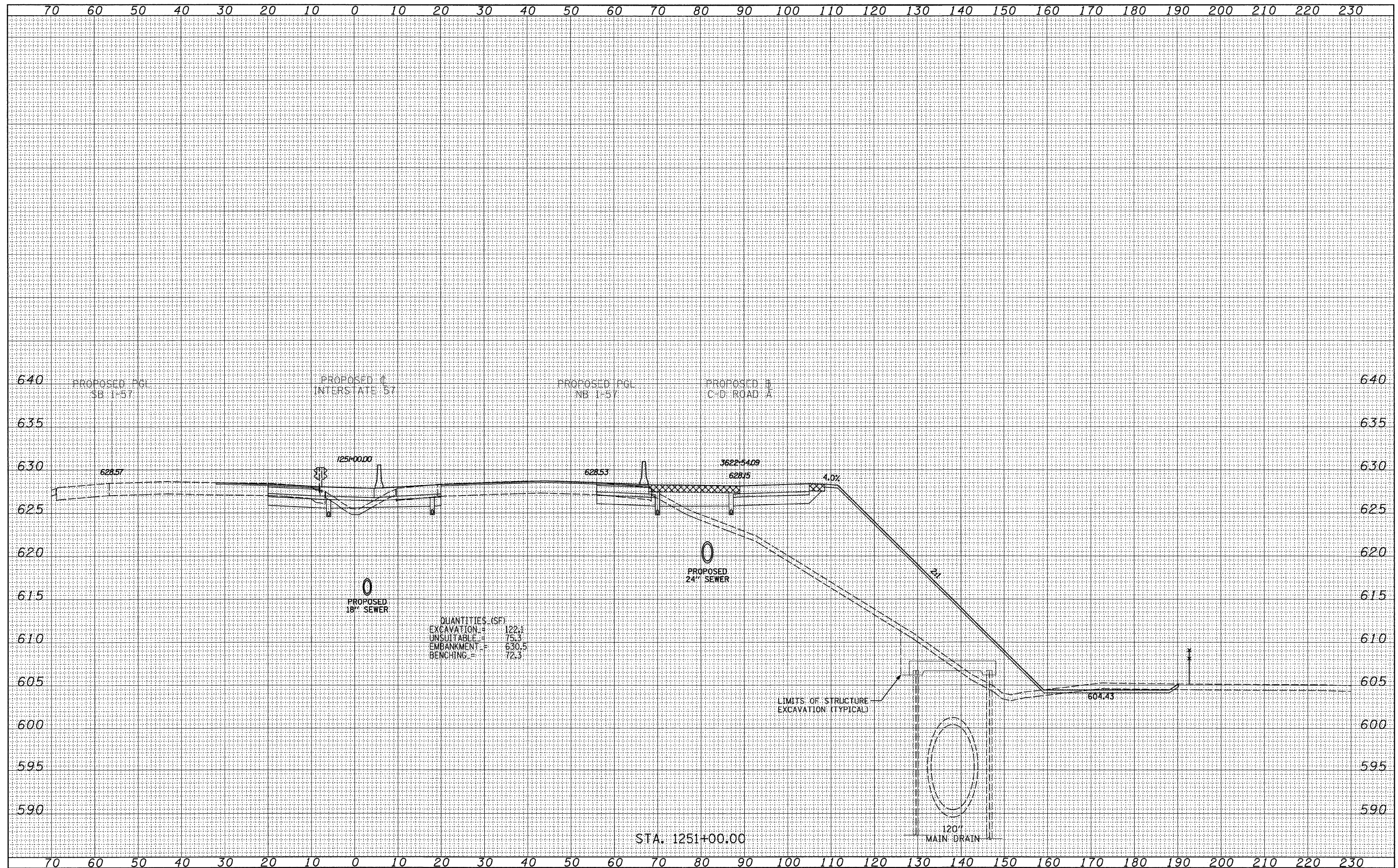

QUANTITIES (SF)

EXCAVATION	=	122.1
UNSUITABLE	=	75.3
EMBANKMENT	=	630.5
BENCHING	=	72.3

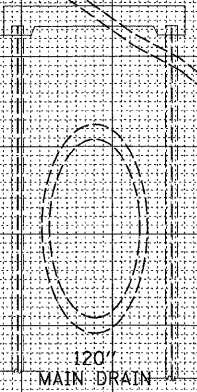

STA. 1251+00.00

TYLIN INTERNATIONAL	USER NAME =	DESIGNED - JDF	REVISED - 4/29/2010	STATE OF ILLINOIS DEPARTMENT OF TRANSPORTATION	I-57 AT I-294 INTERCHANGE PROJECT			F.A.I. RTE.	SECTION	COUNTY	TOTAL SHEETS	SHEET NO.
	PLOT SCALE =	DRAWN - JDF	REVISED -		57	1414.2B	COOK	516	493			
	PLOT DATE =	CHECKED - JPM	REVISED -		PROPOSED I-57 CROSS SECTIONS			CONTRACT NO. 60J27				
		DATE - 3/18/2010	REVISED -		SCALE: 1" = 10' H	SHEET NO. OF SHEETS	STA. 1251+00.00 TO STA. 1251+00.00	FED. ROAD DIST. NO.	ILLINOIS FED. AID PROJECT			