

DATE	
BY	
FINAL SURVEY	
NOTED	
AREAS CHECKED	
NO.	

DATE	
BY	
ORIGINAL SURVEY	
NOTED	
AREAS CHECKED	
NO.	

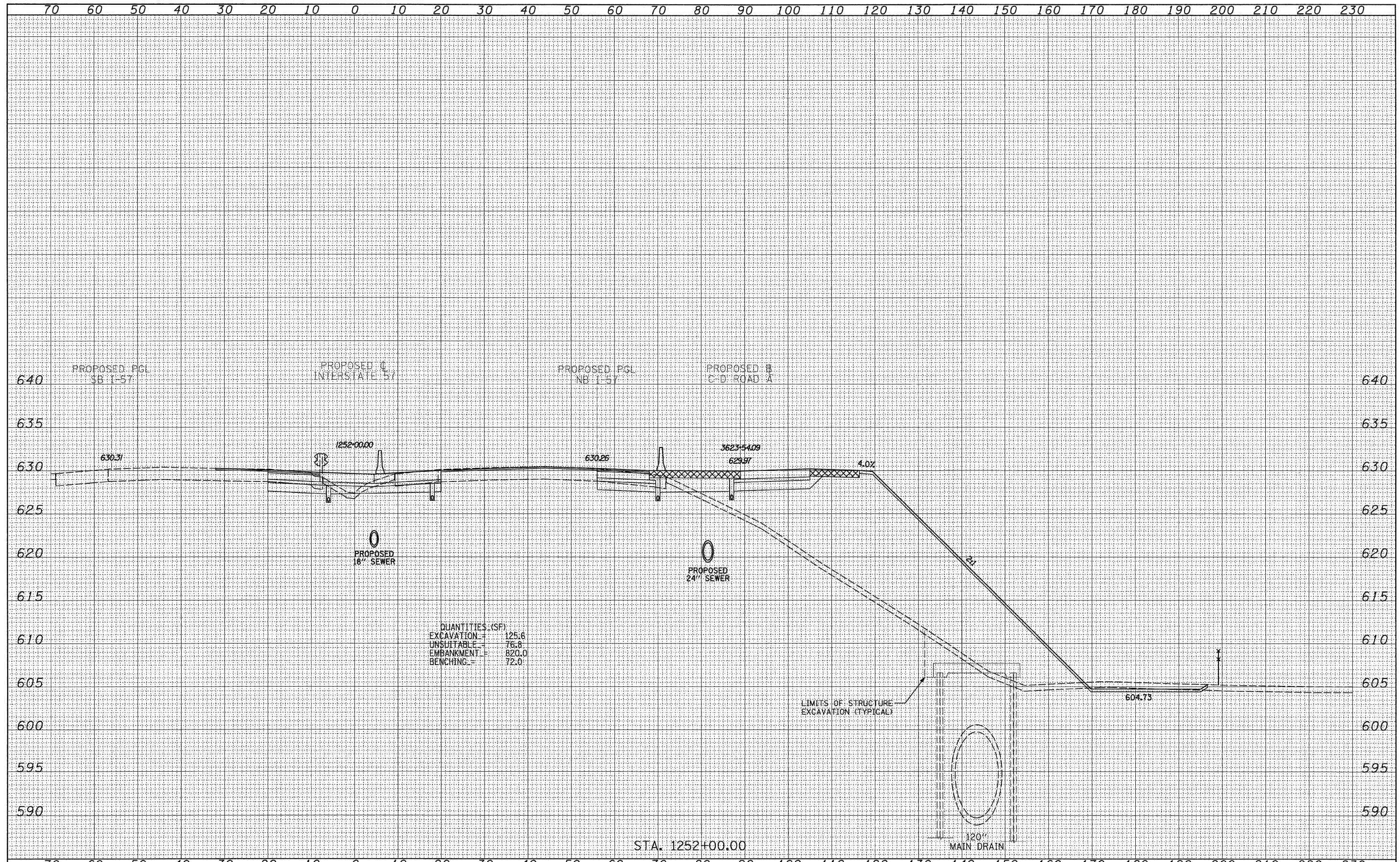

QUANTITIES (SF)

EXCAVATION	=	125.6
UNSUITABLE	=	76.8
EMBANKMENT	=	820.0
BENCHING	=	72.0

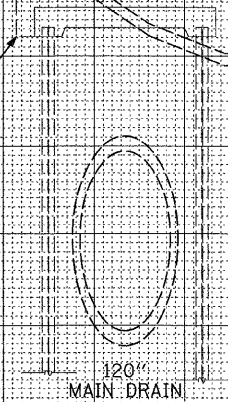

TYLIN INTERNATIONAL

USER NAME =	DESIGNED - JDF	REVISED - 4/29/2010
	DRAWN - JDF	REVISED -
PLOT SCALE =	CHECKED - JPM	REVISED -
PLOT DATE =	DATE - 3/18/2010	REVISED -

**STATE OF ILLINOIS
DEPARTMENT OF TRANSPORTATION**

**I-57 AT I-294 INTERCHANGE PROJECT
PROPOSED I-57 CROSS SECTIONS**

SCALE: $\frac{1"}{40'} = \frac{10'}{400'} = \frac{1"}{40'}$ SHEET NO. OF SHEETS STA. 1252+00.00 TO STA. 1252+00.00

F.A.I. RTE.	SECTION	COUNTY	TOTAL SHEETS	SHEET NO.
57	1414.2B	COOK	516	495
CONTRACT NO. 60J27				
FED. ROAD DIST. NO. ILLINOIS FED. AID PROJECT				

P:\602540(57-294)\Road\PI_157 BR\PI_157XS_SHT_R.dgn