

DATE	
BY	
FINAL SURVEY	
PLOTTED	
NOTE BOOK	
AREAS CHECKED	
NO.	

DATE	
BY	
ORIGINAL SURVEY	
PLOTTED	
NOTE BOOK	
AREAS CHECKED	
NO.	

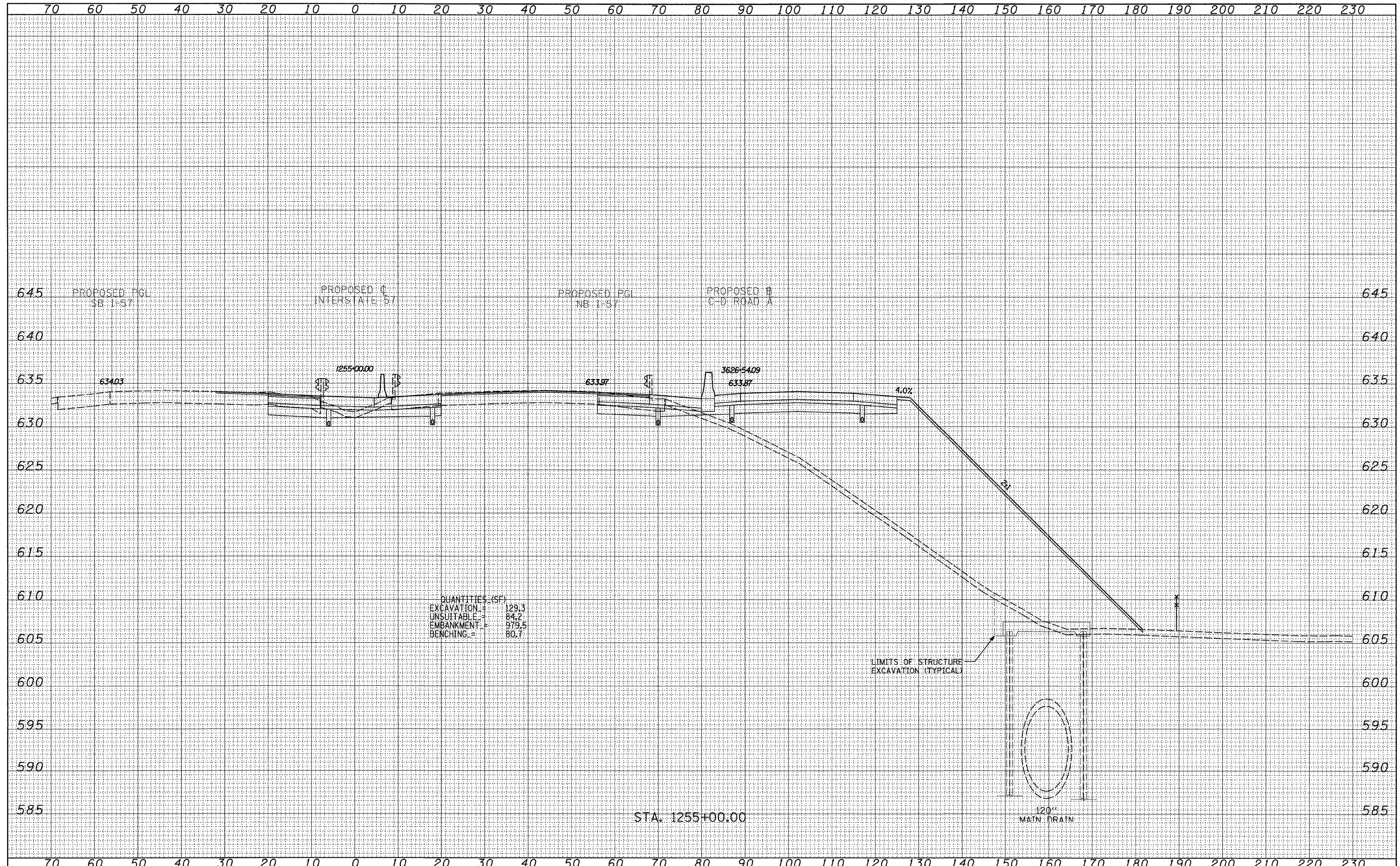

QUANTITIES (SF)  
 EXCAVATION = 129.3  
 UNSUITABLE = 84.2  
 EMBANKMENT = 979.5  
 BENCHING = 80.7

LIMITS OF STRUCTURE  
 EXCAVATION (TYPICAL)

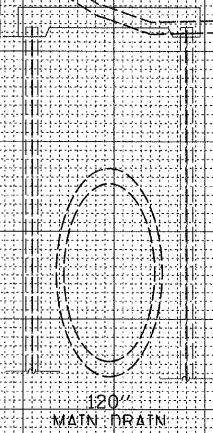

STA. 1255+00.00

<b>TYLIN INTERNATIONAL</b> USER NAME = PLOT SCALE = PLOT DATE =	DESIGNED - JDF	REVISED - 4/29/2010	<b>STATE OF ILLINOIS</b> <b>DEPARTMENT OF TRANSPORTATION</b>		<b>I-57 AT I-294 INTERCHANGE PROJECT</b> <b>PROPOSED I-57 CROSS SECTIONS</b>			F.A.I. RTE. 57	SECTION 1414.2B	COUNTY COOK	TOTAL SHEETS 516	SHEET NO. 501
	DRAWN - JDF	REVISED -						CONTRACT NO. 60J27				
	CHECKED - JPM	REVISED -						FED. ROAD DIST. NO. ILLINOIS FED. AID PROJECT				
	DATE - 3/18/2010	REVISED -						SCALE: 1" = 10' H				
			SHEET NO. OF SHEETS		STA. 1255+00.00 TO STA. 1255+00.00							