

DATE	
BY	
SURVEYED	
PLOTTED	
DATE	
AREAS CHECKED	
FINAL SURVEY	
NOTE BOOK	
NO.	

DATE	
BY	
SURVEYED	
PLOTTED	
DATE	
AREAS CHECKED	
ORIGINAL SURVEY	
NOTE BOOK	
NO.	

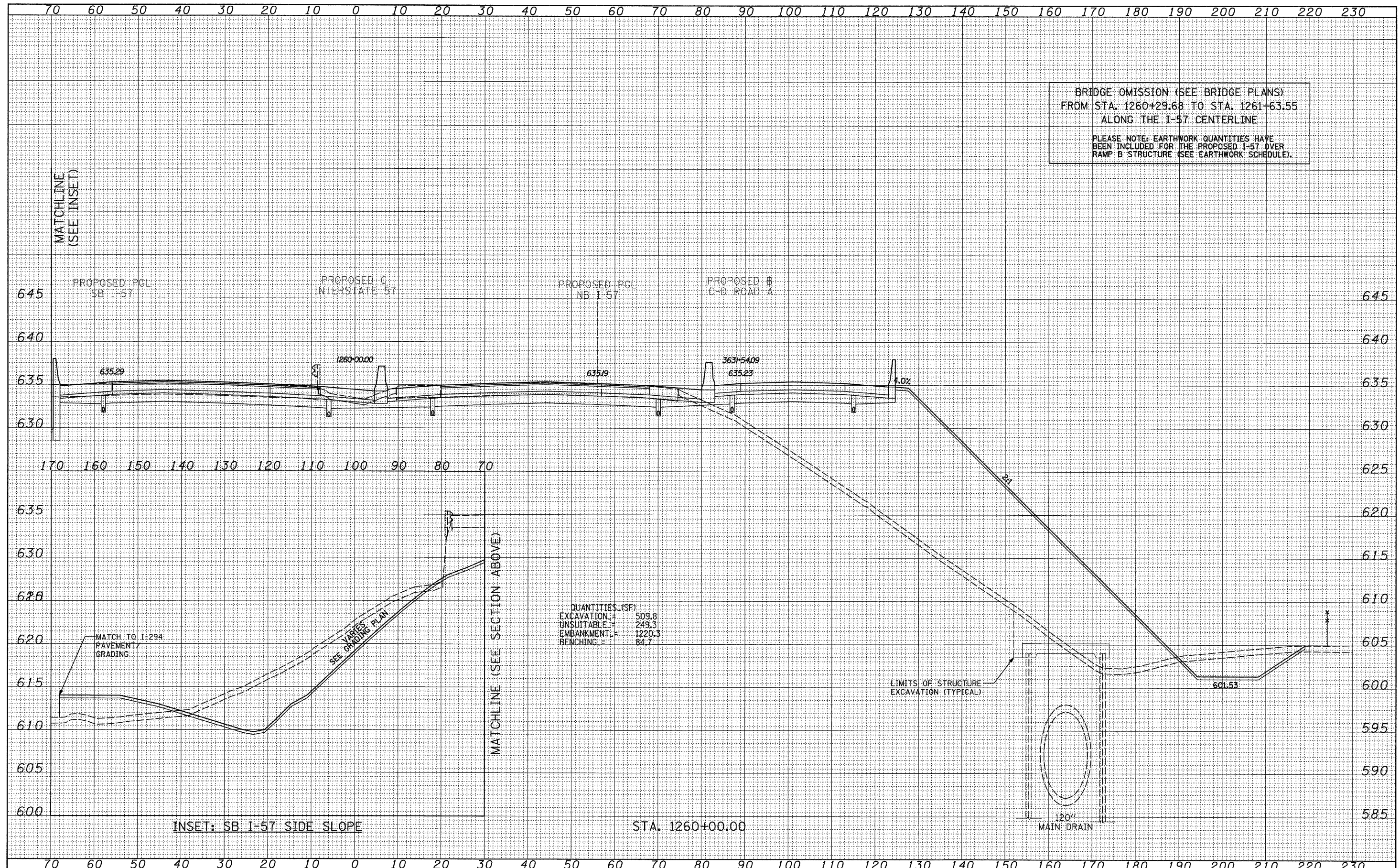

TYLIN INTERNATIONAL	USER NAME =	DESIGNED - JDF	REVISED - 4/29/2010	STATE OF ILLINOIS DEPARTMENT OF TRANSPORTATION	I-57 AT I-294 INTERCHANGE PROJECT		F.A.I. RTE. =	SECTION	COUNTY	TOTAL SHEETS	SHEET NO.
	PLOT SCALE =	DRAWN - JDF	REVISED -		57	1414.2B	COOK	516	504		
	PLOT DATE =	CHECKED - JPM	REVISED -		PROPOSED I-57 CROSS SECTIONS		CONTRACT NO. 60J27		FED. ROAD DIST. NO. ILLINOIS FED. AID PROJECT		
DATE - 3/18/2010				REVISED -	SCALE: 1" = 10' H	SHEET NO. OF SHEETS	STA. 1260+00.00 TO STA. 1260+00.00				

P:\602540(57-294)\Road\PI.157 BR\PI.57XS\_SHT\_R.dgn