

DATE	
BY	
FINAL SURVEY	
PLOTTED	
NOTE BOOK	
AREAS CHECKED	
NO.	

DATE	
BY	
ORIGINAL SURVEY	
PLOTTED	
NOTE BOOK	
AREAS CHECKED	
NO.	

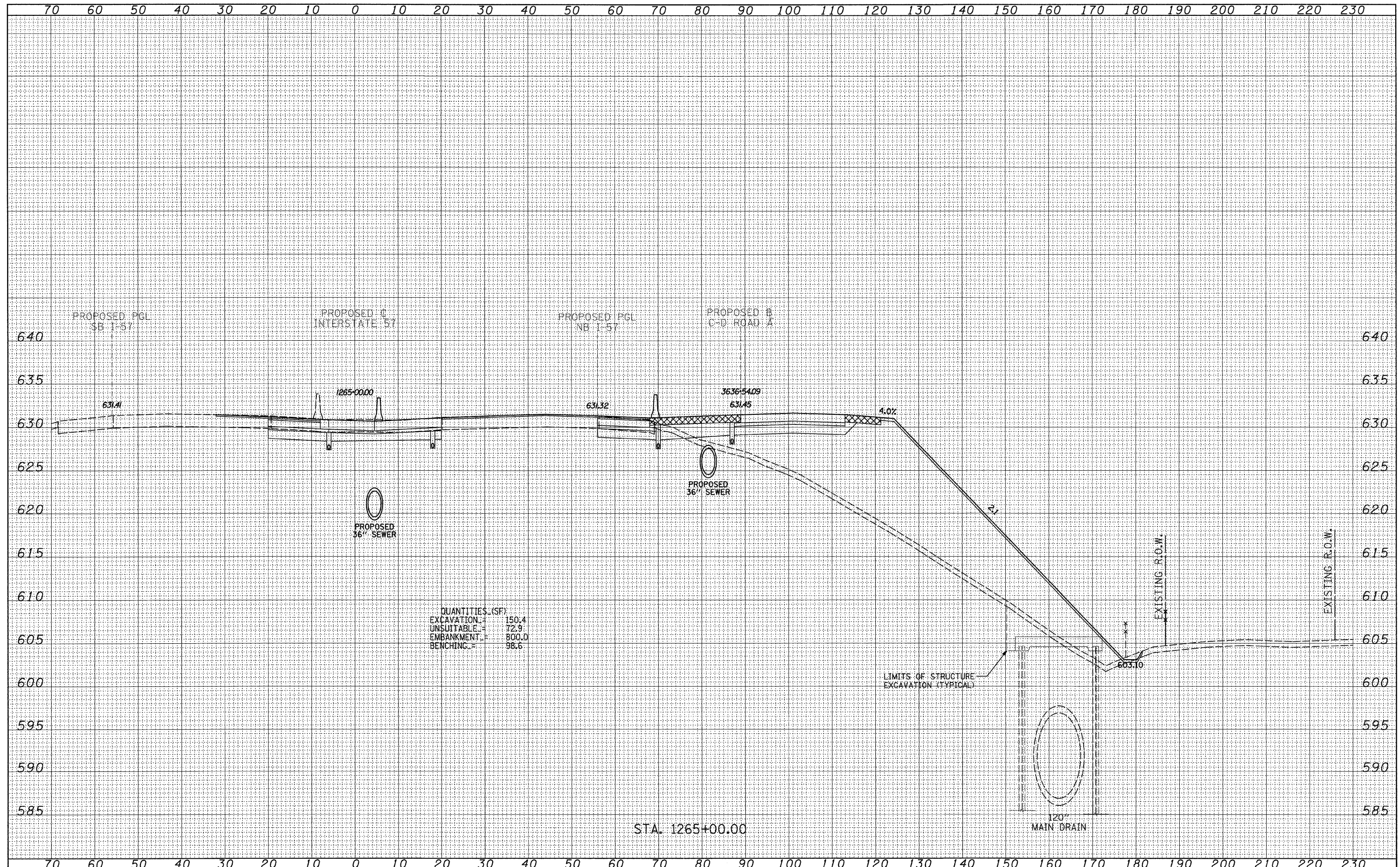

QUANTITIES (SF)

EXCAVATION	=	150.4
UNSUITABLE	=	72.9
EMBANKMENT	=	800.0
BENCHING	=	98.6

STA. 1265+00.00

120" MAIN DRAIN

LIMITS OF STRUCTURE EXCAVATION (TYPICAL)

EXISTING R.O.W.

EXISTING R.O.W.

TYLIN INTERNATIONAL

USER NAME =	DESIGNED - JDF	REVISED - 4/29/2010
PLLOT SCALE =	DRAWN - JDF	REVISED -
PLLOT DATE =	CHECKED - JPM	REVISED -
	DATE - 3/18/2010	REVISED -

STATE OF ILLINOIS  
DEPARTMENT OF TRANSPORTATION

I-57 AT I-294 INTERCHANGE PROJECT  
PROPOSED I-57 CROSS SECTIONS

SCALE: 1/4" = 10' H  
SHEET NO. OF SHEETS STA. 1265+00.00 TO STA. 1265+00.00

F.A.I. RTE.	SECTION	COUNTY	TOTAL SHEETS	SHEET NO.
57	1414.2B	COOK	516	511
FED. ROAD DIST. NO.			ILLINOIS FED. AID PROJECT	
			CONTRACT NO. 60J27	