

STATE OF ILLINOIS  
DEPARTMENT OF TRANSPORTATION

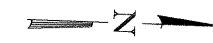

Stage I:  
Construction of east half of the new SPUI. This includes the widening and rehabilitation of the northbound lanes of the Central Ave. Bridge (main line) and removal and reconstruction of Ramps 3 and 4. Central Ave. will remain open with one lane of traffic maintained in each direction, using southbound lanes. Ramps 1 and 2 will also remain open, and a left turn lane will be maintained along northbound Central Ave. for access to westbound I-55 (Ramp 2).

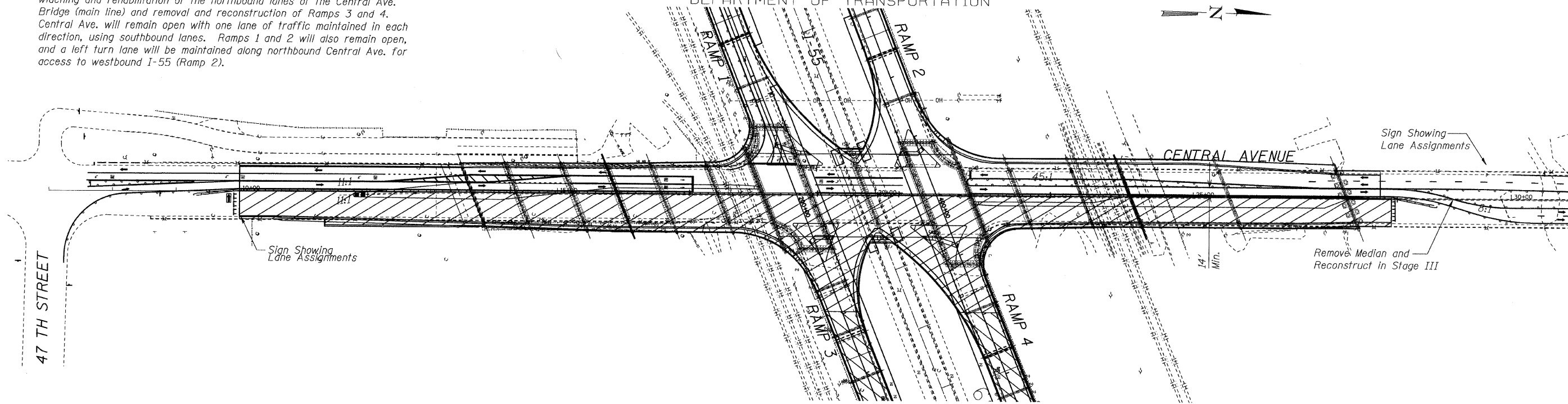

STAGE I

Stage II:  
Construction of west half of the new SPUI. This includes the rehabilitation of the southbound lanes of Central Ave. Bridge (main line) and removal and reconstruction of Ramps 1 and 2. Central Ave. will remain open with one lane of traffic maintained in each direction, using the newly reconstructed southbound lanes. Ramps 3 and 4 will be open to traffic at the beginning of this stage, with Ramps 1 and 2 being closed at that time. At no time will all four of the interchange ramps be closed simultaneously. A left turn lane will be maintained along Central Ave. for access to the eastbound ramp (Ramp 3).

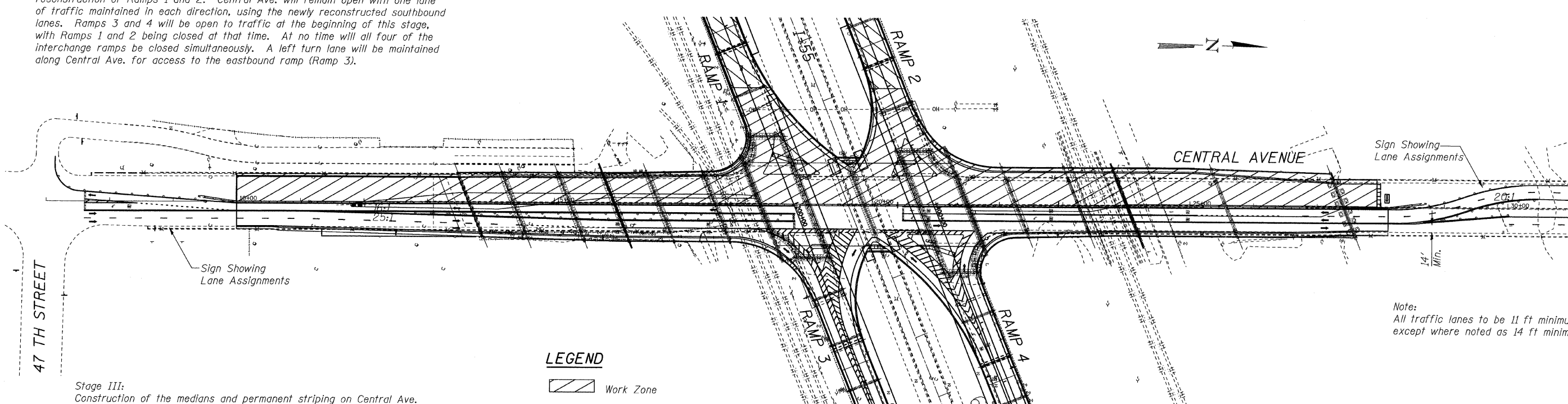

STAGE II

Note:  
All traffic lanes to be 11 ft minimum width except where noted as 14 ft minimum.

- LEGEND**
- Work Zone
  - Travel Lanes
  - Pavement Marking
  - Barricades

Stage III:  
Construction of the medians and permanent striping on Central Ave. within the geometric limits of the SPUI. The two center lanes along Central Ave. will be closed during this stage. Only one through lane in each direction will be available. Auxiliary left (one) lane and right turn lanes will be in place for Stage III operations; phasing will be adjusted on the reduced number of lanes available.

**OVERALL STAGE  
CONSTRUCTION**  
SN 016-0724, SN 016-3240  
& SN 016-3241

<b>TYLIN INTERNATIONAL</b>	DESIGNED - MI	REVISIONS		SHEET NO. 4	F.A.I. RTE. 55	SECTION 0711.2R & 1011.1BR	COUNTY COOK	TOTAL SHEETS 200	SHEET NO. 4
	CHECKED - AMD,TD	NAME	DATE						
	DRAWN - PL, CS								
	CHECKED - AMD, MI, TD								
	DATE - 08/02/10			4 SHEETS	CONTRACT NO. 60L39				
FED. ROAD DIST. NO. 1 ILLINOIS FED. AID PROJECT									

2:40:24 PM  
p:\01345\beam and bearing fabrication\155const1.dwg