

STATE OF ILLINOIS
DEPARTMENT OF TRANSPORTATION

GIRDER G3.12

LOCATION	STATION	OFFSET	THEORETICAL GRADE ELEVATIONS	THEORETICAL GRADE ELEVATIONS ADJUSTED FOR DEAD LOAD DEFLECTIONS
⊕ G1	201+08.55	-79.87	628.56	628.57
F	201+16.84	-71.19	628.16	628.18
G	201+26.84	-62.16	627.73	627.76
H	201+36.84	-54.40	627.33	627.36
I	201+46.84	-47.71	626.97	626.99
⊕ R3 Pier	201+61.17	-39.79	626.49	626.50
J	201+71.17	-35.14	626.19	626.20
K	201+81.17	-31.29	625.88	625.90
L	201+91.17	-28.12	625.58	625.60
M	202+01.17	-25.59	625.27	625.30
N	202+11.17	-23.67	624.98	625.00
O	202+21.17	-22.35	624.68	624.69
P	202+31.17	-21.61	624.37	624.38
⊕ W. Brg.	202+38.62	-21.50	624.15	624.15
R3 Abut.				
⊕ Joint R3 Abut.	202+39.37	-21.50	624.13	624.13
Back of R3 Abut.	202+41.62	-21.50	624.06	624.06

P.G.L. RAMP 3 FLARE

LOCATION	STATION	OFFSET	THEORETICAL GRADE ELEVATIONS	THEORETICAL GRADE ELEVATIONS ADJUSTED FOR DEAD LOAD DEFLECTIONS
⊕ G1	200+76.84	0.00	627.65	627.67
C	200+86.84	0.00	627.44	627.48
D	200+96.84	0.00	627.23	627.29
E	201+06.84	0.00	627.02	627.09
F	201+16.84	0.00	626.81	626.88
G	201+26.84	0.00	626.60	626.66
H	201+36.84	0.00	626.40	626.44
I	201+46.84	0.00	626.19	626.22
⊕ R3 Pier	201+61.17	0.00	625.89	625.90
J	201+71.17	0.00	625.66	625.67
K	201+81.17	0.00	625.41	625.43
L	201+91.17	0.00	625.16	625.20
M	202+01.17	0.00	624.89	624.93
N	202+11.17	0.00	624.62	624.66
O	202+21.17	0.00	624.34	624.37
P	202+31.17	0.00	624.05	624.06
⊕ W. Brg.	202+38.62	0.00	623.83	623.83
R3 Abut.				
⊕ Joint R3 Abut.	202+39.37	0.00	623.81	623.81
Back of R3 Abut.	202+41.62	0.00	623.74	623.74

GIRDER G3.11

LOCATION	STATION	OFFSET	THEORETICAL GRADE ELEVATIONS	THEORETICAL GRADE ELEVATIONS ADJUSTED FOR DEAD LOAD DEFLECTIONS
⊕ N. Brg.	200+70.38	47.75	626.66	626.66
C. Abut 1				
B	200+76.84	44.50	626.60	626.62
C	200+86.84	39.48	626.55	626.60
D	200+96.84	34.45	626.49	626.57
⊕ G3.9	201+04.59	30.50	626.57	626.67

GIRDER G3.15

LOCATION	STATION	OFFSET	THEORETICAL GRADE ELEVATIONS	THEORETICAL GRADE ELEVATIONS ADJUSTED FOR DEAD LOAD DEFLECTIONS
⊕ G1	201+00.86	-60.50	628.39	628.40
E	201+06.84	-60.50	628.22	628.23
F	201+16.84	-60.50	627.96	627.98
G	201+26.84	-60.50	627.70	627.73
⊕ G3.12	201+28.34	-60.50	627.66	627.69

GIRDER G3.18

LOCATION	STATION	OFFSET	THEORETICAL GRADE ELEVATIONS	THEORETICAL GRADE ELEVATIONS ADJUSTED FOR DEAD LOAD DEFLECTIONS
⊕ G1	200+93.12	-41.00	628.19	628.20
D	200+96.84	-41.00	628.09	628.10
E	201+06.84	-41.00	627.84	627.87
F	201+16.84	-41.00	627.59	627.63
G	201+26.84	-41.00	627.35	627.40
H	201+36.84	-41.00	627.10	627.14
I	201+46.84	-41.00	626.86	626.89
⊕ FB - 3.5	201+53.17	-41.00	626.71	626.73

GIRDER G3.13

LOCATION	STATION	OFFSET	THEORETICAL GRADE ELEVATIONS	THEORETICAL GRADE ELEVATIONS ADJUSTED FOR DEAD LOAD DEFLECTIONS
⊕ G1	201+06.02	-73.50	628.50	628.51
E	201+06.84	-73.50	628.46	628.47
⊕ G3.12	201+14.48	-73.50	628.09	628.10

GIRDER G3.16

LOCATION	STATION	OFFSET	THEORETICAL GRADE ELEVATIONS	THEORETICAL GRADE ELEVATIONS ADJUSTED FOR DEAD LOAD DEFLECTIONS
⊕ G1	200+98.28	-54.00	628.33	628.34
E	201+06.84	-54.00	628.10	628.12
F	201+16.84	-54.00	627.84	627.87
G	201+26.84	-54.00	627.58	627.61
H	201+36.84	-54.00	627.33	627.36
⊕ G3.12	201+37.38	-54.00	627.32	627.35

GIRDER G3.19

LOCATION	STATION	OFFSET	THEORETICAL GRADE ELEVATIONS	THEORETICAL GRADE ELEVATIONS ADJUSTED FOR DEAD LOAD DEFLECTIONS
⊕ G1	200+90.54	-34.50	628.11	628.11
D	200+96.84	-34.50	627.95	627.97
E	201+06.84	-34.50	627.71	627.75
F	201+16.84	-34.50	627.47	627.52
G	201+26.84	-34.50	627.23	627.29
H	201+36.84	-34.50	626.99	627.04
I	201+46.84	-34.50	626.75	626.79
⊕ R3 Pier	201+61.17	-34.50	626.41	626.42

GIRDER G3.14

LOCATION	STATION	OFFSET	THEORETICAL GRADE ELEVATIONS	THEORETICAL GRADE ELEVATIONS ADJUSTED FOR DEAD LOAD DEFLECTIONS
⊕ G1	201+03.44	-67.00	628.45	628.46
E	201+06.84	-67.00	628.34	628.35
F	201+16.84	-67.00	628.08	628.10
⊕ G3.12	201+21.23	-67.00	627.97	627.99

GIRDER G3.17

LOCATION	STATION	OFFSET	THEORETICAL GRADE ELEVATIONS	THEORETICAL GRADE ELEVATIONS ADJUSTED FOR DEAD LOAD DEFLECTIONS
⊕ G1	200+95.70	-47.50	628.26	628.27
D	200+96.84	-47.50	628.22	628.23
E	201+06.84	-47.50	627.97	628.00
F	201+16.84	-47.50	627.72	627.75
G	201+26.84	-47.50	627.47	627.51
H	201+36.84	-47.50	627.21	627.24
⊕ FB - 3.6	201+42.59	-47.50	627.06	627.09

GIRDER G3.20

LOCATION	STATION	OFFSET	THEORETICAL GRADE ELEVATIONS	THEORETICAL GRADE ELEVATIONS ADJUSTED FOR DEAD LOAD DEFLECTIONS
⊕ G1	200+87.96	-28.00	628.03	628.03
D	200+96.84	-28.00	627.81	627.82
E	201+06.84	-28.00	627.58	627.60
F	201+16.84	-28.00	627.34	627.37
G	201+26.84	-28.00	627.11	627.14
H	201+36.84	-28.00	626.88	626.90
I	201+46.84	-28.00	626.64	626.66
⊕ Pier N2	201+61.17	-28.00	626.31	626.31
J	201+71.17	-28.00	626.08	626.08
K	201+81.17	-28.00	625.83	625.84
⊕ FB - 3.4	201+81.62	-28.00	625.82	626.00

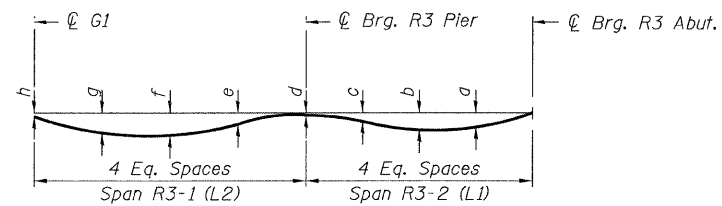

DEAD LOAD DEFLECTION DIAGRAM

(Includes weight of concrete only.)

Note:

The above deflections are not to be used in the field if the engineer is working from the grade elevations adjusted for dead load deflections as shown above.

Girder	a	b	c	d	e	f	g	h	L1	L2
G3.1*	-	3/8"	1/8"	0	1/4"	3/8"	1/4"	0	75'-9 7/8"	75'-9 7/8"
G3.2	5/8"	3/4"	3/8"	0	1/8"	3/8"	1/4"	1/8"	77'-5 3/8"	78'-4 3/4"
G3.3	1/2"	5/8"	1/4"	0	3/8"	5/8"	1/2"	1/8"	77'-5 3/8"	80'-11 3/4"
G3.4	5/8"	1/2"	1/4"	1/8"	1/2"	3/8"	3/4"	1/4"	77'-5 3/8"	83'-6 3/4"
G3.5	3/8"	1/2"	1/4"	1/8"	5/8"	1"	7/8"	1/8"	77'-5 3/8"	86'-1 3/4"
G3.6	3/8"	3/8"	1/4"	0	5/8"	1 1/4"	1 1/8"	3/8"	77'-5 3/8"	88'-8 5/8"
G3.7	3/8"	3/8"	1/4"	0	3/4"	1 3/8"	1 1/8"	3/8"	77'-5 3/8"	91'-3 5/8"
G3.8	3/8"	3/8"	1/4"	0	3/4"	1 3/8"	1 1/4"	3/8"	77'-5 3/8"	93'-10 5/8"
G3.9	-	-	-	0	1/8"	1 1/4"	1"	1/4"	-	96'-5 5/8"
G3.10	-	-	-	1/8"	-	1/2"	-	1/8"	-	29'-6 3/8"
G3.10A	-	-	-	3/8"	-	1/4"	-	1/8"	-	19'-2 1/4"
G3.11	-	-	-	1 1/4"	1"	5/8"	3/8"	0	-	38'-3 3/8"
G3.12	1/4"	1/4"	1/4"	1/8"	1/4"	3/8"	1/4"	1/8"	80'-3 1/4"	146'-10 1/4"
G3.13	-	-	-	1/8"	-	1/8"	-	1/8"	-	8'-5 3/4"
G3.14	-	-	-	1/4"	-	1/4"	-	1/8"	-	17'-10 1/8"
G3.15	-	-	-	3/8"	-	1/4"	-	1/8"	-	27'-11 1/8"
G3.16	-	-	-	3/8"	3/8"	3/8"	3/8"	1/8"	-	39'-1 1/2"
G3.17	-	-	-	3/8"	1/2"	1/2"	3/8"	1/8"	-	46'-11"
G3.18	-	-	-	1/4"	1/2"	5/8"	3/8"	1/8"	-	60'-1"
G3.19	-	-	-	1/8"	5/8"	3/4"	1/2"	0	-	70'-7 1/8"
G3.20	-	-	-	0	1/4"	3/8"	1/4"	0	-	73'-2 7/8"

* For G3.1 only, b is end of girder and c is midspan

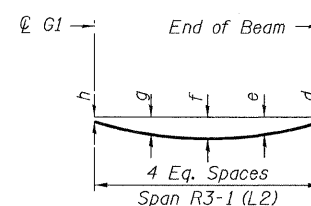

DEAD LOAD DEFLECTION DIAGRAM

(Includes weight of concrete only.)

TOP OF SLAB ELEV. - 2

RAMP 3 FLARE

STRUCTURE NO. 016-0724

TYLIN INTERNATIONAL	DESIGNED - JPM, EKH	REVISIONS		SHEET NO. 26	F.A.I RTE.	SECTION	COUNTY	TOTAL SHEETS	SHEET NO.							
	CHECKED - AMD,	NAME	DATE							137 SHEETS	55	0711.2R & 1011.1BR	COOK	200	56	
	DRAWN - JPM, EKH															CONTRACT NO. 60L39
	CHECKED - AMD,															
DATE - 08/02/10			FED. ROAD DIST. NO. 1	ILLINOIS	FED. AID PROJECT											

8/2/2010 2:23:00 PM p:\01345\beam_and_bearing_fabrication\155f3\tsedata2.dgn