

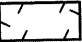

| | | |
|------|--------------------|------|
| PLAN | SURVEYED | DATE |
| | PLOTTED | |
| | CHECKED | |
| | BY | |
| | NO. OF WAY CHECKED | |
| | CADD FILE NAME | |
| | NO. | |

| | | |
|---------|--------------------|------|
| PROFILE | SURVEYED | DATE |
| | PLOTTED | |
| | CHECKED | |
| | BY | |
| | NO. OF WAY CHECKED | |
| | CADD FILE NAME | |
| | NO. | |

- LEGEND**
-  REMOVAL ITEM
 -  HOT-MIX ASPHALT SURFACE REMOVAL, 1 1/2"
 -  HOT-MIX ASPHALT SURFACE COURSE, MIX "D", N50, 1 1/2"

- NOTE:**
1. ALL PROPOSED ENTRANCES TO BE REPLACED IN KIND. AGGREGATE ENTRANCES TO BE REPLACED WITH HOT-MIX ASPHALT.
 2. ALL EXISTING TREES TO REMAIN SHALL BE PROTECTED. THIS WORK SHALL BE PAID FOR AS TEMPORARY FENCE.

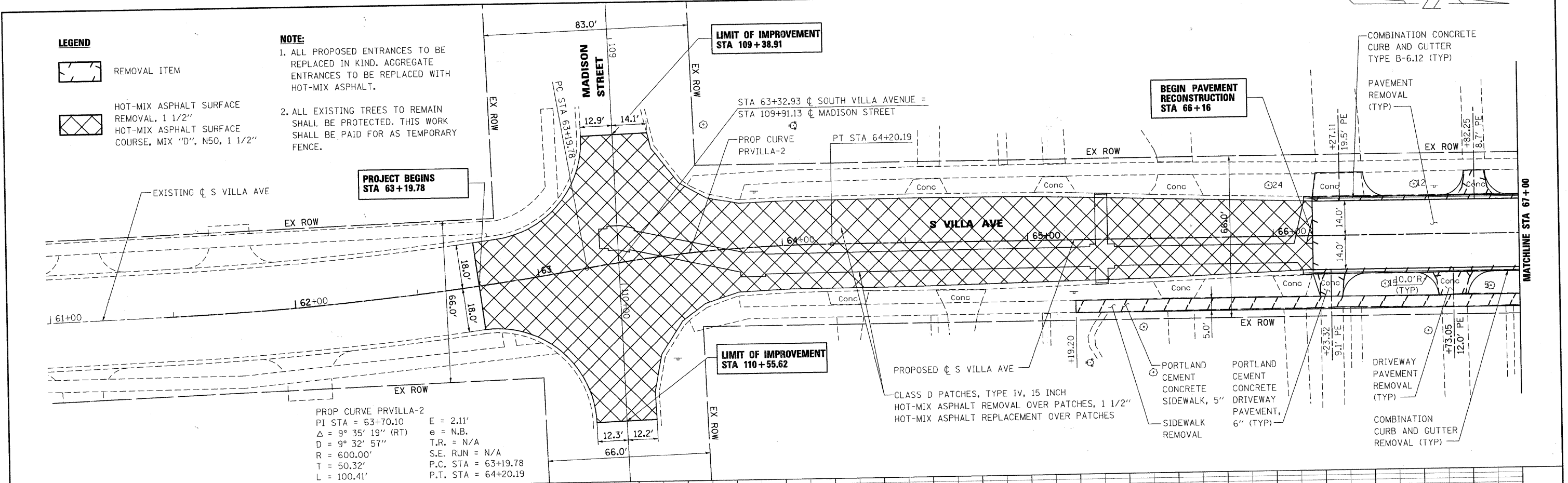

PROP CURVE PRVILLA-2
 PI STA = 63+70.10 E = 2.11'
 Δ = 9° 35' 19" (RT) e = N.B.
 D = 9° 32' 57" T.R. = N/A
 R = 600.00' S.E. RUN = N/A
 T = 50.32' P.C. STA = 63+19.78
 L = 100.41' P.T. STA = 64+20.19

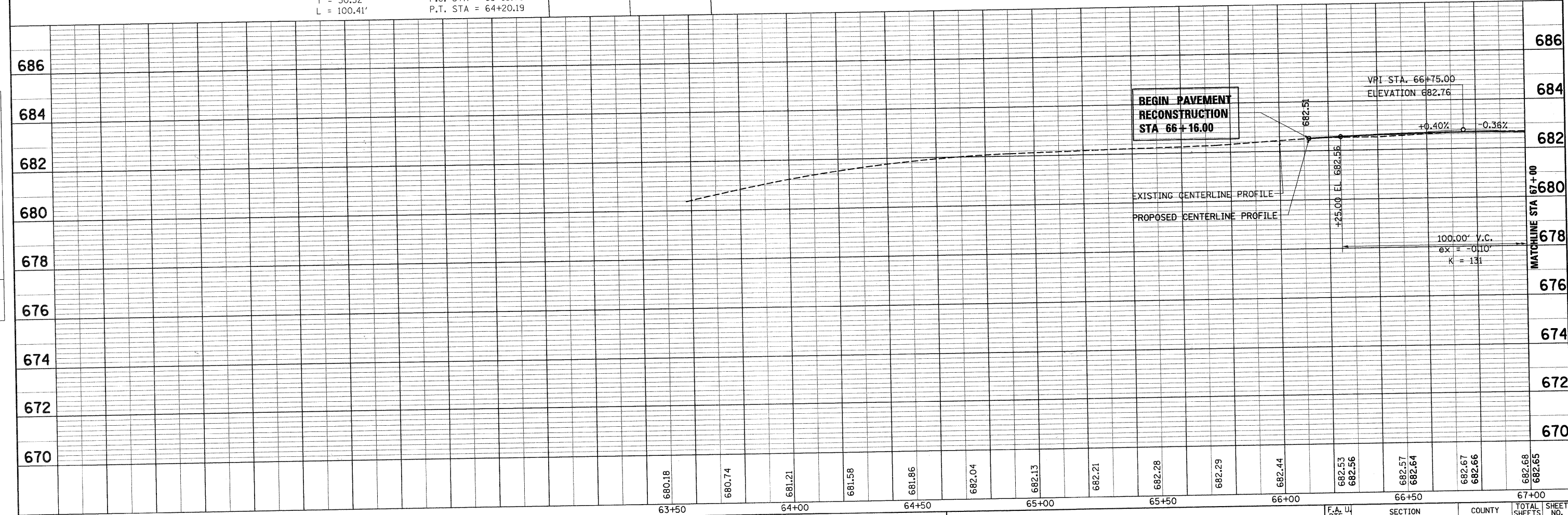

| | | | | | | | | | | | | |
|-----------------------------|--------------------|------------------|-----------|--|---------------------------|-------------|--------------|-------------------|------------------------|--------------------|------------------|--------------|
| FILE NAME = 018_650pp01.dgn | USER NAME = #USER# | DESIGNED - J.G. | REVISED - | VILLAGE OF VILLA PARK, ILLINOIS | PLAN AND PROFILE | | | F.A. U. RTE. 2652 | SECTION 00-00070-00-PV | COUNTY DuPAGE | TOTAL SHEETS 160 | SHEET NO. 18 |
| PLOT SCALE = 1:20 | DRAWN - E.D. | CHECKED - | REVISED - | | SCALE: 1"=20' | SHEET NO. 1 | OF 11 SHEETS | STA. 63+19.78 | TO STA. 116+71.35 | CONTRACT NO. 63379 | | |
| PLOT DATE = 6/15/2010 | DATE - 9/23/2009 | CHECKED - | REVISED - | | ILLINOIS FED. AID PROJECT | | | | | | | |
| | | DATE - 9/23/2009 | REVISED - | | | | | | | | | |