

**PRE-STAGE**

STA 102+69.19 TO STA 104+37.95  
 STA 104+69.37 TO STA 109+34.85

**STAGING:**

1. INSTALL TEMPORARY TRAFFIC CONTROL DEVICES AND SIGNING.
2. MAINTAIN EXISTING LANE CONFIGURATION AND WIDTHS.
3. TRAFFIC CONTROL AND PROTECTION SHALL BE IN ACCORDANCE WITH IDOT STANDARD 701501. ONLY DAYTIME CLOSURES SHALL BE PERMITTED.

**CONSTRUCTION:**

1. CONSTRUCT TEMPORARY PAVEMENT WIDENING.
2. INSTALL EROSION CONTROL MEASURES.

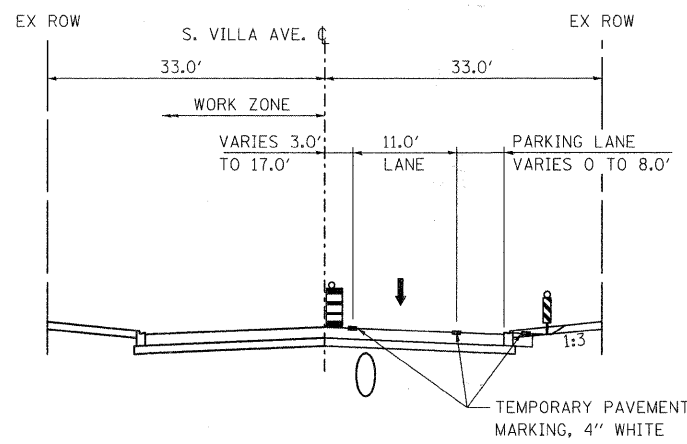

**STAGE 2**

**STAGING:**

1. INSTALL TEMPORARY TRAFFIC CONTROL DEVICES AND SIGNING.
2. MAINTAIN ONE-WAY DETOUR. REROUTE NORTHBOUND TRAFFIC AS SHOWN ON THE PLANS.
3. SHIFT SOUTHBOUND TRAFFIC TO THE EAST. MAINTAIN ONE LANE OF SOUTHBOUND TRAFFIC UTILIZING THE PROPOSED AND TEMPORARY PAVEMENT CONSTRUCTED DURING STAGE I.

**CONSTRUCTION:**

1. INSTALL EROSION CONTROL MEASURES.
2. PROVIDE REMOVAL OPERATIONS AND CONSTRUCT PROPOSED UTILITIES, ROADWAY PAVEMENT (EXCLUDING SURFACE COURSE), DRIVEWAYS AND SIDEWALK IN THE WORK ZONE.
3. CONSTRUCT STORM SEWER LATERALS IN THE WORKZONE.
4. RECONSTRUCT SANITARY SEWER AND MANHOLES. LINE SANITARY SEWER.

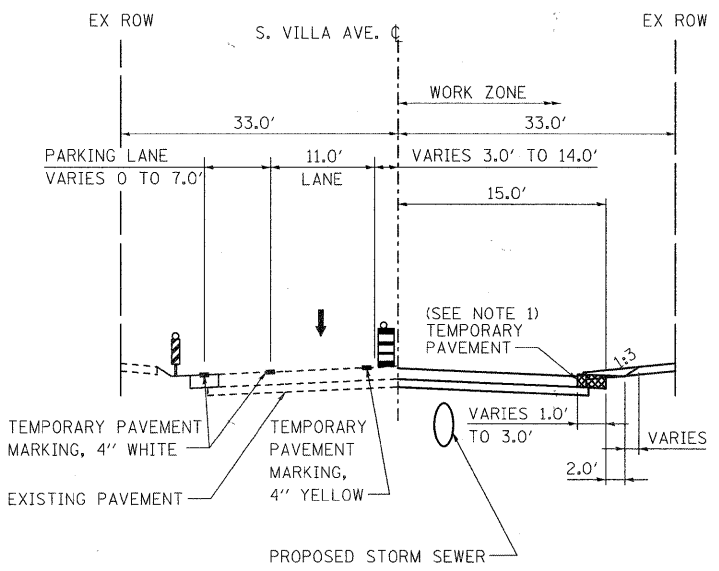

**STAGE 1**

**STAGING:**

1. INSTALL TEMPORARY TRAFFIC CONTROL DEVICES AND SIGNING.
2. INSTALL ONE-WAY DETOUR. REROUTE NORTHBOUND TRAFFIC AS SHOWN ON THE PLANS.
3. SHIFT SOUTHBOUND TRAFFIC TO THE WEST. MAINTAIN ONE LANE OF SOUTHBOUND TRAFFIC UTILIZING THE EXISTING AND TEMPORARY PAVEMENT CONSTRUCTED DURING PRE-STAGE.

**CONSTRUCTION:**

1. INSTALL EROSION CONTROL MEASURES.
2. PROVIDE REMOVAL OPERATIONS AND CONSTRUCT PROPOSED UTILITIES, ROADWAY PAVEMENT (EXCLUDING SURFACE COURSE), DRIVEWAYS AND SIDEWALK IN THE WORK ZONE.
3. CONSTRUCT TEMPORARY PAVEMENT WIDENING AT THE LOCATIONS SHOWN ON THE PLANS.
4. CONSTRUCT MAINLINE STORM SEWERS AND LATERALS IN THE WORK ZONE.

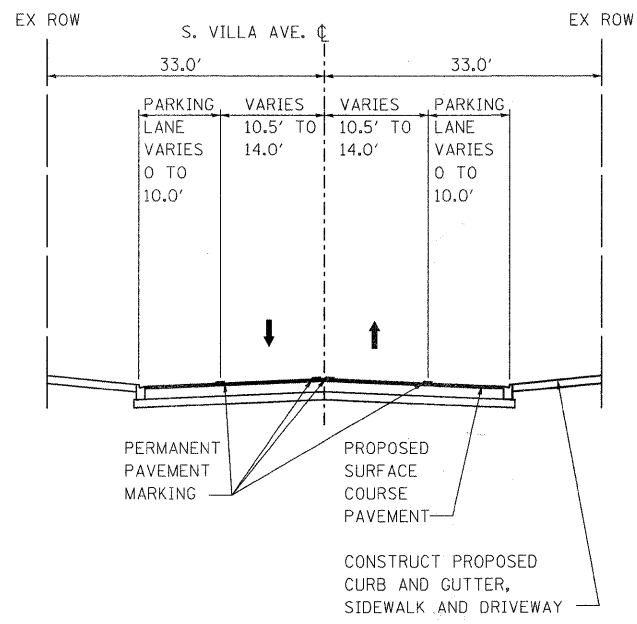

**STAGE 3**

**STAGING:**

1. INSTALL TEMPORARY TRAFFIC CONTROL DEVICES AND SIGNING.
2. REMOVE DETOUR.
3. SHIFT TRAFFIC TO PROPOSED LANE CONFIGURATION AND WIDTHS.
4. TRAFFIC CONTROL AND PROTECTION SHALL BE IN ACCORDANCE WITH IDOT STANDARD 701501. ONLY DAYTIME CLOSURES SHALL BE PERMITTED.

**CONSTRUCTION:**

1. PROVIDE REMOVAL OPERATIONS AND CONSTRUCT PROPOSED CURB AND GUTTER, DRIVEWAYS AND SIDEWALK IN THE WORK ZONE.
2. MILL EXISTING PAVEMENT ALONG VILLA AVE AND WASHINGTON ST TO THE LIMITS SHOWN ON THE PLANS.
3. CONSTRUCT SURFACE COURSE PAVEMENT.
4. INSTALL PERMANENT PAVEMENT MARKINGS.
5. INSTALL EROSION CONTROL AND LANDSCAPING MEASURES.

**NOTES:**

1. TEMPORARY PAVEMENT SHALL CONSIST OF HMA BINDER COURSE, IL-19.0, N50, 6"



FILE NAME =	USER NAME = #USER#	DESIGNED - J.G.	REVISED -
030_650mot_ts.dgn		DRAWN - E.D.	REVISED -
		CHECKED -	REVISED -
		DATE - 9/23/2009	REVISED -

**VILLAGE OF VILLA PARK, ILLINOIS**

**SUGGESTED MAINTENANCE OF TRAFFIC TYPICAL SECTIONS**

SCALE: 1"=20' SHEET NO. 2 OF 14 SHEETS STA. 63+19.78 TO STA. 116+71.35

F.A. U. RTE.	SECTION	COUNTY	TOTAL SHEETS	SHEET NO.
2652	00-00070-00-PV	DuPAGE	160	30
CONTRACT NO. 63379				
FED. ROAD DIST. NO. ILLINOIS FED. AID PROJECT				