

FINAL SURVEY	SURVEYED	BY	DATE
NOTE BOOK	PLOTTED		
NO.	TEMPLATE		
	AREAS CHECKED		
	AREAS CHECKED		

ORIGINAL SURVEY	SURVEYED	BY	DATE
NOTE BOOK	PLOTTED		
NO.	TEMPLATE		
	AREAS CHECKED		
	AREAS CHECKED		

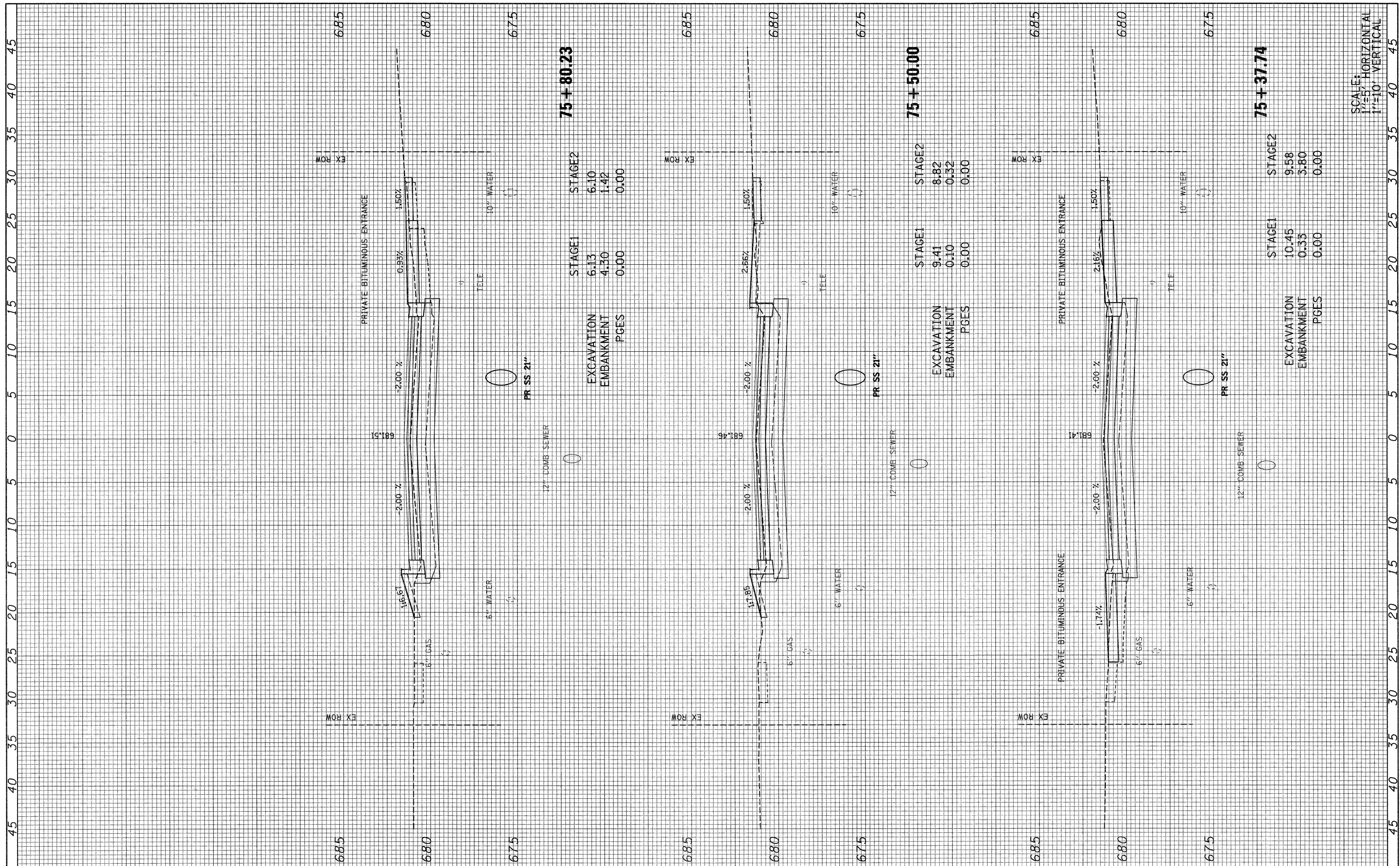

**75 + 80.23**

STAGE1	6.13
EXCAVATION	4.30
EMBANKMENT	0.00
PGES	0.00
STAGE2	6.10
EXCAVATION	1.42
EMBANKMENT	0.00
PGES	0.00

**75 + 50.00**

STAGE1	9.41
EXCAVATION	0.10
EMBANKMENT	0.00
PGES	0.00
STAGE2	8.82
EXCAVATION	0.32
EMBANKMENT	0.00
PGES	0.00

**75 + 37.74**

STAGE1	10.45
EXCAVATION	0.33
EMBANKMENT	0.00
PGES	0.00
STAGE2	9.58
EXCAVATION	3.80
EMBANKMENT	0.00
PGES	0.00

SCALE:  
1"=5' HORIZONTAL  
1"=10' VERTICAL

FILE NAME = 092-160.villa_xs.dgn	USER NAME = #USER#	DESIGNED -	REVISOR -	<b>STATE OF ILLINOIS</b> <b>DEPARTMENT OF TRANSPORTATION</b>	<b>S. VILLA AVE - CROSS SECTION</b>	F.A. RTE. 2652	SECTION 00-0070-00-PV	COUNTY DuPAGE	TOTAL SHEETS 160	SHEET NO. 109		
PLOT SCALE = 1:45	PLOT DATE = 6/15/2010	DRAWN -	REVISOR -			SCALE: AS NOTED	SHEET NO. 18 OF 69 SHEETS	STA. 75+37.74	TO STA. 75+80.23	ILLINOIS FED. AID PROJECT		
		CHECKED -	REVISOR -			CONTRACT NO. 63379						
		DATE -	REVISOR -									